

* VERTICAL GRANITE CURB ITEM 556-B			CONSTRUCT SPEED CHANGE LANE (incl taper)			PROPERTY LINE FENCE WITH STEEL POSTS ITEM 593-II WOOD		
STATION	STATION	POS	STATION	STATION	POS	STATION	STATION	POS
WB 1000+00	1000+25	27	WB 1000+00	1003+30	27	WB 1000+00	1003+30	27

* GRANITE SLOPE EDGING ITEM 556-A			CONSTRUCT RAMP		
STATION	STATION	POS	STATION	STATION	RAMP
WB 1000+00	1000+25	27	WB 1000+00	1003+30	A
WB 1000+00	1000+25	27	WB 1000+00	1003+30	B

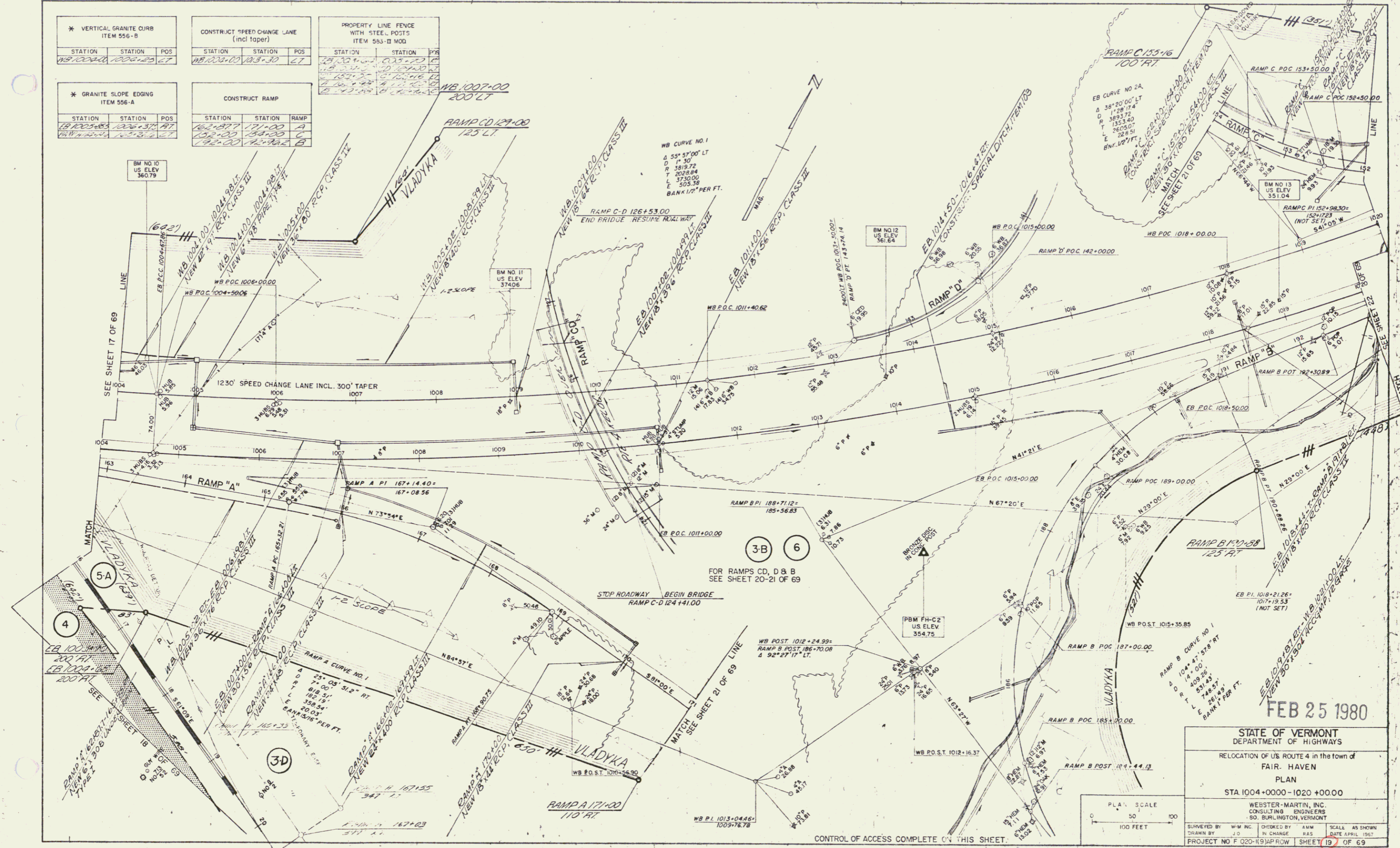

3-B 6
FOR RAMP C, D & B
SEE SHEET 20-21 OF 69

FEB 25 1980

STATE OF VERMONT
DEPARTMENT OF HIGHWAYS
RELOCATION OF US ROUTE 4 in the town of
FAIR, HAVEN
PLAN
STA 1004+0000 - 1020+0000

WEBSTER-MARTIN, INC.
CONSULTING ENGINEERS
50, BURLINGTON, VERMONT

SURVEYED BY: W.M. INC. CHECKED BY: R.A.S. SCALE: AS SHOWN
DRAWN BY: J.O. IN CHARGE: R.A.S. DATE: APRIL 1987
PROJECT NO: F 020-119 JRP/ROW SHEET 19 OF 69

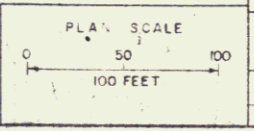

CONTROL OF ACCESS COMPLETE ON THIS SHEET.