

**GUARD RAIL REQUIRED ON LEFT**

Sta. 194+00 to Sta. 195+12	Length 24 FT
197+20	24
200+00	24
206+45	24
211+67	24
214+63	24

**GUARD RAIL REQUIRED ON RIGHT**

Sta. 194+00 to Sta. 195+12	Length 24 FT
197+28	24
200+00	24
206+45	24
211+67	24
214+53	24

**NEW CULVERTS REQUIRED**

Sta. 195+00 - 10' Cor. Iron 20" Concrete Headwall (equal 0-1-1)	
197+40 - 10'	28
201+00 - 10'	26
206+52 - 10'	28
211+73 - 10'	28
214+10'	32

*Allowance for drainage 40" - 160" for entire job.*

NO. ROAD	STATE	SECTION	SECTION	SECTION	SECTION
8	VT	10	20	30	40

TOTAL THIS SHEET 632 M

Scale: 1" = 100'  
 Date: 1914  
 Engineer: E. R. ...  
 Checked: ...

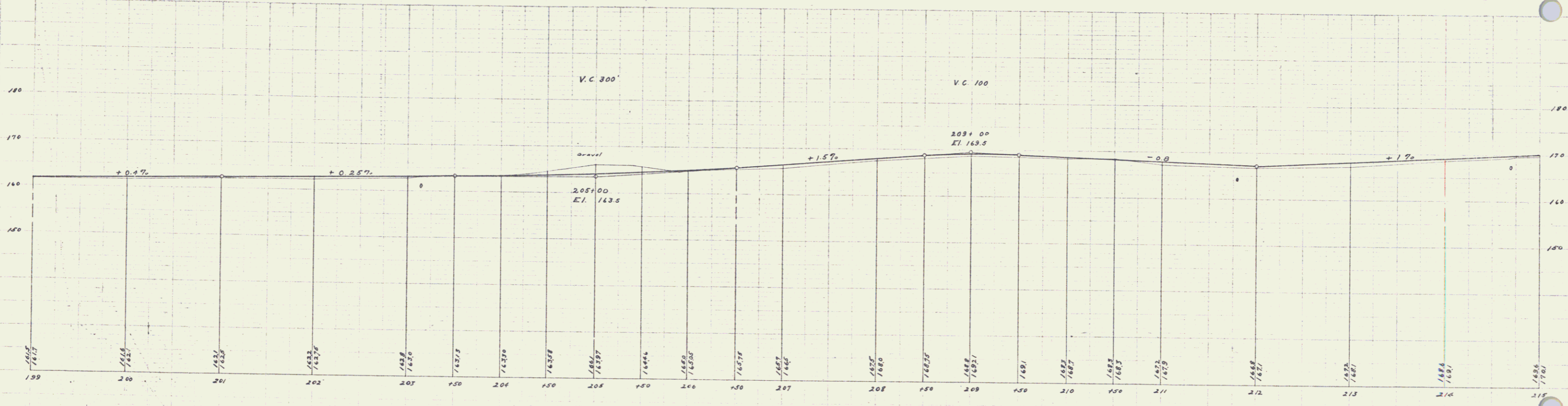
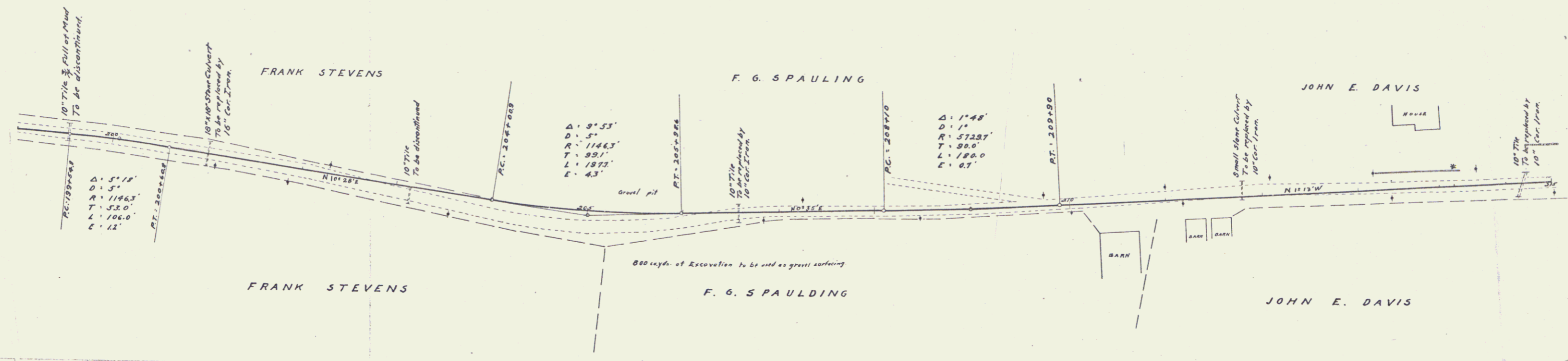

B.M. Nail in pole right of sta 205+23.5 El. 147.17  
 B.M. Sill line 3 Wly. cor. Spaulding's barn El. 143.02

Series 1, 1914, 110

15