

GUARD RAIL REQUIRED

ON LEFT

Sta	To Sta	Length	24"
126+42	126+46	4'	24"
131+40	131+44	4'	24"
135+10	135+14	4'	24"

ON RIGHT

Sta	To Sta	Length	24"
126+42	126+46	4'	24"
131+40	131+44	4'	24"
135+10	135+14	4'	24"
132+00	132+04	4'	11"

TOTAL THIS SHEET 306'

NEW CULVERTS REQUIRED

Sta	To Sta	Length	12" Can Iron 32' Concrete in Headworks 1 cu yd (1-1-8)	Culvert	SS - (1-2-4)
126+42	126+46	4'		55'	(1-2-4)
131+40	131+44	4'		22'	(1-2-4)
135+10	135+14	4'		3.8'	(1-2-4)
135+20	135+24	4'	shel 62°	6.8'	(1-2-4)
135+30	135+34	4'	shel 107°	10.3'	(1-2-4)

NO	DATE	BY	CHKD	DATE	NO	DATE	BY	CHKD	DATE
1	VE	10	IMP	11	12	13	14	15	16

Scale of Plan
1" = 100'
Scale of Profile
1" = 10'

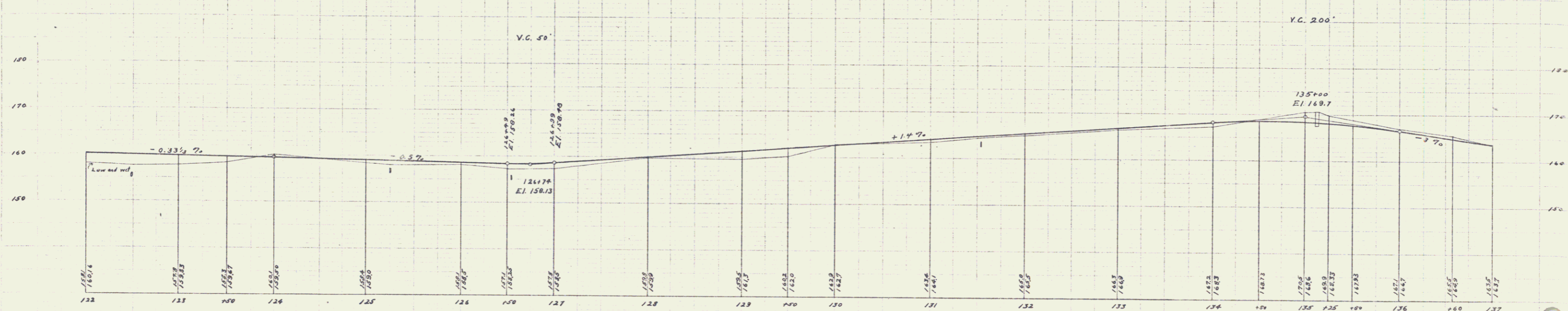
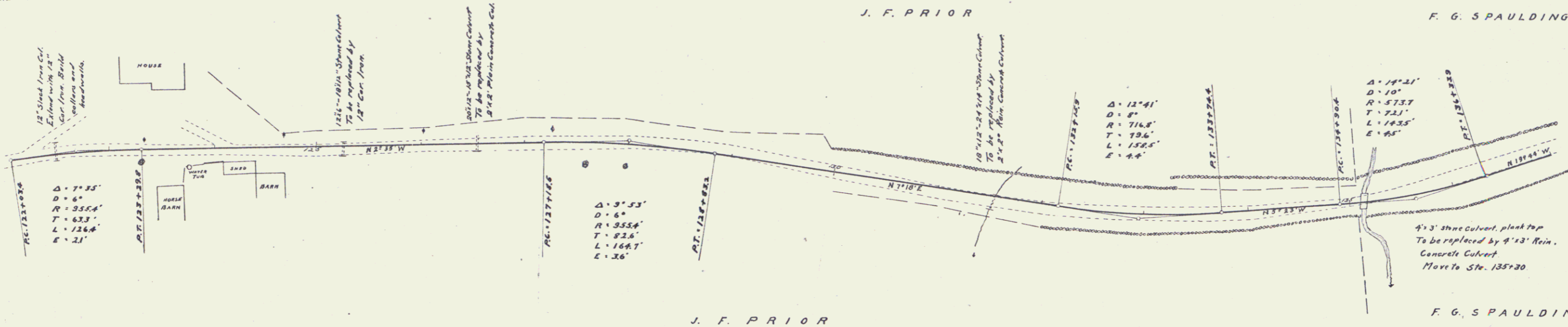

B.M. Sill, S.W. of House Barn El. 157.60
B.M. Nail in apple tree right of sta. 131+05' El. 165.27

DATE: 11/10/10