

GUARD RAIL REQUIRED
ON LEFT
 Sta 32+68 to Sta 32+92 Length 24 ft
 = 39+04 - 39+28 = 24 -
ON RIGHT
 Sta 31+00 to Sta 41+52 = 1052 -
 = 42+48 - 44+48 = 200 -
TOTAL THIS SHEET 1300 -

NEW CULVERTS REQUIRED
 Sta 32+80 - 10" Cur Iron 30 ft Culvert in Headcut 1 cut (1+2)
 = 33+15 - 11' - 26' - - - - - 1 - - - - -

NO	STA	NO	STA	NO	STA	TOTAL
1	VC	10	10	10	10	10
2	VC	10	10	10	10	10

PLAN
 DATE
 DRAWN BY
 CHECKED BY
 SCALE

ELEVATION
 DATE
 DRAWN BY
 CHECKED BY
 SCALE

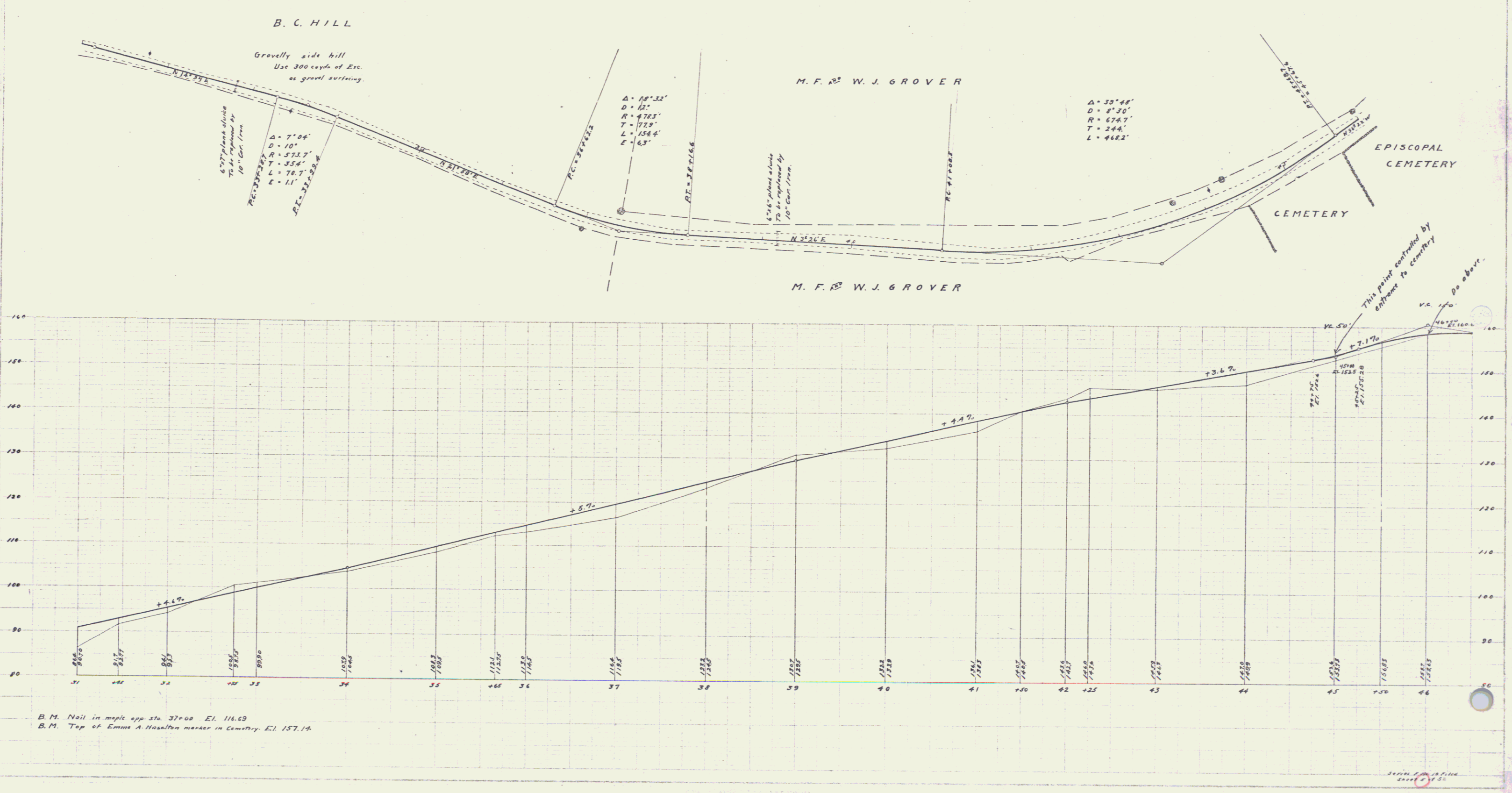

4