

BEING A PORTION OF THE RIGHT-OF-WAY OF U.S. RTE. 4 WHICH WAS TAKEN INTO THE STATE HIGHWAY SYSTEM ON APRIL 1, 1931 BY ORDER OF THE STATE HIGHWAY BOARD PURSUANT TO LEGISLATIVE ACT 61 OF 1931.

By Q

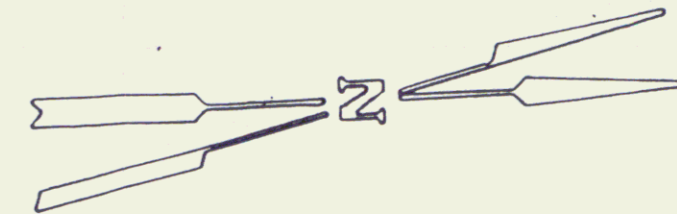

STATE OF VERMONT
TO
EHMANN, WILL
By Q.C.D. DATED 9/11/84 IN
SHERBURNE L.R. BK 70/439
MP 0489

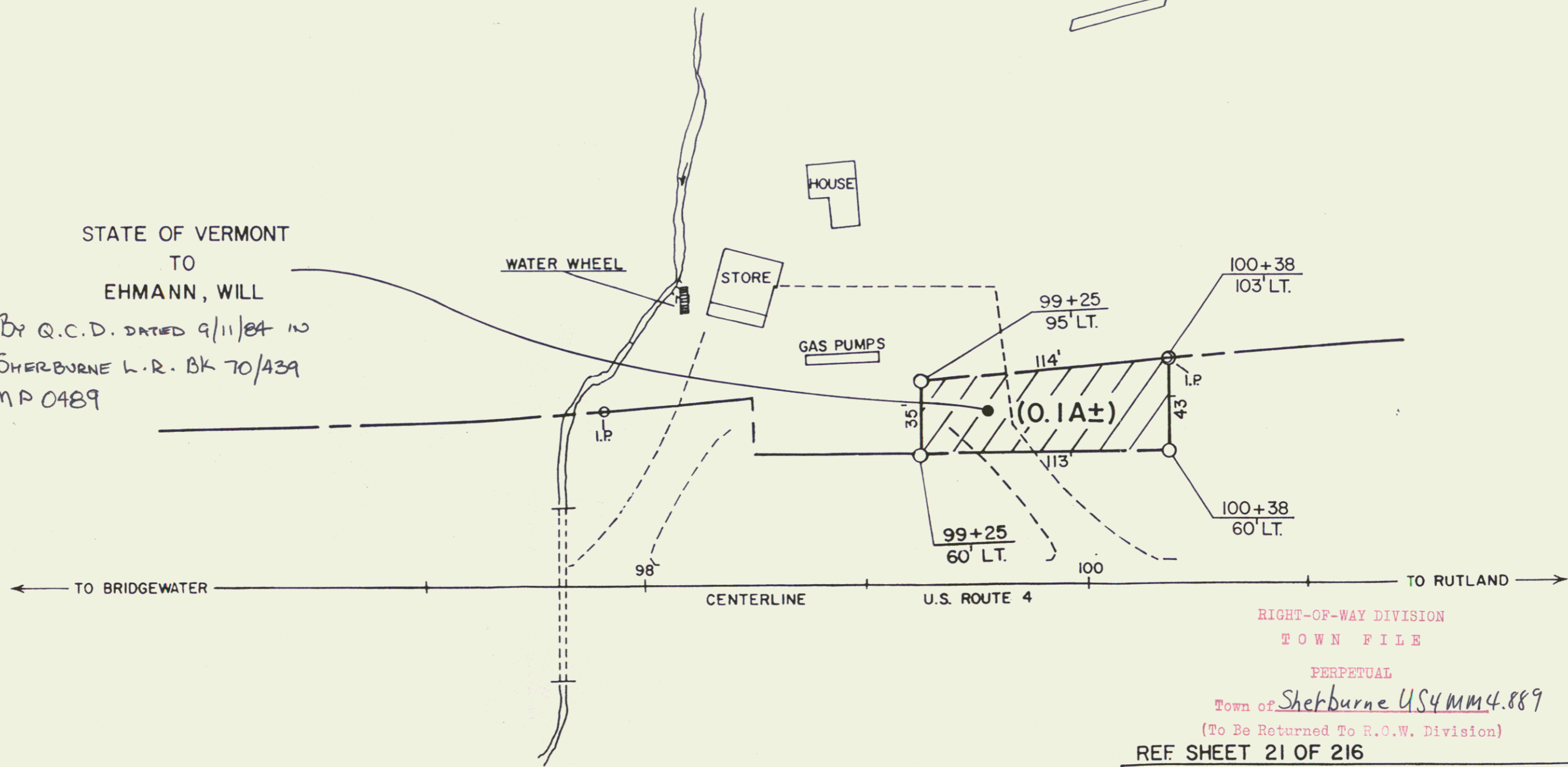

RIGHT-OF-WAY DIVISION
TOWN FILE
PERPETUAL

Town of Sherburne US4MM4.889
(To Be Returned To R.O.W. Division)

REF SHEET 21 OF 216

STATE OF VERMONT
AGENCY OF TRANSPORTATION

TOWN OF SHERBURNE

21B

PROJECT: SHERBURNE F 020-2(6)

APPROX SCALE 1"=50' DATE 8-2-84 DRAWN BY DEM

