

INDEX OF SHEETS

| | |
|-------------|--|
| SHEET NO. 1 | TITLE PAGE |
| 2 | TYPICAL CROSS-SECTION OF IMPROVEMENT CRUSHED GRAVEL MIXED-IN-PLACE SURFACE COURSE WITH REFINED T&M, ITEM 341 (SCOOPED) |
| 3 | BANKING AND WIDENING TABLES |
| 4 | QUANTITY SHEET (ITEMS) |
| 5 | QUANTITY SHEET (DRAINAGE) |
| 6-7 | EARTHWORK SHEETS |
| 8-10 | PLAN AND PROFILE SHEETS |
| 11 | STANDARD STRUCTURE SHEET S-40 (BARRICADES, SIGNS AND LIGHTS-ROADWAY) |
| 12 | STANDARD STRUCTURE SHEET CONSTRUCTION DETAILS (DRAINAGE AND MARKERS) |
| 13 | STANDARD STRUCTURE SHEET CONSTRUCTION DETAILS CD-1 (DITCHES) |
| 14 | STANDARD STRUCTURE SHEET CONSTRUCTION DETAILS CD-2 (ROUNDING OF SLOPES) |
| 15 | STANDARD STRUCTURE SHEET S-45-45 (GUARD RAIL) |
| 16 | BRIDGE PLAN AND SECTION |
| 17 | DETAILS OF ABUTMENT NO.1 |
| 18 | DETAILS OF ABUTMENT NO.2 |
| 19 | DETAILS OF SUPERSTRUCTURE |
| 20 | REINFORCING STEEL DETAILS |
| 21-24 | CHANNEL SECTIONS |
| 25 | STANDARD STRUCTURE SHEET SB-20 (BRIDGE CONSTRUCTION DETAILS) |
| 26 | STANDARD STRUCTURE SHEET SB-5-S4 (RAILING DETAILS) |
| 27 | STANDARD STRUCTURE SHEET SB-11 (BARRICADES, SIGNS AND LIGHTS-BRIDGE) |
| 28-33 | CROSS SECTIONS |

STANDARD STRUCTURE SHEET APPROVED BY THE CHIEF ENGINEER, VERMONT STATE DEPARTMENT OF HIGHWAYS.
S 40 JUNE 10, 1950

| | | | |
|--|--------------------|--|---------------|
| PROJECT NAME & NUMBER | | TYPE | PAVEMENT AREA |
| SHERBURNE F 10(2) & F 76(5) | | MIXED-IN-PLACE | 3466 S.Y. |
| RECORD PLANS | | | |
| MATERIALS | | | |
| SUB-BASE OF GRAVEL GIFFORD PIT SHERBURNE | TAR | OLD COLONY TAR CO. WORCESTER, MASS. | |
| BIT. CONC. BLAKTOP, INC. W. LEBANON, N. H. | REINF. STEEL | TRUSCON STEEL CO. YOUNGSTOWN, OHIO | |
| CONC. AGG. TWIN STATE SAND & GR. INC. W. LEBANON, N.H. | CEMENT | GLENS FALLS PORT. CEM. CO. GLENS FALLS | |
| RCP VT CONC. PIPE CO. WINDSOR | GUARD RAIL | AM. STEEL & WIRE CO. NEW HAVEN, CONN. | |
| CONTRACTOR O.W. MILLER CO. INC. LUDLOW, MASS. | CONTRACT DATED | APR. 7 1952 | |
| RES. ENGINEER M. M. OGDEN | CONTRACT STARTED | APR 7 1952 | |
| INSPECTOR | CONTRACT COMPLETED | AUG 20 1953 | |
| RECORD PLANS H. A. HEALD | CONTRACT ACCEPTED | AUG 20 1953 | |

STATE OF VERMONT
STATE HIGHWAY DEPARTMENT

PLAN AND PROFILE OF PROPOSED
STATE HIGHWAY

FEDERAL PROJECT

TOWN OF SHERBURNE
COUNTY OF RUTLAND
U.S. ROUTE 4
WOODSTOCK-RUTLAND ROAD

BEGINNING AT A POINT APPROXIMATELY 1,050 FEET SOUTHERLY OF THE U.S. POST OFFICE IN THE HAMLET OF SHERBURNE AND EXTENDING NORTHWESTERLY 1,300.0 FEET.

LENGTH OF ROADWAY F 10(2) 912.0 FEET = 0.173 MI.
LENGTH OF ROADWAY F 76(5) 354.0 FEET = 0.067 MI.
LENGTH OF BRIDGE F 76(5) 340 FEET = 0.006 MI.

TOTAL LENGTH 1,300.0 FEET = 0.246 MI.

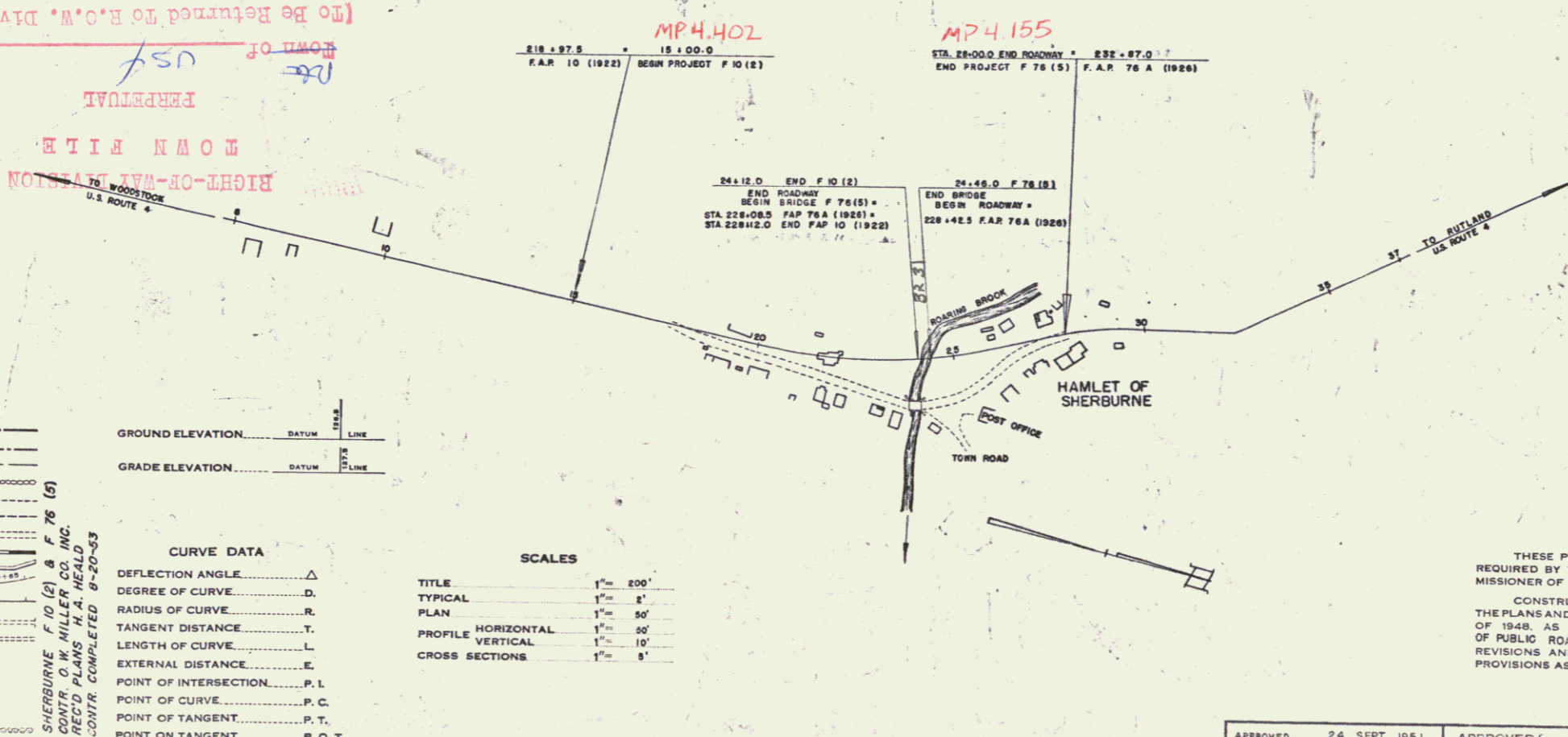
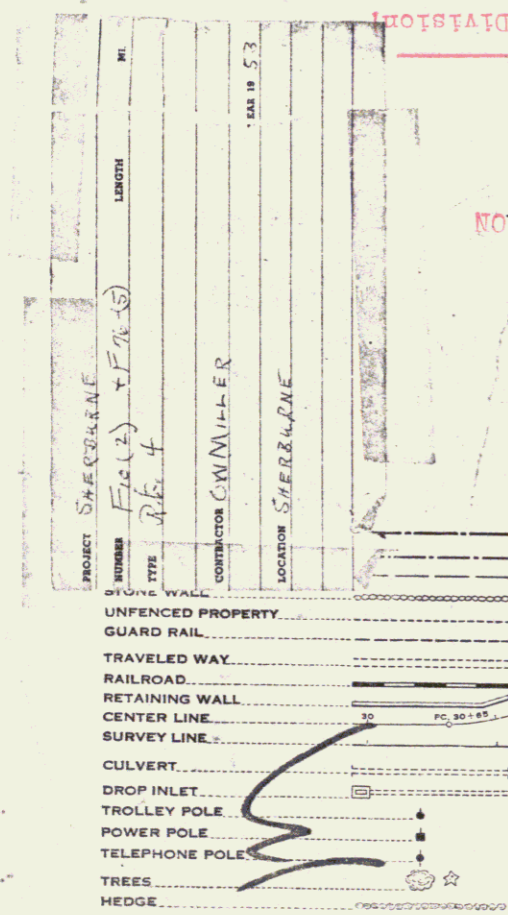
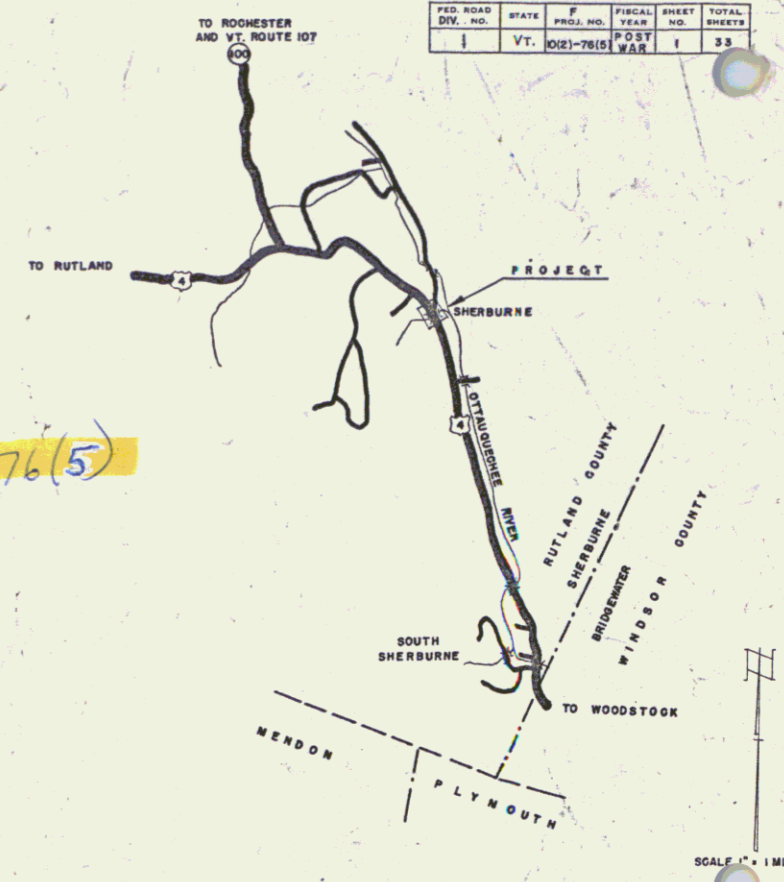

GROUND ELEVATION DATUM LINE
GRADE ELEVATION DATUM LINE

CURVE DATA

| | |
|-----------------------|--------|
| DEFLECTION ANGLE | Δ |
| DEGREE OF CURVE | D |
| RADIUS OF CURVE | R |
| TANGENT DISTANCE | T |
| LENGTH OF CURVE | L |
| EXTERNAL DISTANCE | E |
| POINT OF INTERSECTION | P.I. |
| POINT OF CURVE | P.C. |
| POINT OF TANGENT | P.T. |
| POINT ON TANGENT | P.O.T. |

SCALES

| | |
|--------------------|-----------|
| TITLE | 1" = 200' |
| TYPICAL | 1" = 4' |
| PLAN | 1" = 50' |
| PROFILE HORIZONTAL | 1" = 50' |
| PROFILE VERTICAL | 1" = 10' |
| CROSS SECTIONS | 1" = 1' |

APPROVED: NOV. 6 '51
H.E. Laing
CHIEF ENGINEER
SUBMITTED BY ORDER OF THE STATE HIGHWAY BOARD

NOTES: ANY FURTHER INFORMATION CONCERNING FINAL QUANTITIES AND COSTS SHOULD BE OBTAINED RELATIVE TO A SPECIFIC PROJECT FROM THE DISTRICT ENGINEER OF THE COUNTY.

THESE PLANS ARE SUBJECT TO SUCH REVISIONS AS MAY BE REQUIRED BY THE BUREAU OF PUBLIC ROADS OR THE COMMISSIONERS OF HIGHWAYS.
CONSTRUCTION IS TO BE CARRIED ON IN ACCORDANCE WITH THE PLANS AND THE STANDARD ROAD AND BRIDGE SPECIFICATIONS OF 1948, AS APPROVED JULY 25, 1949 BY THE BUREAU OF PUBLIC ROADS INCLUDING ALL SUBSEQUENT APPROVED REVISIONS AND SUCH REVISED SPECIFICATIONS AND SPECIAL PROVISIONS AS ARE SUBMITTED WITH THE PLANS.

DEPARTMENT OF COMMERCE
BUREAU OF PUBLIC ROADS

RECOMMENDED FOR APPROVAL

DISTRICT ENGINEER DATE

APPROVED

DIVISION ENGINEER DATE

| | | | |
|--|---|--|--|
| APPROVED: 24 SEPT 1951 <i>H.A. Heald</i> BRIDGE ENGINEER | APPROVED: 21 SEPT 51 <i>H.A. Heald</i> HIGHWAY ENGINEER | APPROVED: 15 Nov. 51 <i>Carl R. Wilson</i> DISTRICT ENGINEER | PROJECT # NO. 100-76(5) FILED SHEET 1 OF 33 |
|--|---|--|--|