

INDEX OF SHEETS

SHEET NO. | TITLE PAGE

- 2 SUMMARY - STANDARD STRUCTURES - NOTES
- 3-4 TYPICAL CROSS SECTIONS
- 5-7 PLAN SHEETS

PROJ. ROAD DIST. NO.	STATE	N. R. H. PROJ. NO.	TOTAL SHEETS	NO. OF SHEETS	TOTAL SHEETS
9	VT.	108-C	1934	1	7

(Landscaping)
Sheet I

STATE OF VERMONT
STATE HIGHWAY DEPARTMENT

PLAN AND PROFILE OF PROPOSED
STATE HIGHWAY

NATIONAL RECOVERY HIGHWAY PROJECT

ROADSIDE DEVELOPMENT
PLANTING PLAN

SECTION 1

TOWN OF HARTFORD
WOODSTOCK-WHITE RIVER JCT. ROAD
ROUTE US-4

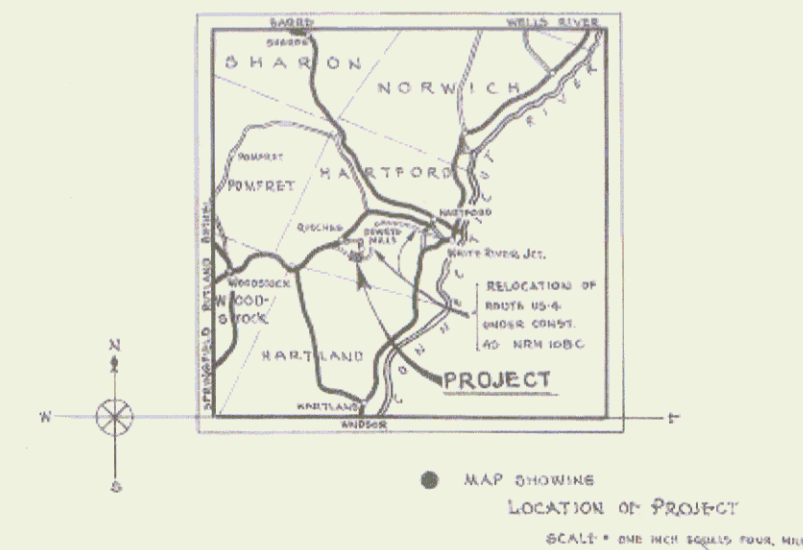

CONVENTIONAL SIGNS

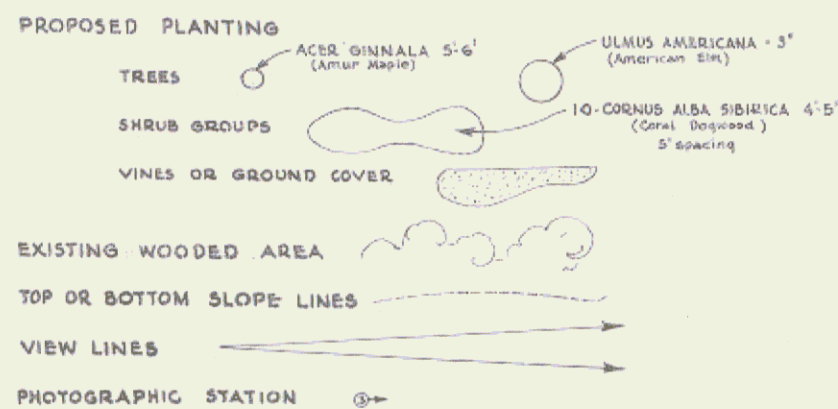

LOCATED IMMEDIATELY EAST AND WEST OF THE GORGE OF THE OTTAUQUECHEE RIVER
AT DEWEY'S MILLS - BETWEEN STA. 354+00 AND STA. 370+25 OF NRH 108-C

LENGTH OF PROJECT: 13296 FT. = 0.251 MILES

SCALE
PLAN - - - 1" = 20'
TYPICAL SECTIONS - 1" = 5'

MP 3.106-3.414

APPROVED *March 17, 1934*
H. Baugust
COMMISSIONER OF HIGHWAYS

SUBMITTED BY ORDER OF THE STATE HIGHWAY BOARD

These plans are subject to such revisions as may be required by the Bureau of Public Roads or the Commissioner of Highways. Construction is to be carried on in accordance with the plans and the Standard Road and Bridge Specifications of 1933, with such revised specifications and special provisions as are submitted with these plans.

COUNTY LINE	-----
TOWN LINE	-----
FENCE LINE	-----
STONE WALL	-----
UNFENCED PROPERTY - R.O.W.	-----
GUARD RAIL	-----
TRAVELED WAY (UNMETALLED)	-----
RETAINING WALL	-----
CENTER LINE	-----
SURVEY LINE	-----
CULVERT	-----
DROP INLET	-----
TROLLEY POLE	-----
POWER POLE	-----
TELEPHONE POLE	-----
TREES	-----
HEDGE	-----

GROUND ELEVATION	-----
GRADE ELEVATION	-----

CURVE DATA

DEFLECTION ANGLE	Δ
DEGREE OF CURVE	D
RADIUS OF CURVE	R
TANGENT DISTANCE	T
LENGTH OF CURVE	L
EXTERNAL DISTANCE	E
POINT OF INTERSECTION	P.I.
POINT OF CURVE	P.C.
POINT OF TANGENT	P.T.
POINT ON TANGENT	P.O.T.

PROJECT: *1934*
ROAD ENGINEER

SERIES NRH NG 108-C (LANDSCAPING I)
SHEET 11 OF 7