

GUIDE POSTS OF WOOD

STATION	LEFT	RIGHT
157.53	-	1'
160.38	-	1'
160.38	-	1'

WOOD GRAVEL

STATION	LEFT	RIGHT
161.75	26'	24'
162.35	26'	24'
162.35	26'	24'

CANYON GRAVEL

STATION	LEFT	RIGHT
162.35	27'	25'
162.35	27'	25'
162.35	27'	25'

ALL KINDS OF GRAVEL

STATION	LEFT	RIGHT
162.35	27'	25'
162.35	27'	25'
162.35	27'	25'

REINFORCED CONCRETE BOX CULVERTS

STATION	LEFT	RIGHT
162.35	27'	25'
162.35	27'	25'
162.35	27'	25'

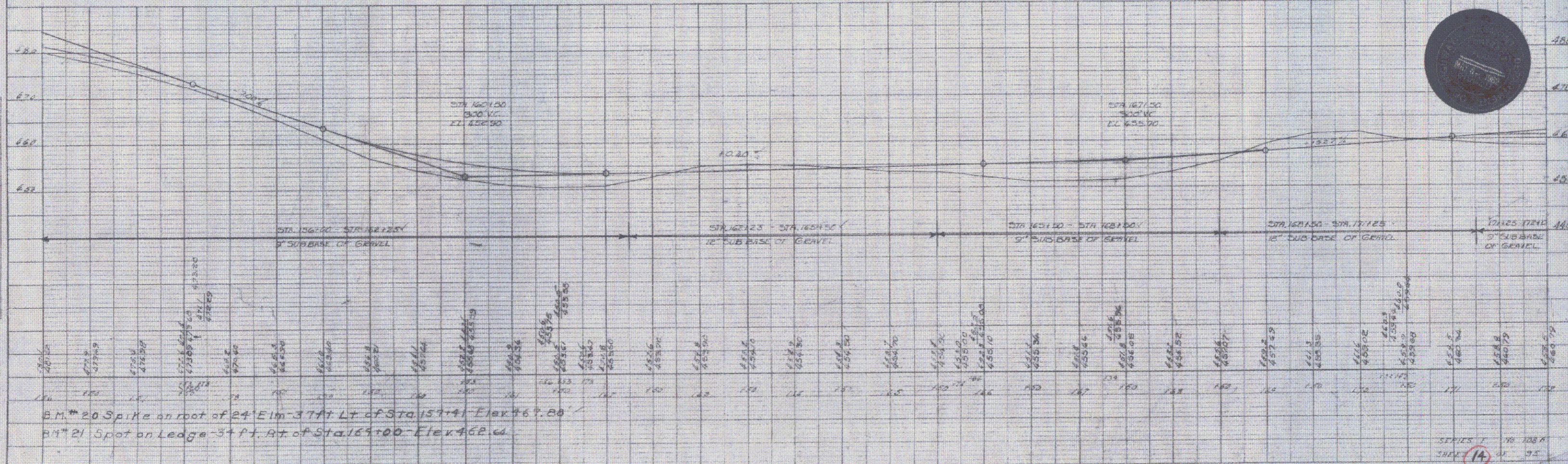
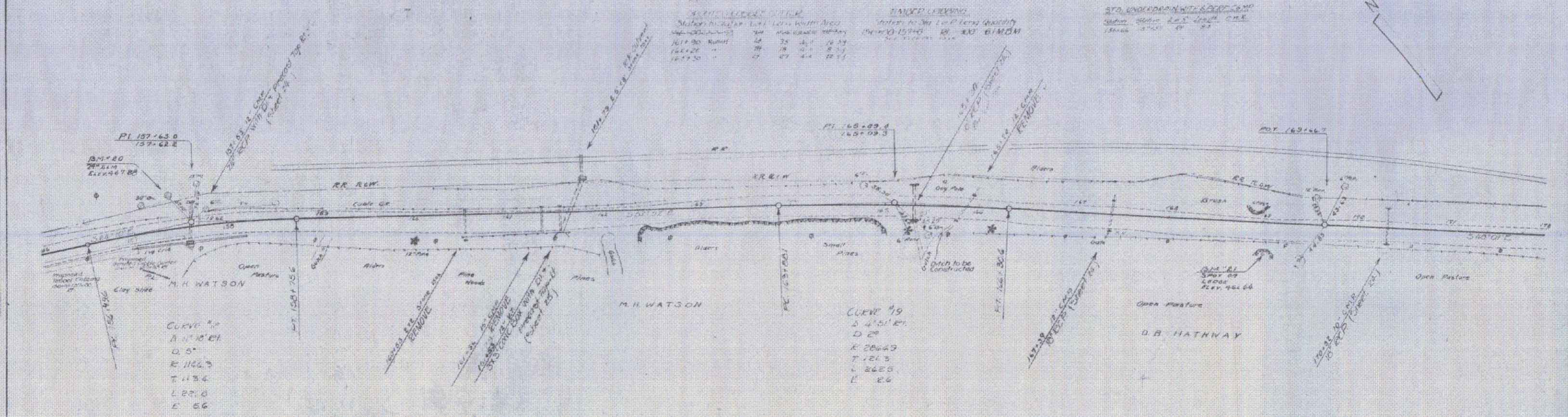

B.M. #20 Spike on root of 24 Elm 37 ft Lt of Sta 157.41 Elev 7.20
 B.M. #21 Spot on Ledge 37 ft Rt of Sta 169.00 Elev 4.62