

**WOOD GUARD RAIL**

CONCRETE STA.	4	5
77+30	24	24
84+35.4	24	24
96+64	24	24

**WOOD GUIDE POSTS**

STATION	LEFT	RIGHT
79+30	+	+
83+25	+	+
89+25	+	+
94+25	+	+

**REINFORCED CONCRETE BOX CULVERTS**

STATION	SIZE	CONC. A	STEEL
84+85	3x4	200	1570
		27.5	2475

**CABLE GUARD RAIL**

STATION	STA.	LOCK	LENG.	EQUIDISTANT	PAY LENG.
84+85	84+85	40'	40'	400'	

**REINFORCED CONCRETE PIPE CULVERTS**

STATION	SIZE	LENG.	CONC. A	CONC. B	CONC. C	CONC. D	STEEL
85+18	18"	44'	20.4	14.4	14.4	14.4	150

**CORROLATED GALVANIZED METAL PIPE COATED**

STATION	SIZE	LENG.	CONC. A	CONC. B	CONC. C	CONC. D	STEEL
87+23	36"	67'	20.4	14.4	14.4	14.4	200
92+92	18"	36'	1.6	200	14.4	14.4	150

**GRADED COBBLE GUTTER**

STA TO STA.	LOCK	LENG.	WIDTH	AREA
84+85-85+00	RT	15'	10.0	150
85+00-85+30	RT	30'	12.5	375
85+30-87+00	RT	15'	12.5	187.5
87+00-92+00	RT	15'	12.5	187.5
92+00-92+00	RT	0'	12.5	0

**TIMBER CRIBBING**

STA TO STA.	LOCK	LENG.	QUANTITY
86+20-86+70	R	72'	4.8 M.G.M.
92+00-96+00	R	300'	182

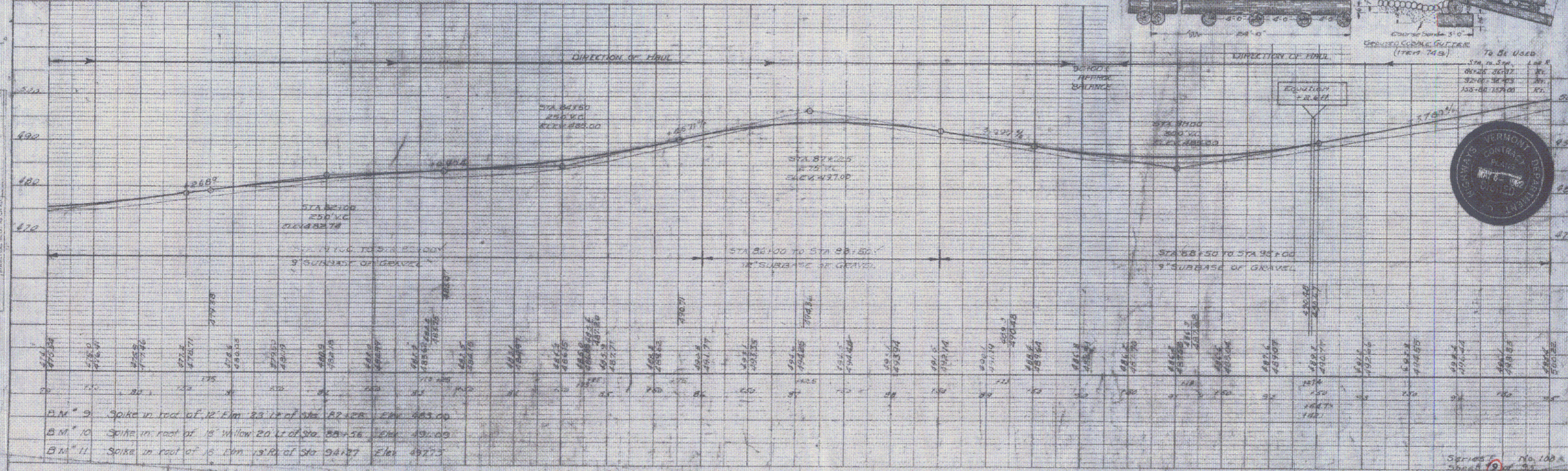
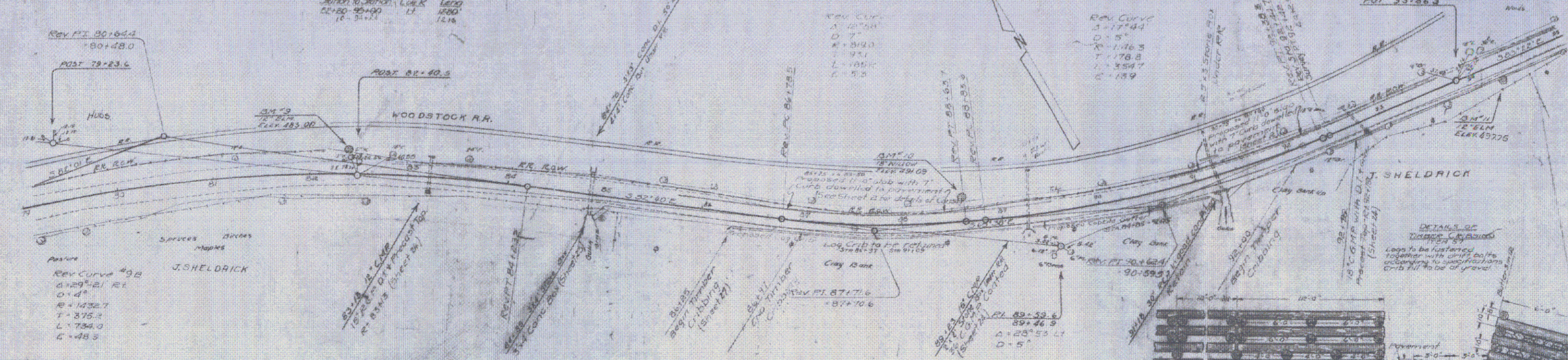

B.M. 9 Spike in root of 12 Elm 23.12 of Sta. 82+25 Elev. 483.00  
 B.M. 10 Spike in root of 18 Willow 20.14 of Sta. 88+36 Elev. 491.00  
 B.M. 11 Spike in root of 5 Elm 13.10 of Sta. 94+27 Elev. 492.75

