

WOOD GLASS RAIL
 CURVANT STA. LEFT RIGHT
 65+30.7 24' 24'
 69+27.4 24' 24'
 76+50.7 24' 24'

CABLE GUARD RAIL
 STA TO STA OR TO LENGTH CONSTANT PAV LENGTH
 65+30.7-66+48.4 47' 48' 40' 8-3
 66+48.4-70+00.0 41' 42' 40' 10-0
 70+00.0-72+11.1 21' 11' 40' 16-2

INTERPOLATED CURVES TO A.C. L. LEVELS
 STATION 65+30.7 TO 70+00.0
 71+15.4
 71+51.4
 71+87.4

INTERPOLATED CURVES FROM GULVERTS
 STATION 65+30.7 TO 70+00.0
 71+15.4
 71+51.4
 71+87.4

SLIDE POSTS OF WOOD
 STATION LEFT RIGHT
 76+50

REV CURVE #2
 Δ 152°11'
 D 41'
 R 1152.7
 T 148.9
 L 356.5
 C 99

REV CURVE #3
 Δ 54°50' 41"
 D 71'
 R 819.0
 T 286.9
 L 497.6
 C 29.4

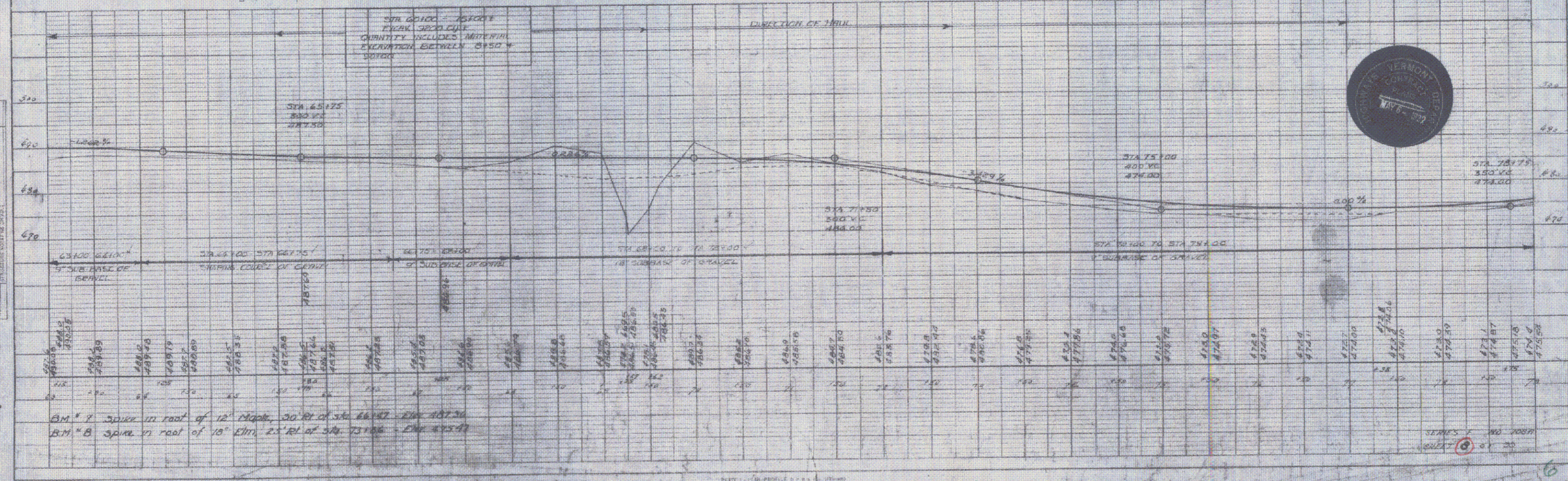
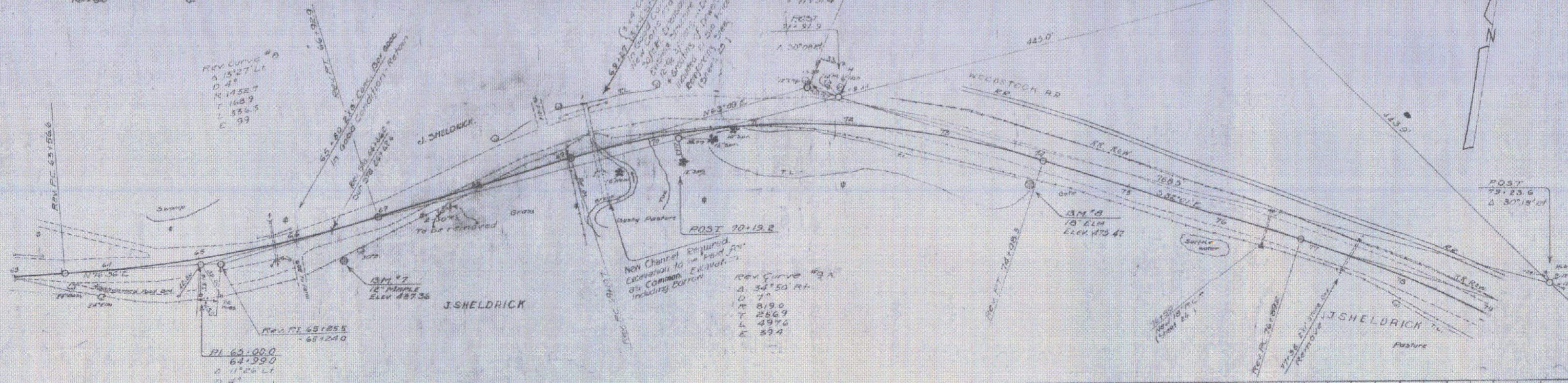

PLAN
 DATE
 DRAWN BY
 CHECKED BY
 IN CHARGE



BM #7 SPIKE IN FOOT OF 12" MAPLE 20' RT. OF STA 66+47 - ELEV 487.30
 BM #8 SPIKE IN FOOT OF 10" ELM. 21' RT. OF STA 73+00 - ELEV 492.47