

|                     |       |             |           |              |
|---------------------|-------|-------------|-----------|--------------|
| FED. ROAD DIST. NO. | STATE | FISCAL YEAR | SHEET NO. | TOTAL SHEETS |
| 9                   | Vt.   | 1928        | 5         | 48           |

WOOD: GUARD RAIL REQUIRED  
 ON RIGHT  
 STA. 11+95.7 TO STA. 12+19.7 LENGTH 24'  
 STA. 12+40.7 TO STA. 12+64.7 LENGTH 24'

SECTION R-2  
 STA. 12+40.7 - 28+50

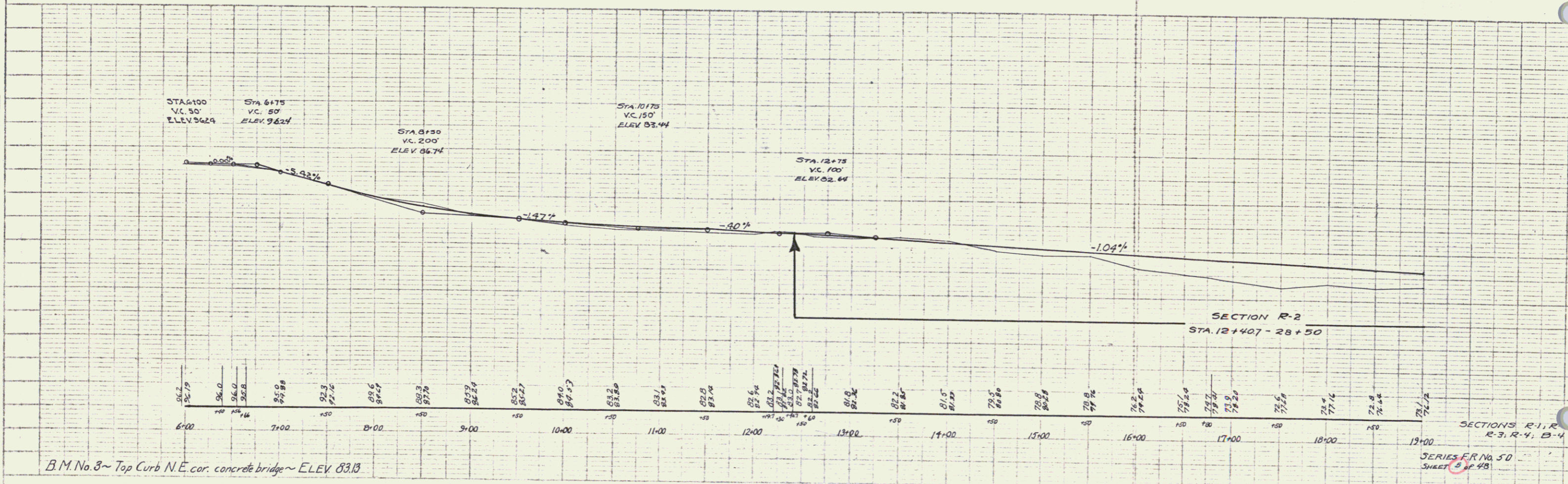
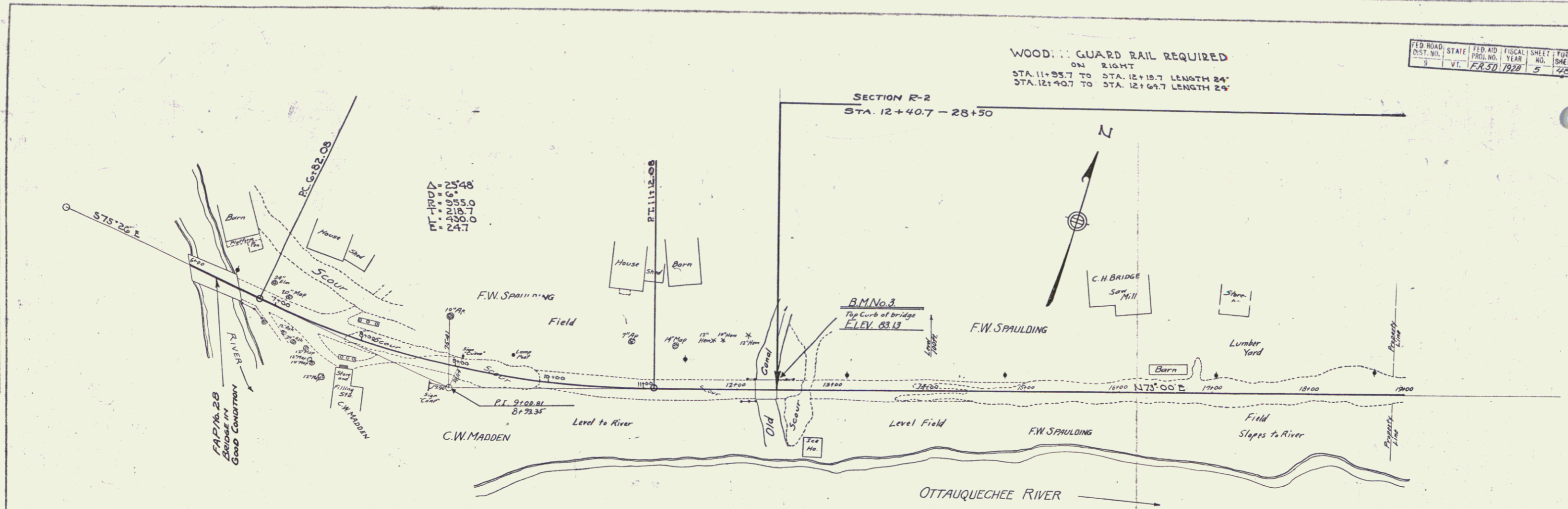

B.M. No. 8 - Top Curb N.E. cor. concrete bridge - ELEV. 83.13

SECTIONS R-1, R-2, R-3, R-4, B-1, B-2, B-3, B-4  
 SERIES R No. 50  
 SHEET 5 OF 48

PLAN  
 DATE: 1928  
 DRAWN BY: J. S. [unclear]  
 CHECKED BY: [unclear]

PROFILE  
 DATE: 1928  
 DRAWN BY: J. S. [unclear]  
 CHECKED BY: [unclear]