

#65
BK 37 Pg 248
8/8/74

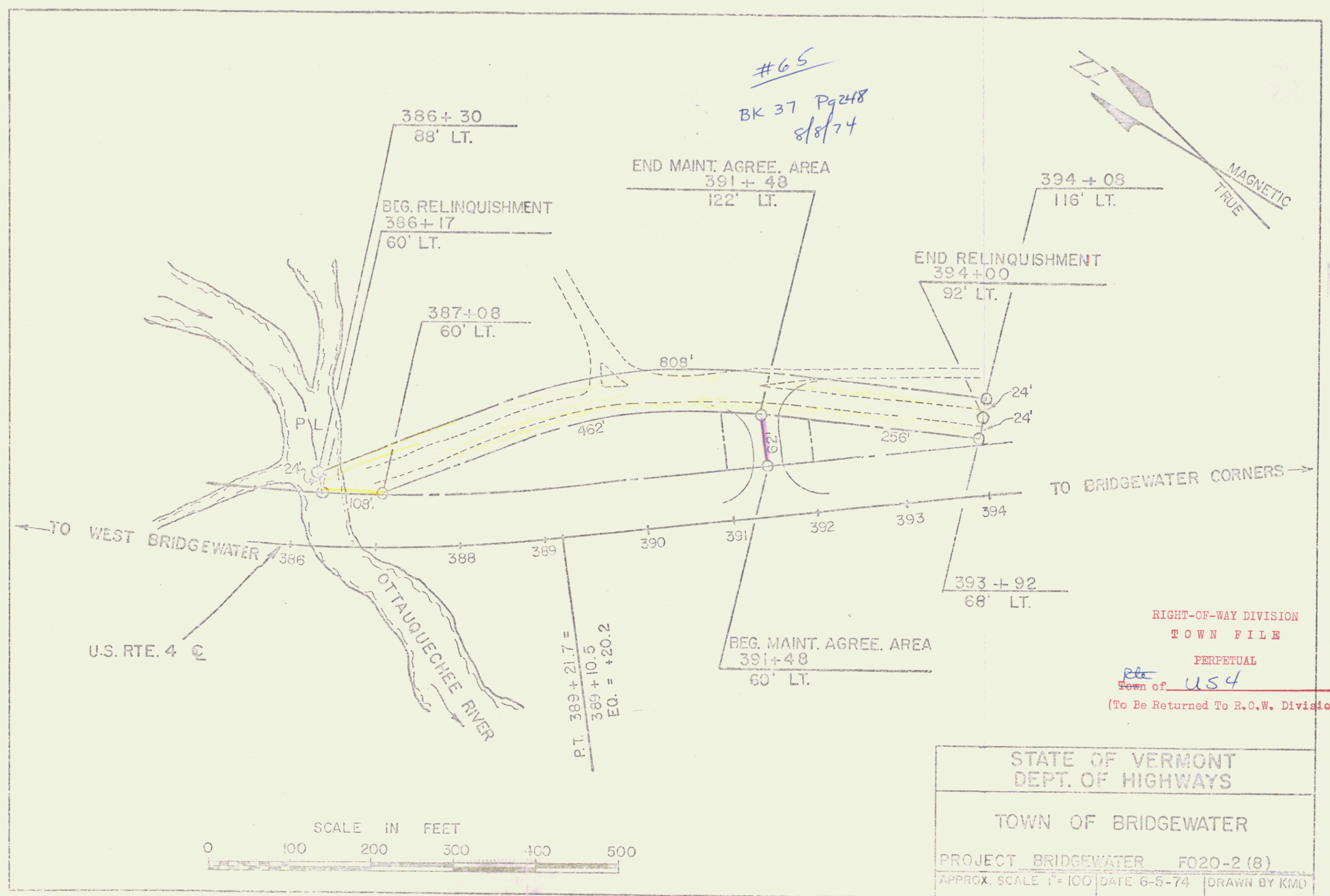

RIGHT-OF-WAY DIVISION
TOWN FILE
PERPETUAL
Town of US4
(To Be Returned To R.O.W. Division)

STATE OF VERMONT
DEPT. OF HIGHWAYS
TOWN OF BRIDGEWATER
PROJECT BRIDGEWATER F020-2(8)
APPROX. SCALE 1"=100' DATE 6-5-74 DRAWN BY KMD

SHEET 15A

8