

UNCLASSIFIED CHANNEL EXCAVATION, ITEM 105  
203+00 - 216+25 RT. V

EXCAVATION AND REMOVAL OF ROAD SURFACE ON ROADWAYS  
ITEM 119-A  
202+00 - 212+00 LT.

THREE CABLE GUARD RAIL WITH STEEL POSTS  
ITEM 543  
202+00 - 216+00 RT.  
204+00 - 213+00 LT.  
GOODNOW

PLANK GUARD RAIL, ITEM 541-A  
203+00 - 216+00  
214+25 - 216+00  
204+50 LT. 1/4"

STONE FILL FOR SLOPE PROTECTION  
ITEM 522  
202+00 - 216+25 RT.  
209+75 - 213+25 RT. (BACK SIDE)  
214+00 - 217+25 RT.

HARLEY E. & ANNE M. HESELTON

CONSTRUCT APPROACH  
214+25 LT.

STEEL GUIDE POSTS  
203+15 - 213+50 LT. - 60"

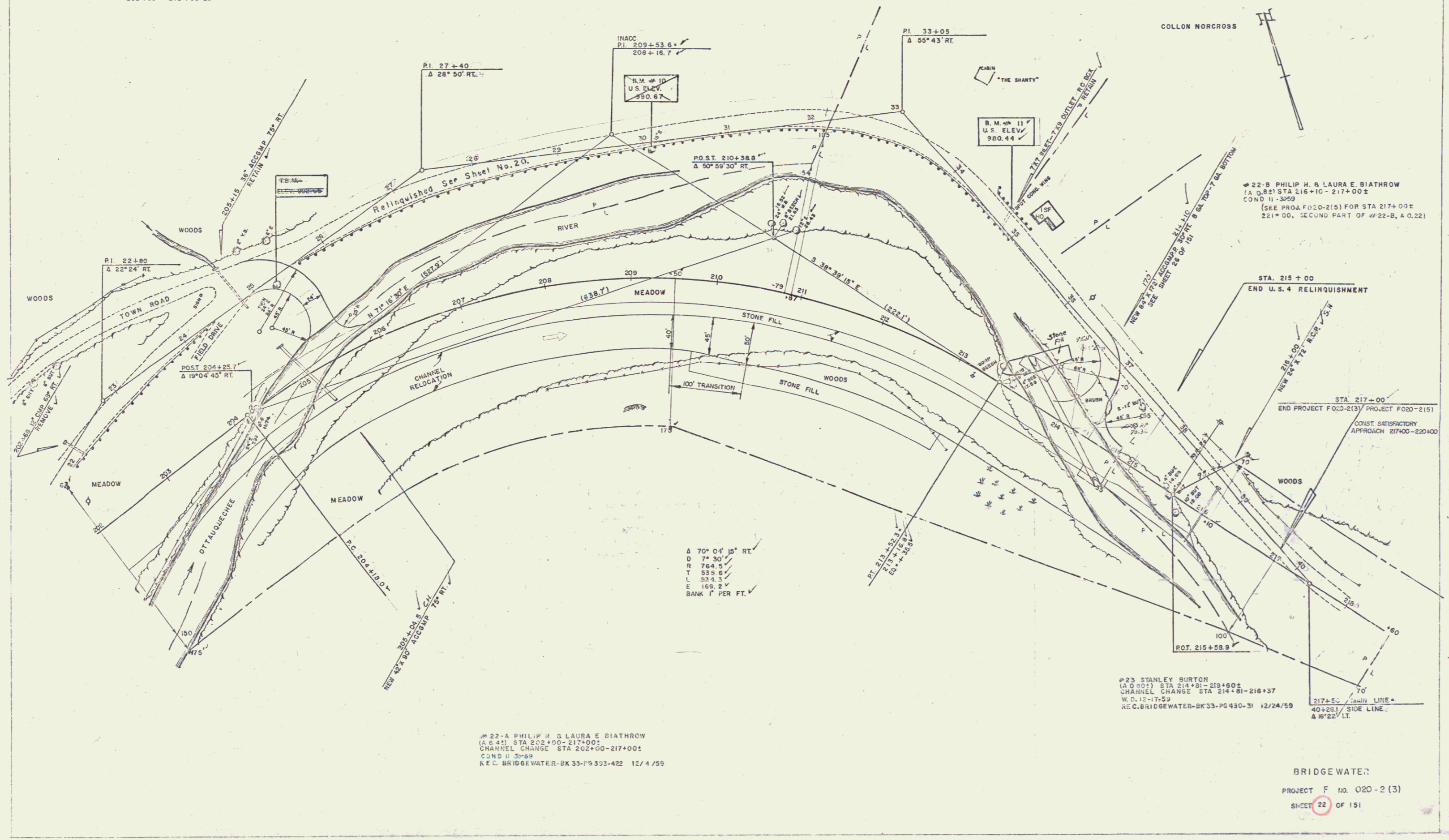

Approved by: Philip H. Burton

#22-A PHILIP H. S. LAURA E. BIATHROW  
(A. 6.41) STA 202+00 - 217+00  
CHANNEL CHANGE STA 202+00 - 217+00  
COND II - 3969  
REC. BRIDGEWATER - BK 33-P 333-422 12/4/59

#23 STANLEY BURTON  
(A. 0.82) STA 214+81 - 218+80  
CHANNEL CHANGE STA 214+81 - 218+37  
W.D. 12-17-59  
REC. BRIDGEWATER - BK 33-PG 430-31 12/24/59

BRIDGEWATER  
PROJECT F NO. 020-2 (3)  
SHEET 22 OF 151

12