

STA. 59+50.0 STA. 754+50.7
 END PROJECT F 76 (8) BEGIN PROJECT F 76 (8)

MP 3.59

TO RUTLAND
 U.S. ROUTE 4

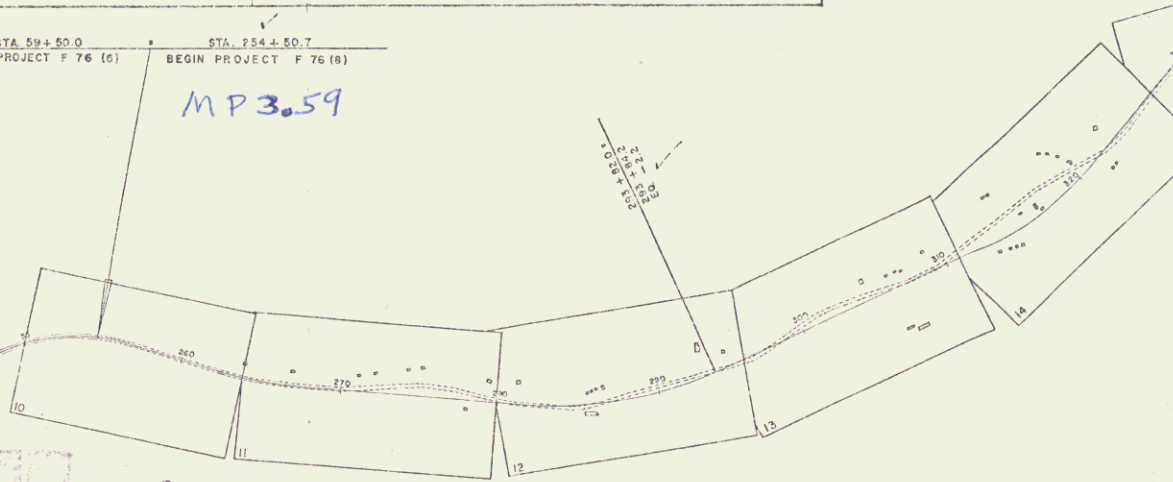

PROJECT MENDON - SHERBURNE
 NUMBER F 76 (8) LENGTH 3.043 MI.
 Bituminous Concrete Pavement
 CONTRACTOR BASLOW CONSTRUCTION CORP.
 RUTLAND, VERMONT YEAR 1953
 LOCATION Beginning at a point 12,404.7 feet west of the Mendon -
 Sherburne Town Line and extending easterly 16,067.7 feet.

PROJECT NAME MENDON - SHERBURNE
 CONTRACTOR BASLOW CONSTRUCTION CORP.
 RECORD PLANS - PREPARED BY E. KARR
 COMPLETED AUGUST 18, 1953

GROUND ELEVATION DATUM 106.3 LINE
 GRADE ELEVATION DATUM 127.5 LINE

CURVE DATA
 DEFLECTION OF ANGLE Δ
 DEGREE OF CURVE D
 RADIUS OF CURVE R
 TANGENT DISTANCE T
 LENGTH OF CURVE L
 EXTERNAL DISTANCE E
 POINT OF INTERSECTION P.I.
 POINT OF CURVE P.C.
 POINT OF TANGENT P.T.
 POINT ON TANGENT P.O.T.
 POINT ON SUB-TANGENT P.O.S.T.

SCALES
 TITLE 1" = 600'
 TYPICAL 1" = 2'
 PLAN 1" = 50'
 PROFILE HORIZONTAL 1" = 50'
 PROFILE VERTICAL 1" = 10'
 CROSS-SECTIONS 1" = 5'

APPROVED
 DATE NOV