

CABLE GUARD RAIL REQUIRED

STATION	LEFT	RIGHT
STA 4+15 TO 5+59	-	144'
" 6+84 - 7+32	40'	-
" 8+32 - 7+32	-	80'

Town: Mendon - Sturbridge
 Route: US 4 (Killington)
 Project: 76B East

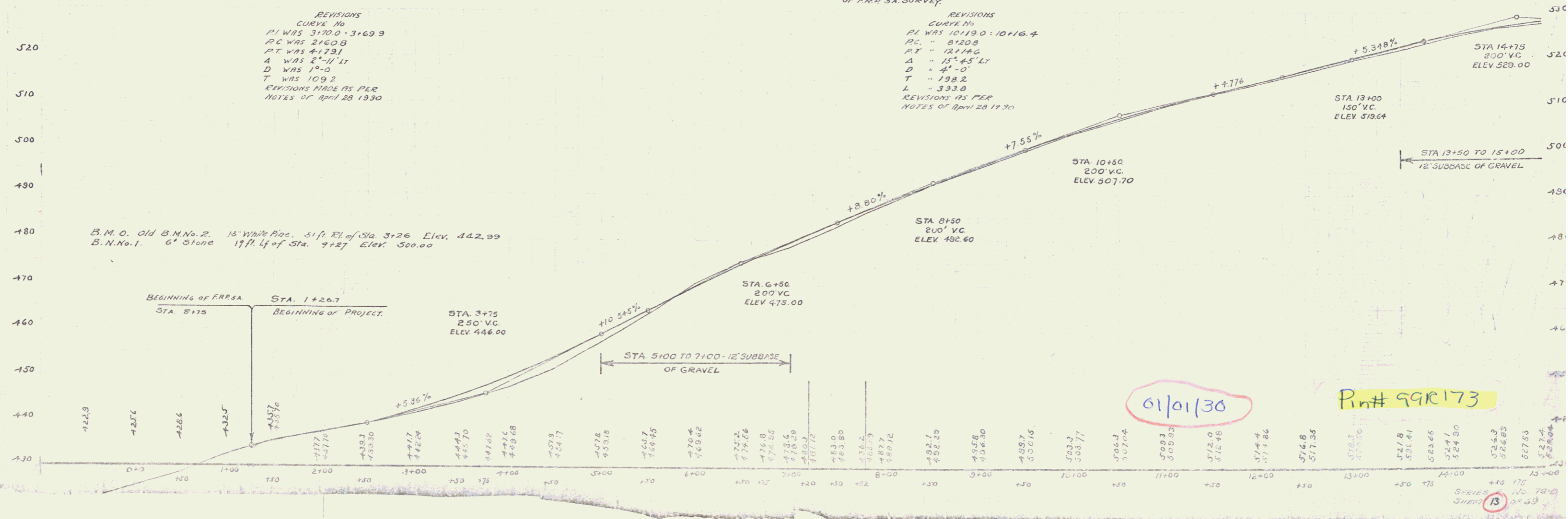
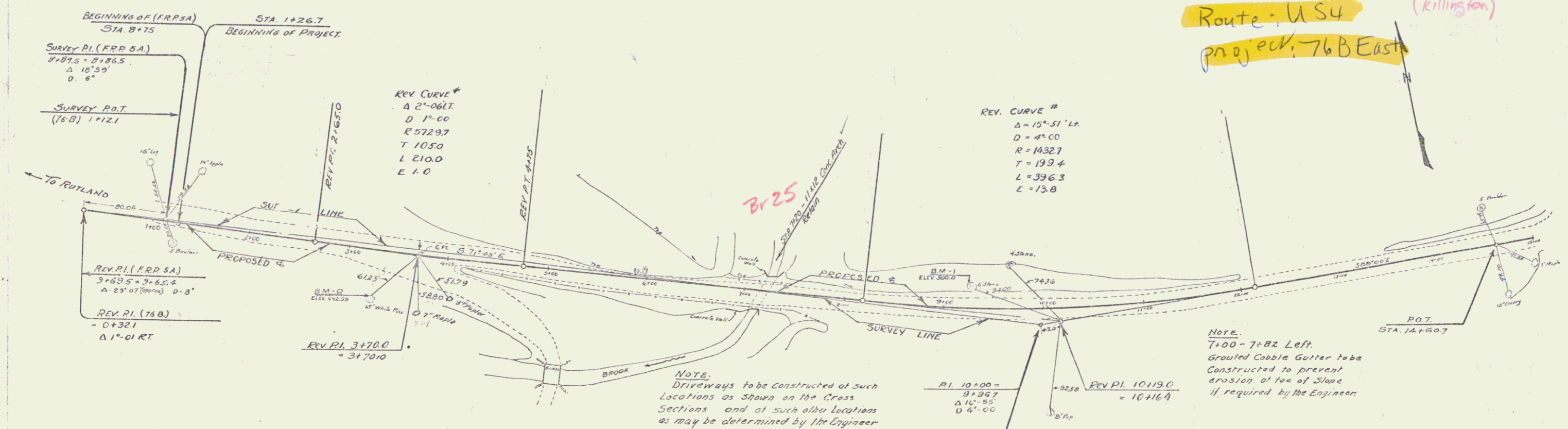

REVISIONS
 CURVE NO.
 P.I. WAS 3170.0 - 3+69.9
 P.C. WAS 2400.0
 P.T. WAS 4+179.1
 Δ WAS 2'-11.1T
 D WAS 1'-0
 T WAS 109.2
 REVISIONS MADE AS PER
 NOTES OF APRIL 28 1930

REVISIONS
 CURVE NO.
 P.I. WAS 10+19.0 - 10+16.4
 P.C. " 8120.0
 P.T. " 12+14.0
 Δ " 15'-4.5T
 D " 4'-0
 T " 198.2
 L " 393.8
 REVISIONS AS PER
 NOTES OF APRIL 28 1930

6/10/30

Plan # 99R173