

*Note -*  
 Driveways to be constructed to provide satisfactory approaches to roadway at locations determined by the Engineer.

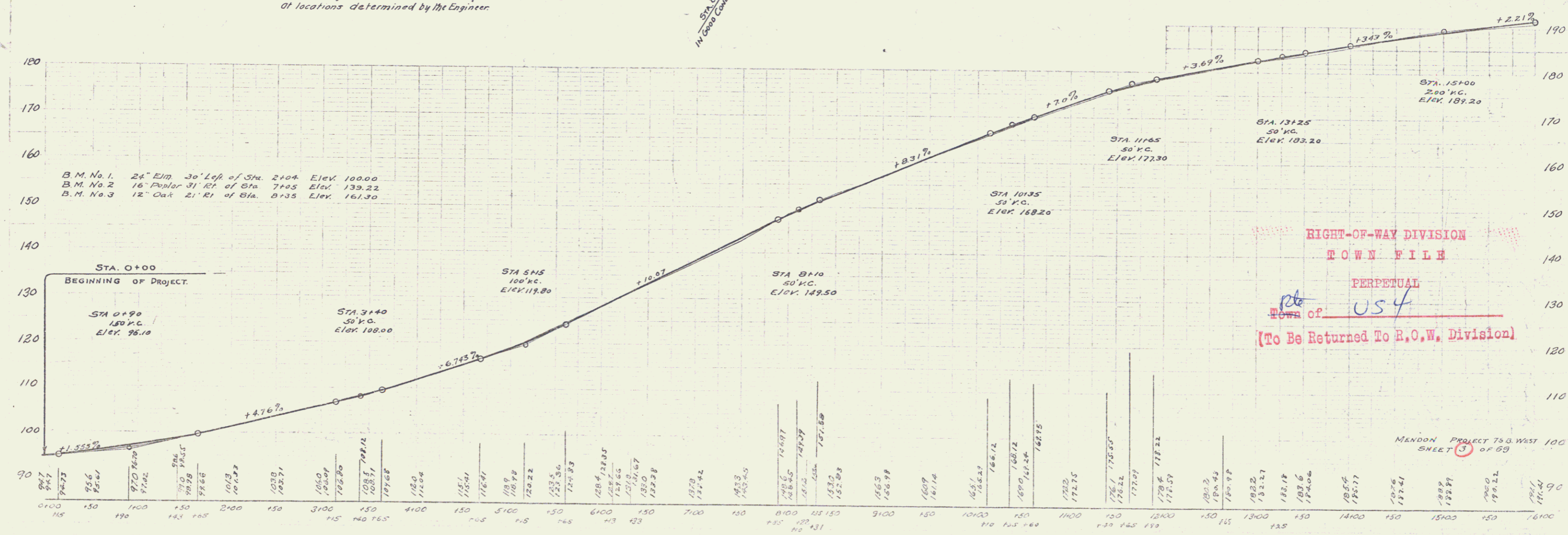

RIGHT-OF-WAY DIVISION  
 TOWN FILE  
 PERPETUAL  
 Town of US-4  
 (To Be Returned To R.O.W. Division)

MENDON PROJECT 75 & WEST 100  
 SHEET 3 OF 69