

**INDEX OF SHEETS**

SHEET NO.	TITLE PAGE
1	TYPICAL CROSS-SECTION OF IMPROVEMENT 4" BITUMINOUS CONCRETE PAVEMENT
2	BARRETTING AND WIDENING TABLES ITEM 361-B OR 342
3	QUANTITY SHEET (ITEMS)
4	QUANTITY SHEET (DRAINAGE)
5	EARTHWORK SHEETS
6-7	PLAN AND PROFILE SHEETS
8-13	CONSTRUCTION DETAILS CD (DRAINAGE AND MARKERS)
14	CONSTRUCTION DETAILS CD 2 (TYPICAL GRADING)
15	CONSTRUCTION DETAILS CD 4 (GRANITE CURBS)
16	STANDARD STRUCTURE SHEET S 40 (BARRICADES, SIGNS AND LIGHTS)
17	STANDARD STRUCTURE SHEET S 53-48 (PRECAST R.C.P. DROP INLET)
18-29	CROSS-SECTIONS

STANDARD STRUCTURE SHEET APPROVED BY THE CHIEF ENGINEER, VERMONT STATE DEPARTMENT OF HIGHWAYS  
S 40 / JUNE 10, 1950

**STATE OF VERMONT  
DEPARTMENT OF HIGHWAYS**

**PROPOSED IMPROVEMENT**

FEDERAL PROJECT  
**TOWN OF RUTLAND**  
COUNTY OF RUTLAND  
**U.S. ROUTE 4**  
RUTLAND-CASTLETON ROAD

Pin # 99R163

BEGINNING AT A POINT APPROXIMATELY 55 FEET WESTERLY OF THE INTERSECTION OF U.S. ROUTE 4 AND VERMONT ROUTE 3 IN CENTER RUTLAND AND EXTENDING EASTERLY 1,141.5 FEET TO THE RUTLAND TOWN-RUTLAND CITY LINE.

LENGTH OF PROJECT 1,141.5 FEET = 0.216 MILE

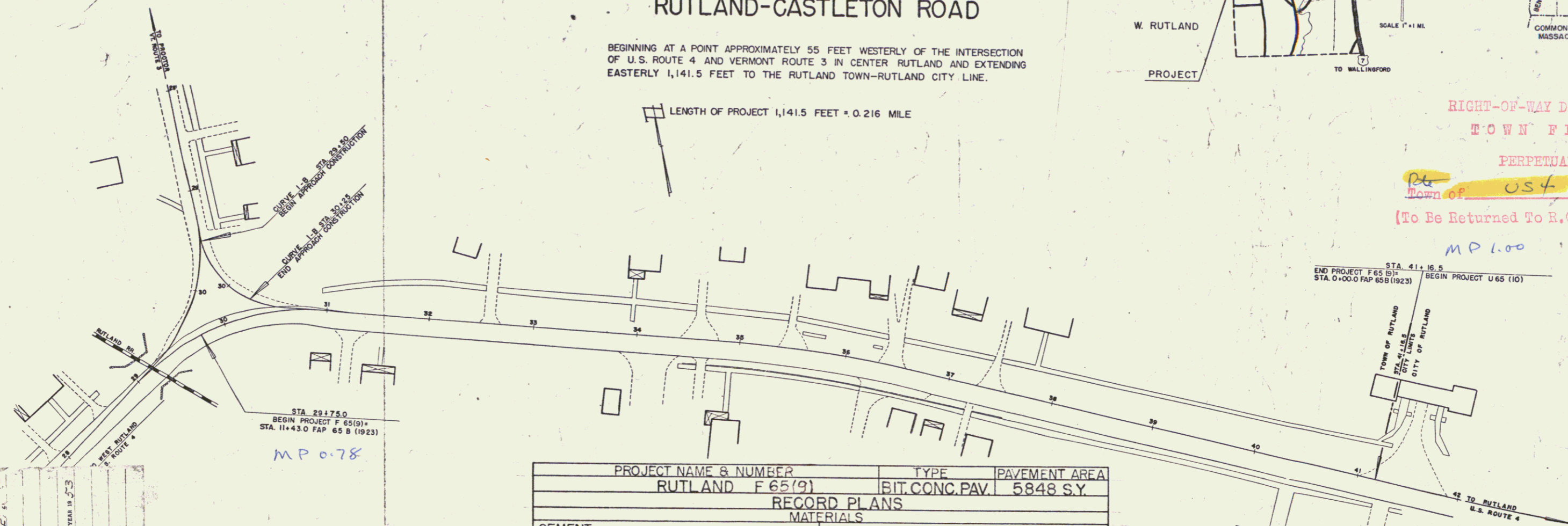
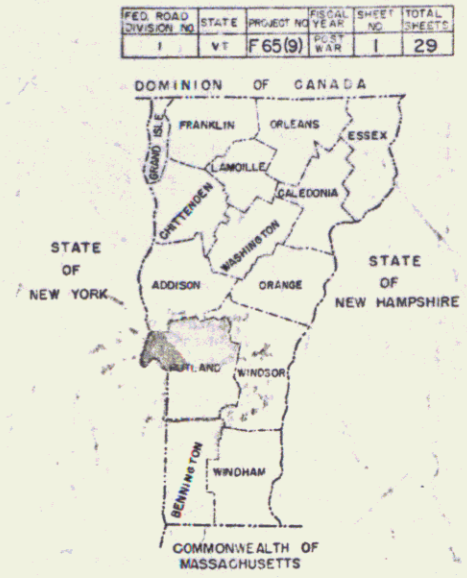
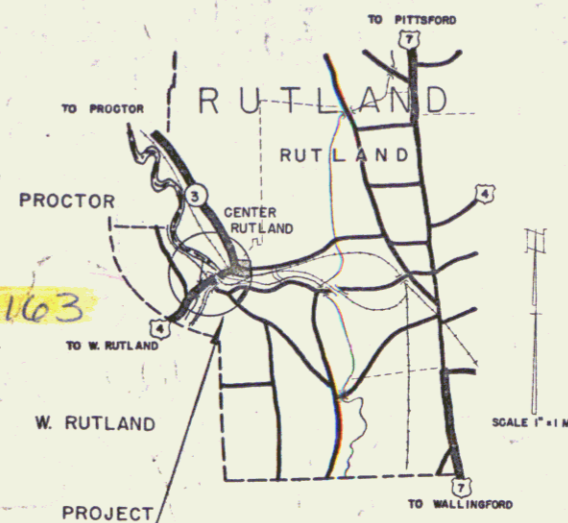

RIGHT-OF-WAY DIVISION  
TOWN FILE  
PERPETUAL  
Town of Rutland  
(To Be Returned To R.C.W. Division)

PROJECT: Rutland, Vt.  
TYPE: Bit. Conc. Pave.  
CONTRACTOR: Earle & Merry Inc.  
LOCATION: See title page

GROUND ELEVATION DATUM REF. LINE

GRADE ELEVATION DATUM REF. LINE

CURVE DATA

DEFLECTION OF ANGLE	Δ
DEGREE OF CURVE	D
RADIUS OF CURVE	R
TANGENT DISTANCE	T
LENGTH OF CURVE	L
EXTERNAL DISTANCE	E
POINT OF INTERSECTION	P.I.
POINT OF CURVE	P.C.
POINT OF TANGENT	P.T.
POINT ON TANGENT	P.O.T.
POINT ON SUB-TANGENT	P.O.S.T.

SCALES

TITLE	1" = 50'
TYPICAL	1" = 8 1/2'
PLAN	1" = 20'
PROFILE HORIZONTAL	1" = 20'
PROFILE VERTICAL	1" = 10'
CROSS-SECTIONS	1" = 6'

PROJECT NAME & NUMBER	RUTLAND F 65(9)	TYPE	BIT. CONC. PAV.	PAVEMENT AREA	5848 S.Y.
RECORD PLANS MATERIALS					
CEMENT	PORTLAND I. IRONCLAD 2. ATLAS	PERF. BIT. FIB. DR. PIPE	BROWN CO., BERLIN, N.H.		
CONCRETE AGGREGATE	R.D. BARKER, RUTLAND, VT.	GRAVEL	BURKE PIT, CASTLETON, VT.		
TAR	KOPPERS PROD. CO., EVERETT, MASS.	GRAVEL FOR SHOUL.	BURKE PIT, CASTLETON, VT.		
ASPHALT	(85-100) SOCONY VACUUM OIL CO., RIVERSIDE, RI.	BIT. CONC. PAVEMENT	BAYER & MINGOLLA PLANT, VT.		
R.C. PIPE	FEDERAL PIPE CO., GLENS FALLS, N.Y.	BIT. CONC. AGGREGATE	BAYER & MING. PIT, MENDON, VT.		
CONTRACTOR	EARL & MERRY INC., RUTLAND, VT.	CONTRACT DATED	2/24/53		
RES. ENGINEER	S.V. CLIFFORD	CONTRACT STARTED	3/27/53		
INSPECTOR		CONTRACT COMPLETED	10/27/53		
RECORD PLANS BY	S.V. CLIFFORD 2/1/54	CONTRACT ACCEPTED	10/27/53		

NOTE: ANY FURTHER INFORMATION CONCERNING FINAL QUANTITIES, AMOUNTS OR OTHER DETAILS RELATIVE TO THIS PROJECT MAY BE FOUND IN EITHER THE FIELD BOOKS OR THE ESTIMATE FILE.

DEPARTMENT OF COMMERCE  
BUREAU OF PUBLIC ROADS

RECOMMENDED FOR APPROVAL

DISTRICT ENGINEER DATE

APPROVED

DIVISION ENGINEER DATE

THESE PLANS ARE SUBJECT TO SUCH REVISIONS AS MAY BE REQUIRED BY THE BUREAU OF PUBLIC ROADS OR THE COMMISSIONER OF HIGHWAYS.

CONSTRUCTION IS TO BE CARRIED ON IN ACCORDANCE WITH THE PLANS AND THE STANDARD ROAD AND BRIDGE SPECIFICATIONS OF 1948, AS APPROVED JULY 25, 1949 BY THE BUREAU OF PUBLIC ROADS, INCLUDING ALL SUBSEQUENT APPROVED REVISIONS AND SUCH REVISED SPECIFICATIONS AND SPECIAL PROVISIONS AS ARE SUBMITTED WITH THE PLANS.

APPROVED: *S.V. Clifford* DISTRICT ENGINEER DATE: *June 16 1952*

APPROVED: *Earle & Merry* CONTRACTOR DATE: *June 17 1952*

APPROVED: *V. W. Haver* COUNTY ENGINEER DATE: *JUNE 12 1952*

APPROVED: *H. H. August* CHIEF ENGINEER DATE: *JUNE 18 1952*

PROJECT F NO. 65(9) SHEET 1 OF 29 SHEETS

PLAN  
 1/32  
 1-48  
 RUTLAND  
 SHEET 25 OF 25 SHEETS

PROFILE  
 1/32  
 1-48  
 RUTLAND  
 SHEET 25 OF 25 SHEETS

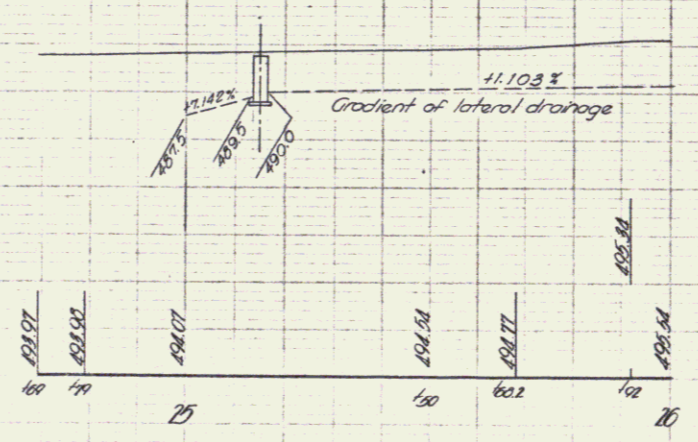
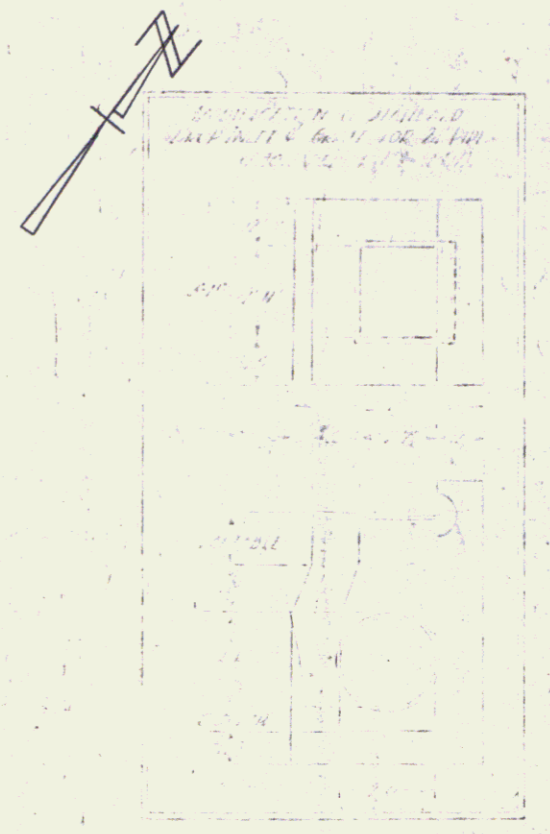
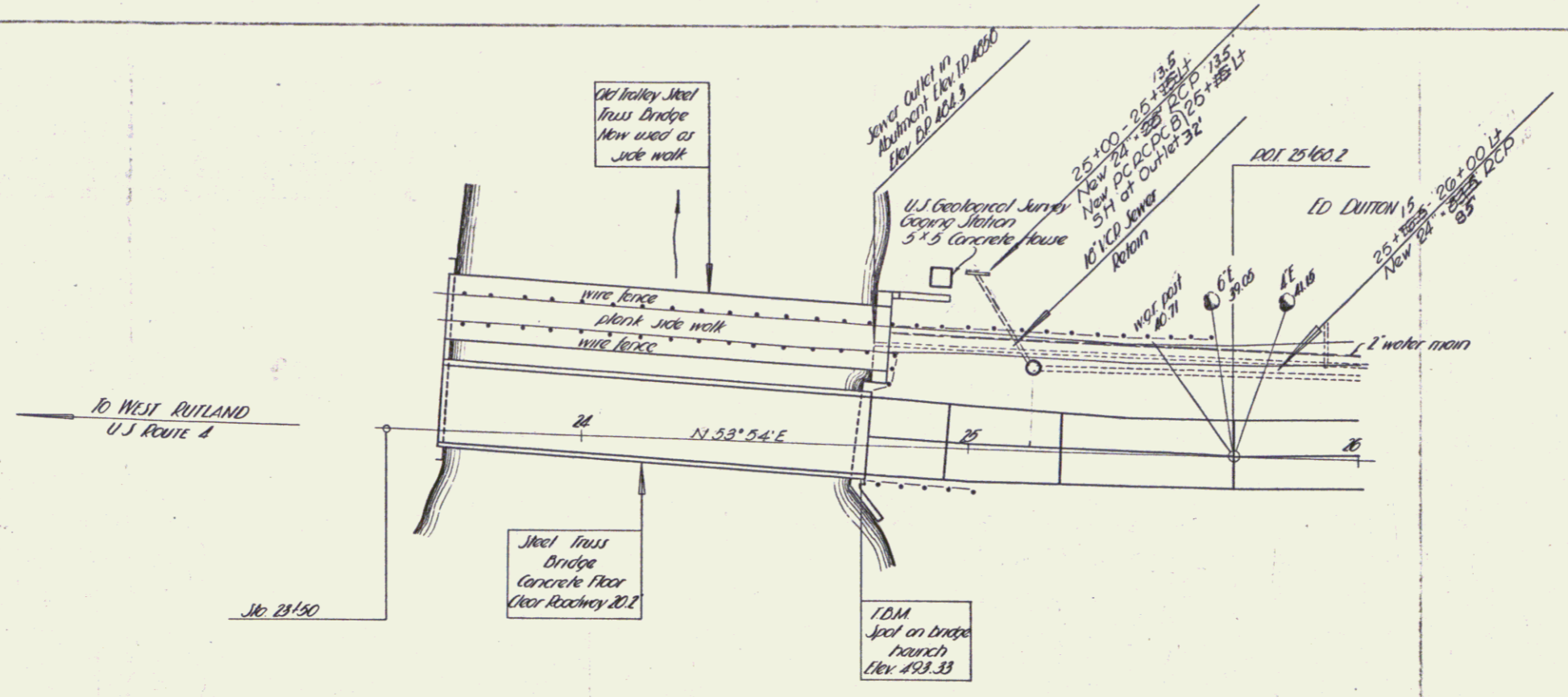

1 DM Jool on bridge haunch 9/11/21 of No. 21/72 Rev. 493-33

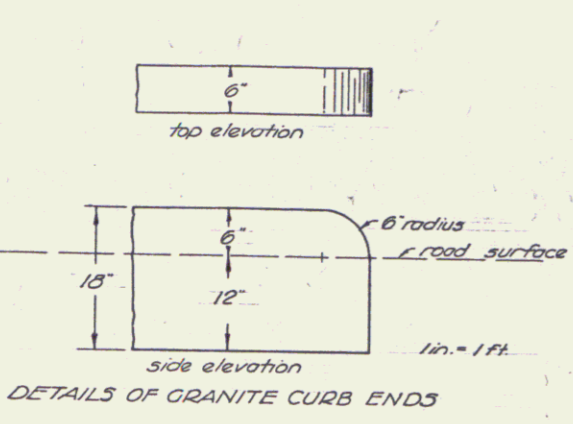
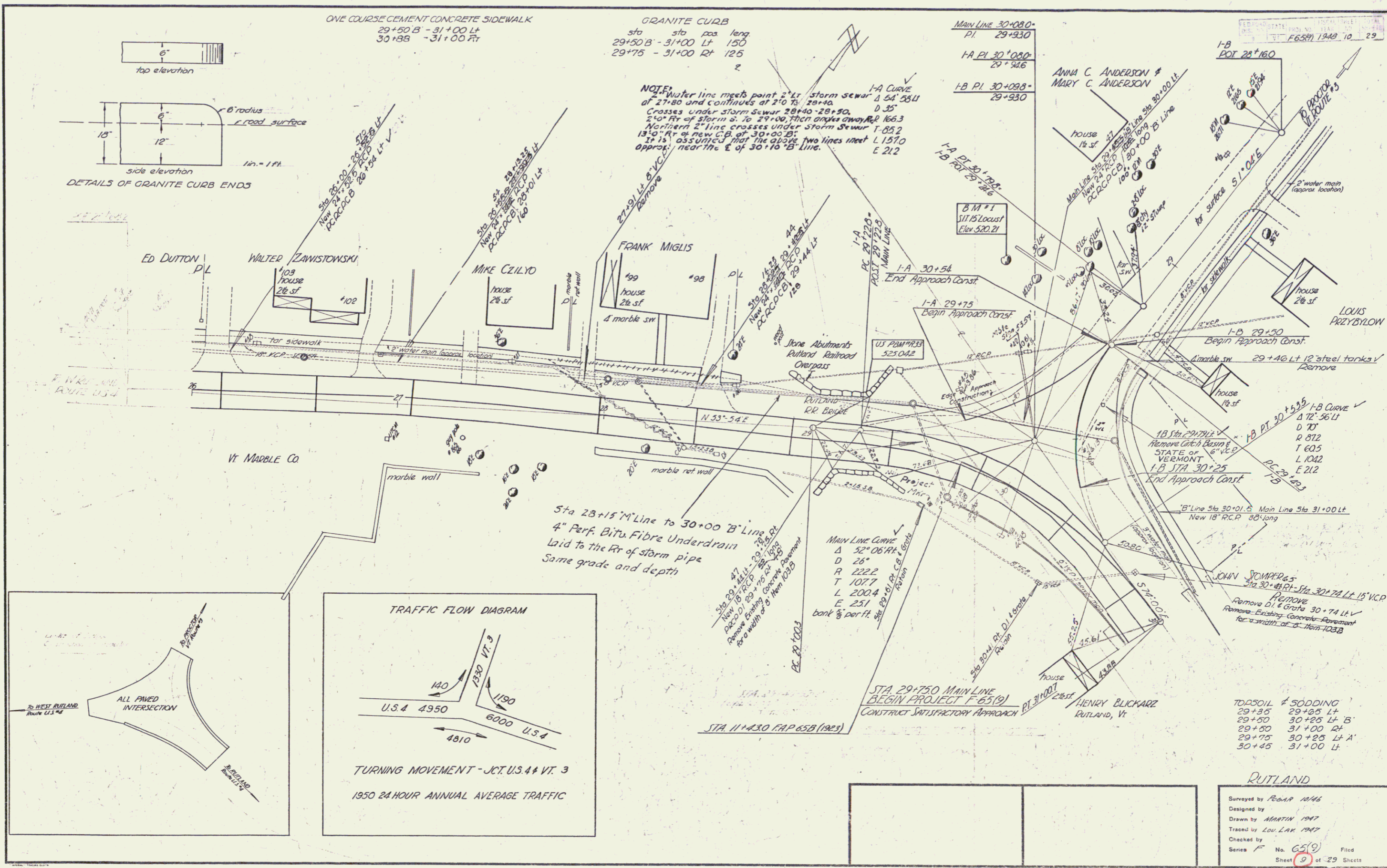

ONE COURSE CEMENT CONCRETE SIDEWALK  
 29+50 B' - 31+00 Lt  
 30+88 - 31+00 Rt

GRANITE CURB  
 sta sta pos leng  
 29+50 B' - 31+00 Lt 150  
 30+75 - 31+00 Rt 125

NOTE:  
 1" Water line meets point 2" Lt storm sewer L 54' 58" Lt  
 of 27+80 and continues at 27' to 28+40.  
 Crosses under storm sewer 28+40 - 28+90.  
 2'40" Rt of storm s. to 29+00. Then angles away R 166.3  
 Northern 2" line crosses under storm sewer T 85.2  
 13'9" Rt of new s.p. at 30+00 B'.  
 It is assumed that the above two lines meet  
 approx. near the E of 30+10 B' Line.  
 E 21.2

Main Line 30+080-  
 PI 29+930  
 I-A PI 30+080-  
 29+946  
 I-B PI 30+088-  
 29+930

PROJECT F-65(9) 1947 10 29

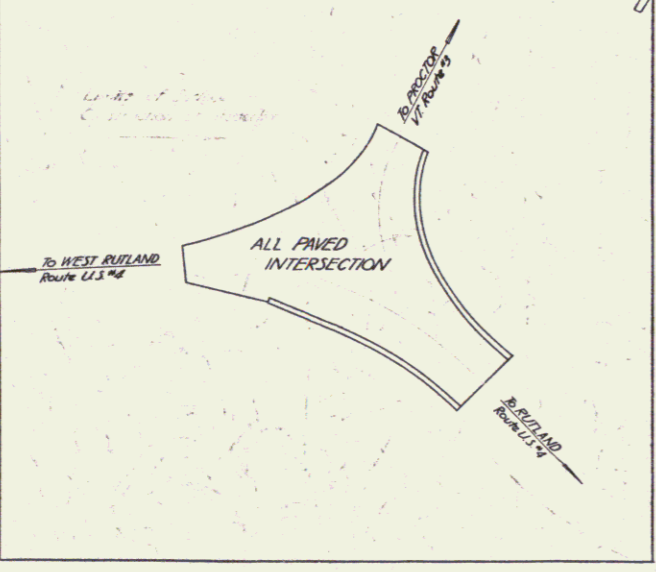
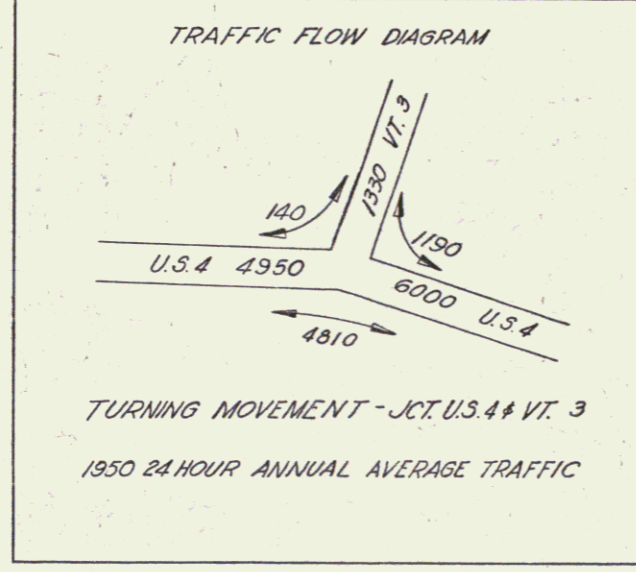

Main Line Curve  
 Δ 52° 06' 44"  
 D 26'  
 R 222.2  
 T 107.7  
 L 200.4  
 E 25.1  
 bank 1/2 per ft

TOPSOIL & SODDING

29+35	29+85 Lt
29+50	30+25 Lt B'
29+50	31+00 Rt A'
29+75	30+25 Lt A'
30+45	31+00 Lt

RUTLAND  
 Surveyed by *PEARL 1946*  
 Designed by  
 Drawn by *MARTIN 1947*  
 Traced by *LOU LARK 1947*  
 Checked by  
 Series F No. *65(9)* Filed  
 Sheet *9* of 29 Sheets

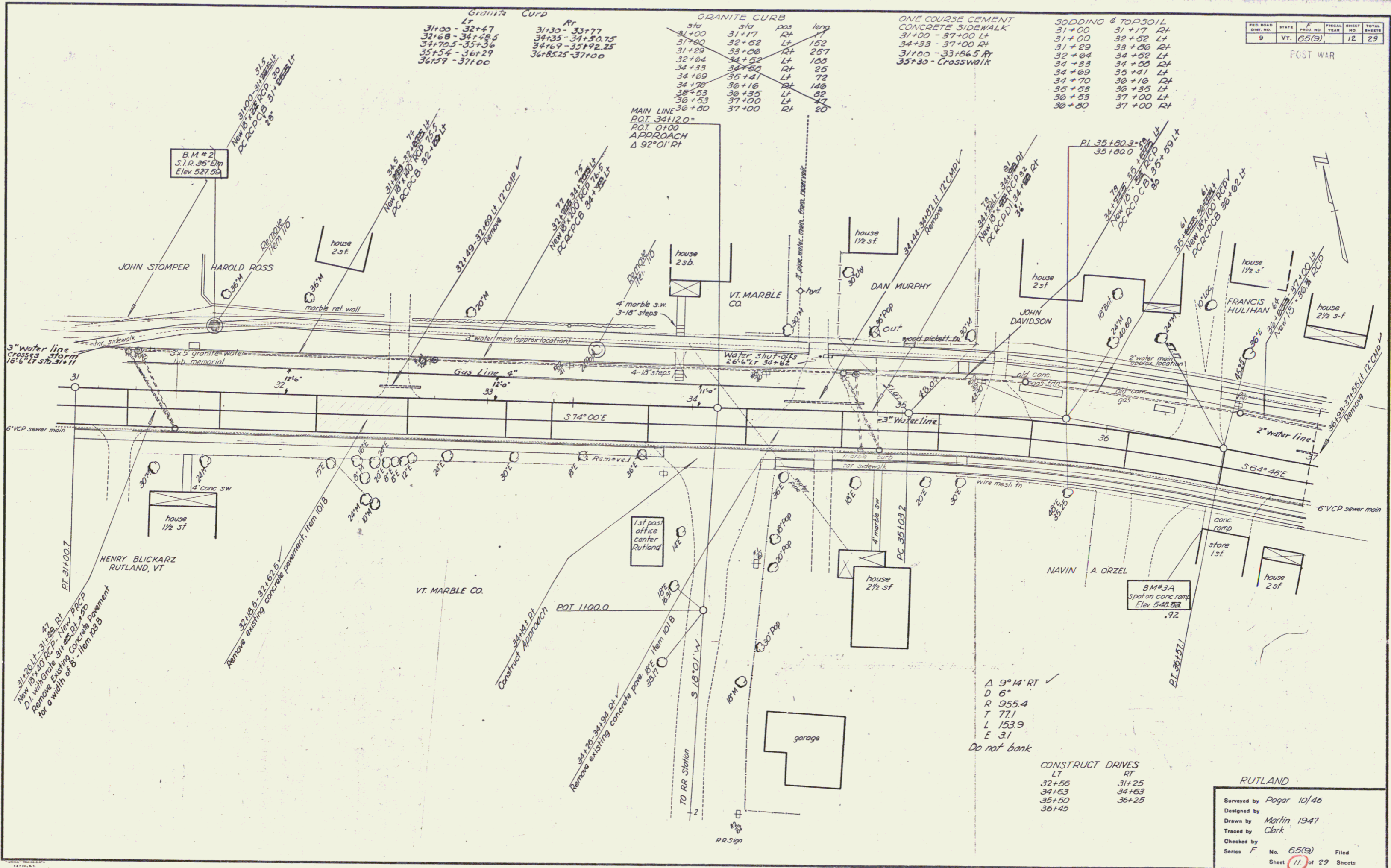

Granite Curb

Sta	Pos	Len
31+00	32+47	147
32+48	34+85	237
35+36	37+29	193
37+00	37+00	0

GRANITE CURB

Sta	Pos	Len
31+00	31+17	17
31+17	32+02	85
32+02	33+08	106
33+08	34+52	144
34+52	35+41	89
35+41	36+16	75
36+16	36+85	69
36+85	37+00	15

ONE COURSE CEMENT CONCRETE SIDEWALK

Sta	Pos	Len
31+00	37+00	700
34+33	37+00	267
31+00	33+86.5	713.5
35+30	Crosswalk	

SODDING & TOP SOIL

Sta	Pos	Len
31+00	31+17	17
31+17	32+02	85
32+02	33+08	106
33+08	34+52	144
34+52	35+41	89
35+41	36+16	75
36+16	36+85	69
36+85	37+00	15

FED. ROAD DIST. NO.	STATE	F. PROJ. NO.	FISCAL YEAR	SHEET NO.	TOTAL SHEETS
9	Vt.	65(9)		12	29

RUTLAND

$\Delta$  9°14' RT ✓  
 D 6"  
 R 955.4  
 T 771  
 L 153.9  
 E 31  
 Do not bank

CONSTRUCT DRIVES

LT	RT
32+56	31+25
34+63	34+63
35+00	36+25
36+45	

RUTLAND

Surveyed by Pogor 10/46  
 Designed by  
 Drawn by Martin 1947  
 Traced by Clerk  
 Checked by  
 Series F No. 65(9) Filed  
 Sheet 11 of 29 Sheets

