

NEW CULVERTS REQUIRED
 Sta 19+75 24" Conc. Pipe 45ft
 1-2 1/2" Conc. 3.5 Cuyds.
 1 Grate 2'-6" x 2'-6"

GUARD RAIL REQUIRED
 On Left
 Sta 16+15 to Sta 16+31 Length 16ft
 " 17+56 " " 18+44 " 88 "
 On Right
 Sta 16+15 to Sta 18+31 Length 16ft
 " 17+56 " " 17+72 " 16 "
 Total this sheet 136 ft

DATE: 11/26/23
 DRAWN BY: [Signature]
 CHECKED BY: [Signature]

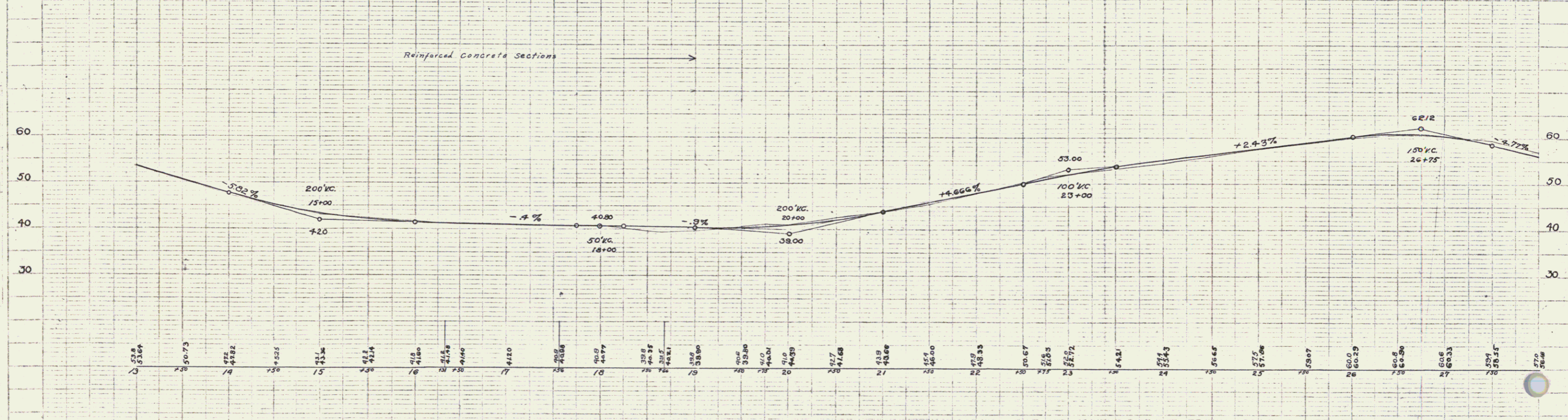
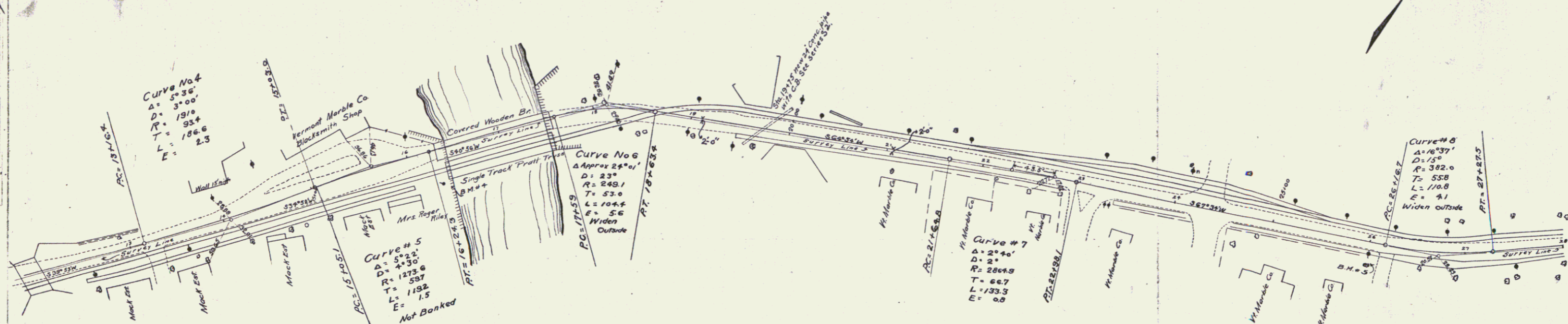

B.M. A N.E. corner of Easterly Trolley Abutment Right of Sta. 16+36 Elev. 40.07
 B.M. S Spike in 20" Twin Elm Right of Sta. 26+00 Elev. 61.52

A.T. Reynolds
 G.N. Clark
 11/26/23

A.T. Reynolds
 G.N. Clark
 11/26/23

Handwritten note: Vermont - Portland

3