

Sta. 10+46 Relay Pipe and Catch Basin.

63A 1023 1-23

1/23  
A. J. Reynolds  
G. H. Cook

5/23  
A. J. Reynolds  
G. H. Cook

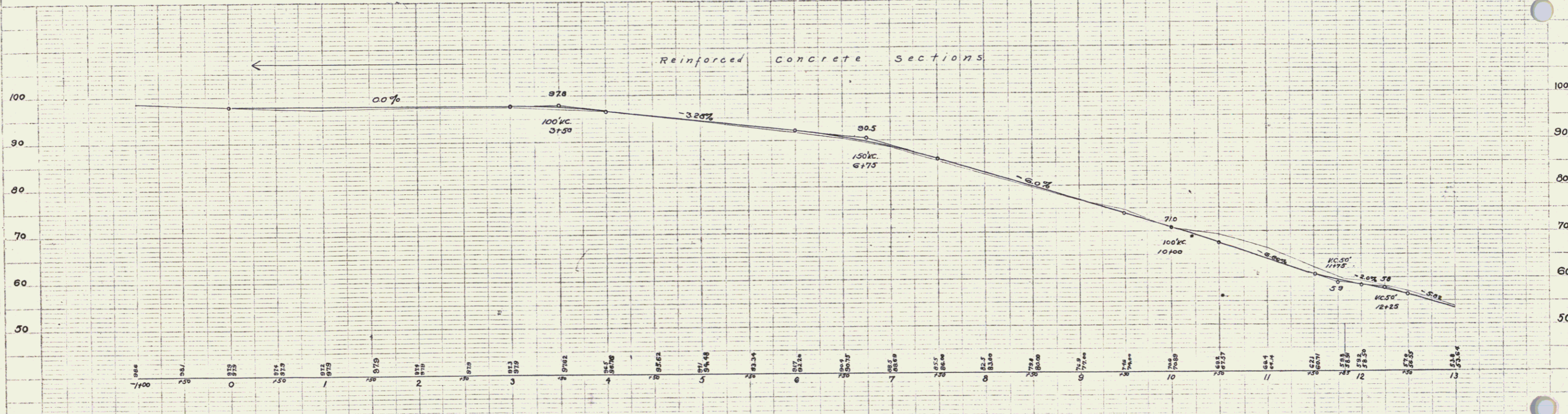
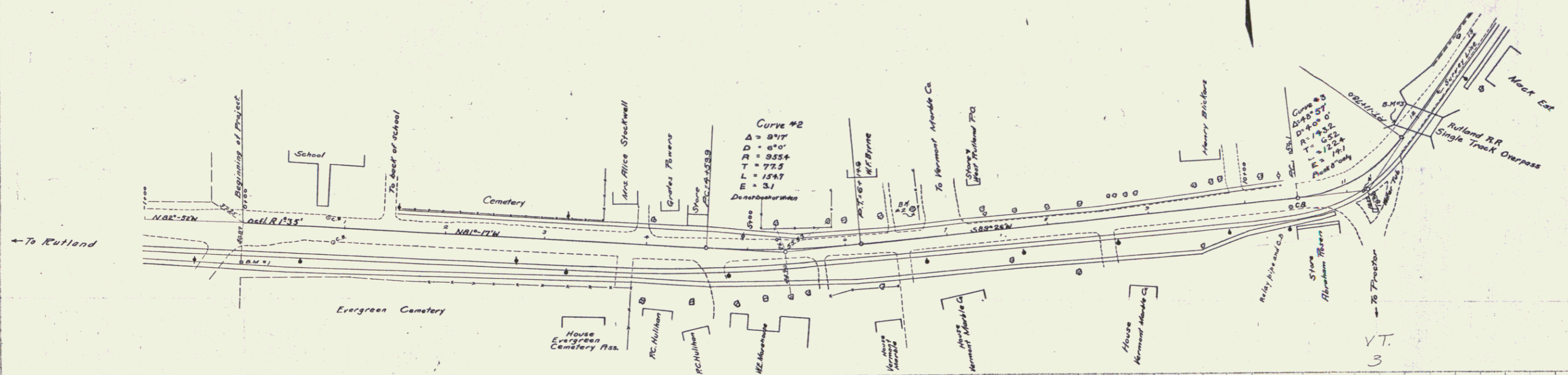

B.M. #1 Top Marble Post as City Line Post, Right of Sta. 0+00 Elev. 100.  
 B.M. #2 Spike in 24" Elm. Left of Sta. 6+71 Elev. 51.52  
 B.M. #3 Abutment Stone on South Abutment of Underpass Left of Sta. 11+81 Elev. 62.93

Sheet # 23  
 Series F. Newfield