

INDEX OF SHEETS

SHEET NO. 1	TITLE PAGE
2	TYPICAL CROSS-SECTION OF IMPROVEMENT
3	BANKING AND WIDENING TABLES
4-5	PLAN AND PROFILE
6	STANDARD STRUCTURE SHEET S-30 CABLE GUARD RAIL
7	S-30A BOUNDARY MARKERS
8	S-40 BARRICADES, SIGNS & LIGHTS
9-14	CROSS SECTIONS

STANDARD STRUCTURE SHEETS APPROVED BY THE CHIEF ENGINEER VERMONT STATE DEPARTMENT OF HIGHWAYS

S 30 NOV. 10, 1947
 S 30A APRIL 19, 1941
 S 40 DEC. 18, 1945

STATE OF VERMONT
 STATE HIGHWAY DEPARTMENT

PLAN AND PROFILE OF PROPOSED
 STATE HIGHWAY

FEDERAL PROJECT

TOWN OF GUILDHALL Pin# 99R159

ROUTE U. S. 2

LANCASTER N. H. — LUNENBERG VT. ROAD
 BEGINNING AT THE N. H. — VT. STATE LINE AND
 EXTENDING WESTERLY AND SOUTHERLY 0.110 MILES
 LENGTH OF BRIDGE 82.25 FT. = 0.016 MILES
 LENGTH OF ROADWAY 497.75 FT. = 0.094 MILES
 LENGTH OF PROJECT (VT. PORTION) 580.00 FT. = 0.110 MILES

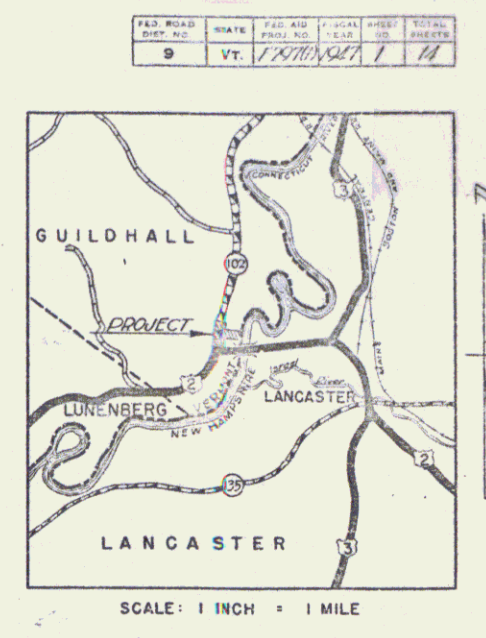

RIGHT-OF-WAY DIVISION
 TOWN FILE
 PERPETUAL
 Town of US 2
 (To Be Returned To R.O.W. Division)

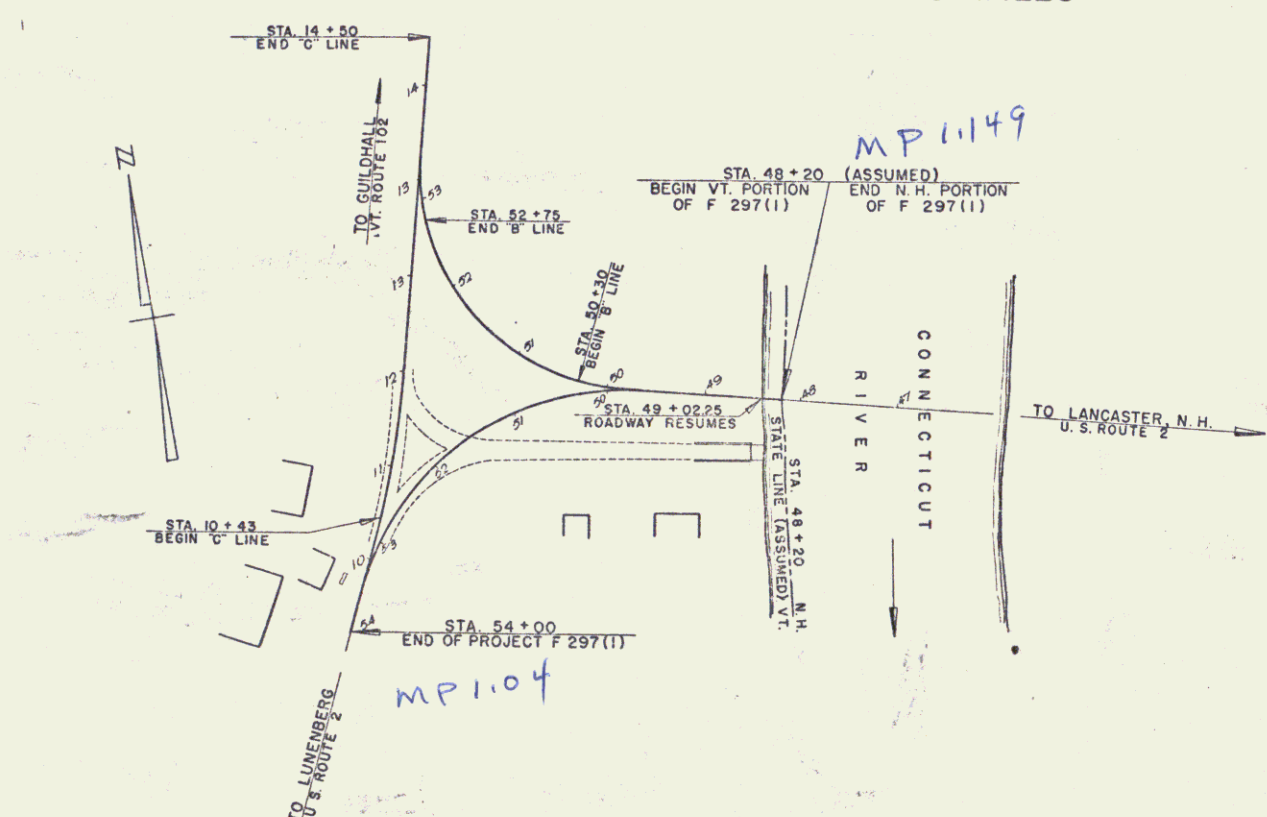

- COUNTY LINE
- TOWN LINE
- FENCE LINE
- STONE WALL
- UNFENCED PROPERTY
- GUARD RAIL
- TRAVELED WAY
- RAILROAD
- RETAINING WALL
- CENTER LINE
- SURVEY LINE
- CULVERT
- DROP INLET
- TROLLEY POLE
- POWER POLE
- TELEPHONE POLE
- TREES
- HEDGE

- GROUND ELEVATION
 - GRADE ELEVATION
- CURVE DATA
- DEFLECTION ANGLE
 - DEGREE OF CURVE
 - RADIUS OF CURVE
 - TANGENT DISTANCE
 - LENGTH OF CURVE
 - EXTERNAL DISTANCE
 - POINT OF INTERSECTION
 - POINT OF CURVE
 - POINT OF TANGENT
 - POINT ON TANGENT

SCALES

TITLE	1" = 100'
TYPICAL	1" = 2'
PLAN	1" = 50'
PROFILE HORIZONTAL	1" = 10'
PROFILE VERTICAL	1" = 10'
CROSS SECTIONS	1" = 5'

THESE PLANS ARE SUBJECT TO SUCH REVISIONS AS MAY BE REQUIRED BY THE PUBLIC ROADS ADMINISTRATION OR THE COMMISSIONER OF HIGHWAYS.

CONSTRUCTION IS TO BE CARRIED ON IN ACCORDANCE WITH THE PLANS AND THE STANDARD ROAD AND BRIDGE SPECIFICATIONS OF 1936, AS APPROVED DECEMBER 29TH, 1936 BY THE PUBLIC ROADS ADMINISTRATION, INCLUDING ALL SUBSEQUENT APPROVED REVISIONS AND SUCH REVISED SPECIFICATIONS AND SPECIAL PROVISIONS AS ARE SUBMITTED WITH THE PLANS.

APPROVED: _____
 HIGHWAY ENGINEER

APPROVED: _____
 DISTRICT HIGHWAY COMMISSIONER

RECOMMENDED FOR APPROVAL

APPROVED

Project # _____
 SERIES F NO. 100 FILED
 SHEET (1) OF 11

Drawer 16