

STATE OF VERMONT  
DEPARTMENT OF HIGHWAYS

PROPOSED IMPROVEMENT

TOWN OF LUNENBURG  
COUNTY OF ESSEX  
U.S. ROUTE 2  
LUNENBURG-GUILDHALL ROAD

Pin# 99R158

BEGINNING AT A POINT 6.790 MILES NORTHEASTERLY OF THE  
CONCORD-LUNENBURG TOWN LINE AND EXTENDING NORTHEASTERLY  
0.303 MILE.

LENGTH OF ROADWAY FEET = MILE  
LENGTH OF BRIDGE FEET = MILE  
LENGTH OF PROJECT 1,600.0 FEET = 0.303 MILE

ADT 1967 1500  
ADT 1987 2400  
DHV 1987 425  
D 52  
T 8 %  
V 50 MPH

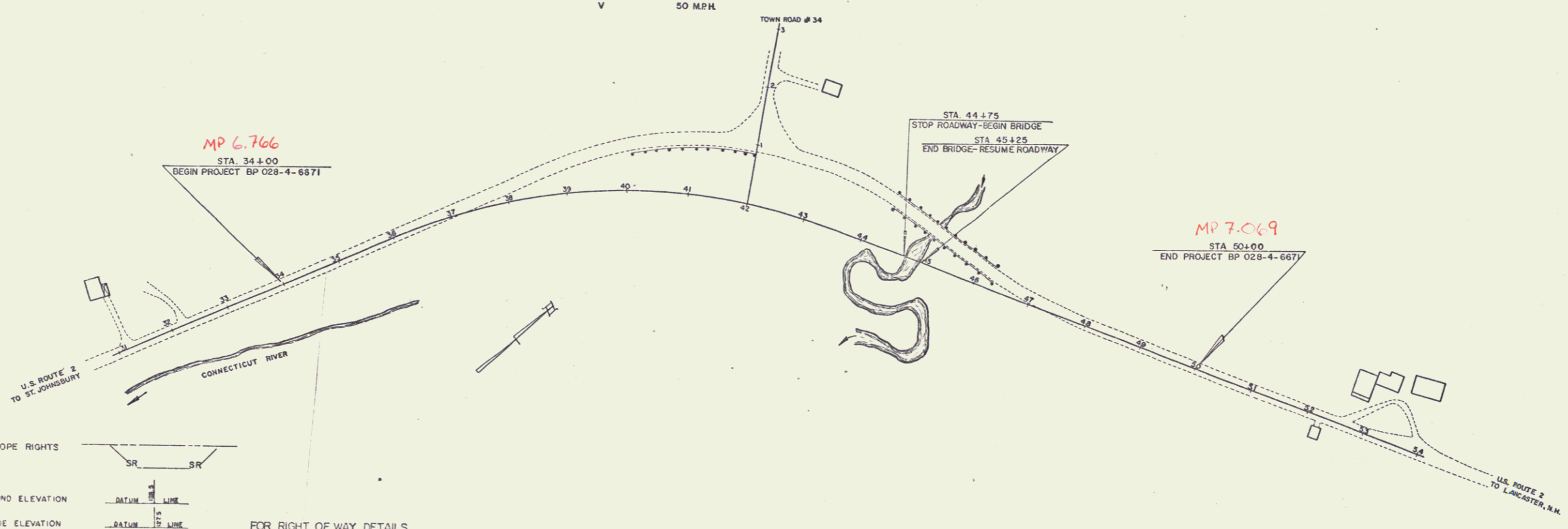
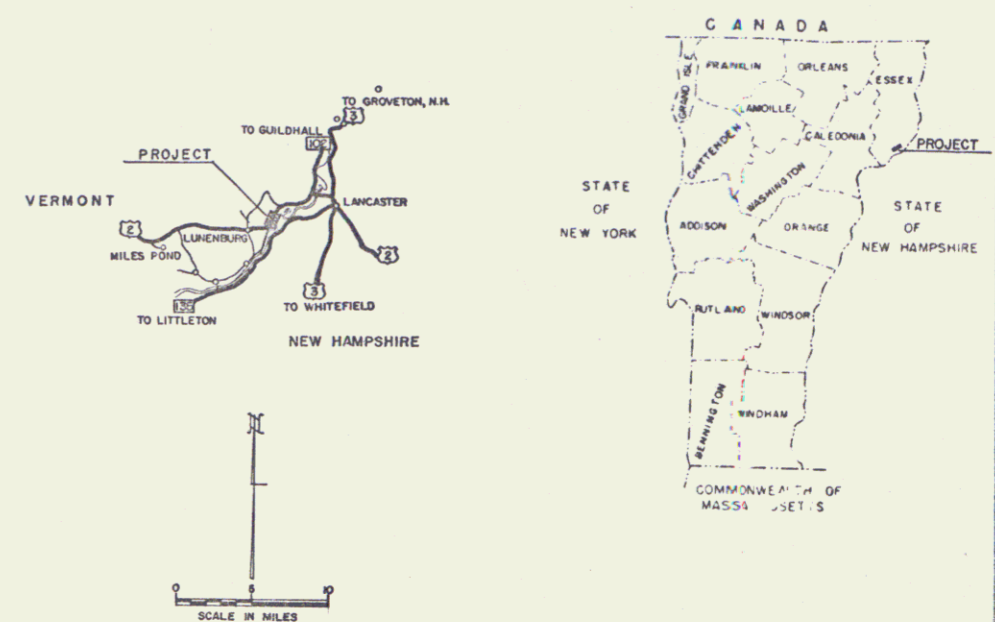

- CONVENTIONAL SIGNS
- POINT OF ACCESS
  - LIMITS OF ACCESS
  - COUNTY LINE
  - TOWN LINE
  - FENCE LINE
  - STONE WALL
  - UNFENCED PROPERTY
  - GUARD RAIL
  - TRAVELED WAY
  - RAILROAD
  - RETAINING WALL
  - CENTER LINE
  - SURVEY LINE
  - CULVERT
  - DROP INLET
  - TROLLEY POLE
  - POWER POLE
  - TELEPHONE POLE
  - TREES
  - MESH
  - P.A. CONSTRUCTION IDENTIFICATION SIGNS
- LUNENBURG BP 028-4-6671  
CONSTRUCTED BY DISTRICT ENGINEERS  
FORCES

- SLOPE RIGHTS
- GROUND ELEVATION
- GRADE ELEVATION
- CURVE DATA
- DEFLECTION OF ANGLE
  - DEGREE OF CURVE
  - RADIUS OF CURVE
  - TANGENT DISTANCE
  - LENGTH OF CURVE
  - EXTERNAL DISTANCE
  - POINT OF INTERSECTION
  - POINT OF CURVE
  - POINT OF TANGENT
  - POINT ON TANGENT
  - POINT ON SUB-TANGENT
  - ROAD MARKS

FOR RIGHT OF WAY DETAILS,  
SEE RIGHT OF WAY PLANS FOR THIS PROJECT.

THESE PLANS ARE SUBJECT TO SUCH REVISIONS AS MAY BE  
REQUIRED BY THE BUREAU OF PUBLIC ROADS OR THE COMMISSIONER  
OF HIGHWAYS.

CONSTRUCTION IS TO BE CARRIED ON IN ACCORDANCE WITH  
THESE PLANS AND THE STANDARD SPECIFICATIONS FOR HIGHWAY AND BRIDGE  
CONSTRUCTION DATED APRIL, 1954, AS APPROVED BY THE BUREAU OF  
PUBLIC ROADS ON OCTOBER 12, 1964, INCLUDING ALL SUBSEQUENT  
APPROVED REVISIONS AND SUCH REVISED SPECIFICATIONS AND SPECIAL  
PROVISIONS AS ARE INCORPORATED IN THESE PLANS.

DEPARTMENT OF COMMERCE  
BUREAU OF PUBLIC ROADS

APPROVED

DIVISION ENGINEER DATE

PROJECT BP NO. 028-4-6671

SHEET 1 OF SHEETS

APPROVED *[Signature]* DISTRICT ENGINEER DATE 3/27/67

APPROVED *[Signature]* DISTRICT ENGINEER DATE 3/27/67

APPROVED *[Signature]* DISTRICT ENGINEER DATE 3/27/67

APPROVED *[Signature]* BRIDGE ENGINEER DATE 3/29/67

APPROVED *[Signature]* HIGHWAY ENGINEER DATE 3/27/67

APPROVED *[Signature]* ASSIST. CHIEF ENGINEER DATE 4/19/67

APPROVED *[Signature]* CHIEF ENGINEER DATE 4/19/67