

INDEX OF SHEETS

SHEET NO.	TITLE PAGE
2	TYPICAL CROSS-SECTION OF IMPROVEMENT
3	PLAN AND PROFILE STA. 0+00 TO STA. 14+00
4	" " " " 14+00 " " 29+00
5	" " " " 29+00 " " 44+00
6	" " " " 44+00 " " 59+00
7	" " " " 59+00 " " 74+00
8	" " " " 74+00 " " 89+00
9	" " " " 89+00 " " 104+25
10	BRIDGE STA. 0+37-0+62
11 To 19	CROSS SECTIONS

FED. ROAD DIST. NO.	STATE	FED. AID PROJ. NO.	FISCAL YEAR	SHEET NO.	TOTAL SHEETS
2	VT.	30	1921	7	19

STATE OF VERMONT
 STATE HIGHWAY DEPARTMENT
 PLAN AND PROFILE OF PROPOSED
 STATE HIGHWAY
 FEDERAL AID PROJECT
 TOWN OF LUNENBURG *Pin # 99R156*
 NEW ROAD
 WEST NEIGHBORHOOD FOUR CORNERS TO E. CONCORD TURN

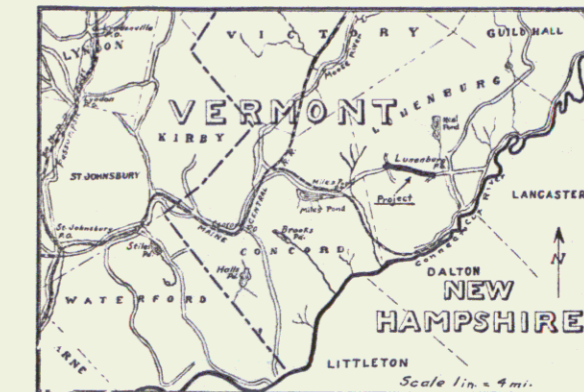

SCALES { PLAN 1 IN = 50 FT
 PROFILE HOR. 1 IN = 50 FT VERT. 1 IN = 10 FT
 CROSS-SECTIONS 1 IN = 5 FT

Project No F 30

RIGHT-OF-WAY DIVISION
 TOWN FILE
 PERPETUAL
Rte
 DEPT. OF US 2
 (To Be Returned To R.O.W. Division)

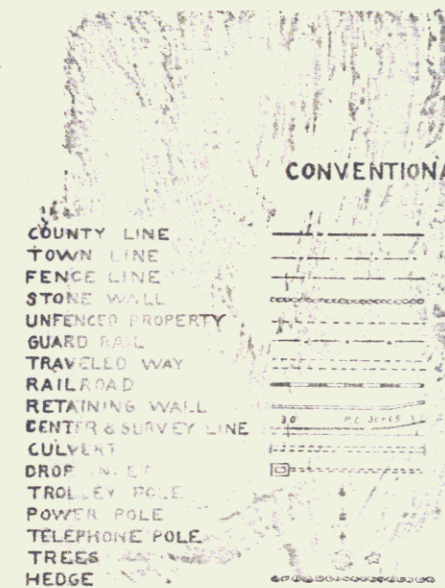
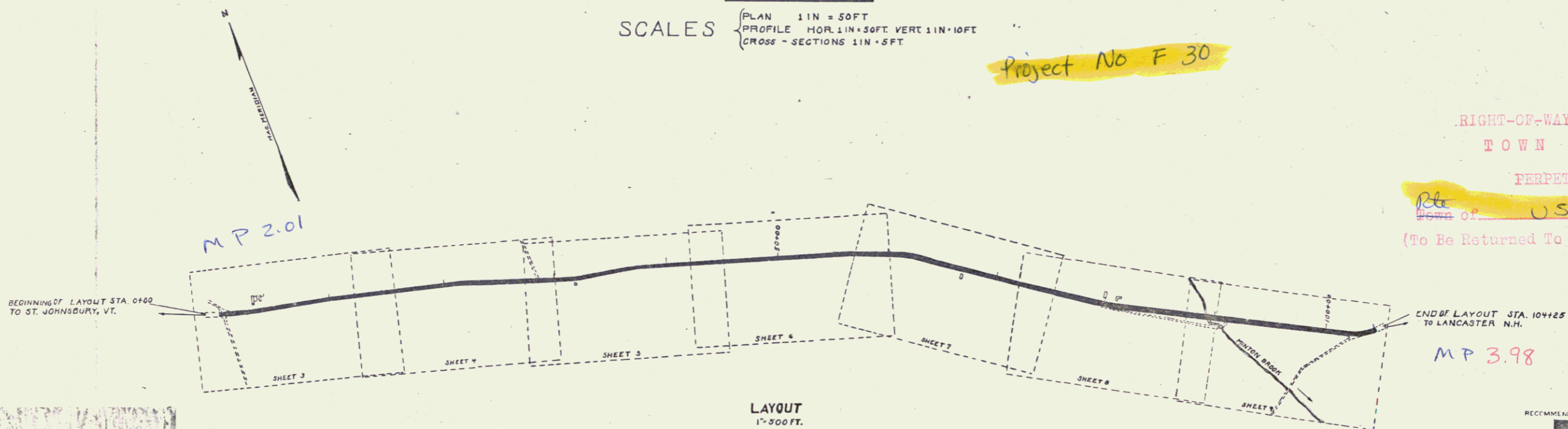

CONVENTIONAL SIGNS

COUNTY LINE	GROUND ELEVATION	DEFLECTION ANGLE	Δ
TOWN LINE	GRADE ELEVATION	DEGREE OF CURVE	D.
FENCE LINE		RADIUS OF CURVE	R.
STONE WALL		TANGENT DISTANCE	T.
UNFENCED PROPERTY		LENGTH OF CURVE	L.
GUARD RAIL		EXTERNAL DISTANCE	E.
TRAVELLED WAY		POINT OF INTERSECTION	P. I.
RAILROAD		POINT OF CURVE	P. C.
RETAINING WALL		POINT OF TANGENT	P. T.
CENTER & SURVEY LINE			
CULVERT			
DROP IN ELEV.			
TROLLEY POLE			
POWER POLE			
TELEPHONE POLE			
TREES			
HEDGE			

RECOMMENDED _____
 STATE ENGINEER
 APPROVED _____
 GOVERNOR
 SUBMITTED BY ORDER OF THE STATE HIGHWAY BOARD
 COMMISSIONER OF HIGHWAYS
 RECOMMENDED _____
 DISTRICT ENGINEER
 BUREAU OF PUBLIC ROADS
 RECOMMENDED FOR APPROVAL _____
 CHIEF ENGINEER - BUREAU OF PUBLIC ROADS
 APPROVED _____
 DIRECTOR - BUREAU OF PUBLIC ROADS

01/01/21

Series F No 30 Filed
 Sheet 7 of 19