

DRIVES  
 LT. RT.  
 309+00 30E-65

Three Cable Guard Rail With Steel Posts  
 Item - 543  
 STA. 296+00 to 304+77.84

MUCK EXCAVATION  
 STA. 303+50 - 305+50

FED. ROAD DISTRICT NO.	STATE	PROJECT NO.	FISCAL YEAR	SHEET NO.	TOTAL SHEETS
1	VT	F-028-401	19	2	2

PLAN  
 MOORE  
 N. M.  
 DATE: 10/1/58  
 DRAWN BY: J. SEN  
 CHECKED BY: W. J. SEN  
 IN CHARGE

PROFILE  
 MOORE  
 N. M.  
 DATE: 10/1/58  
 DRAWN BY: J. SEN  
 CHECKED BY: W. J. SEN  
 IN CHARGE

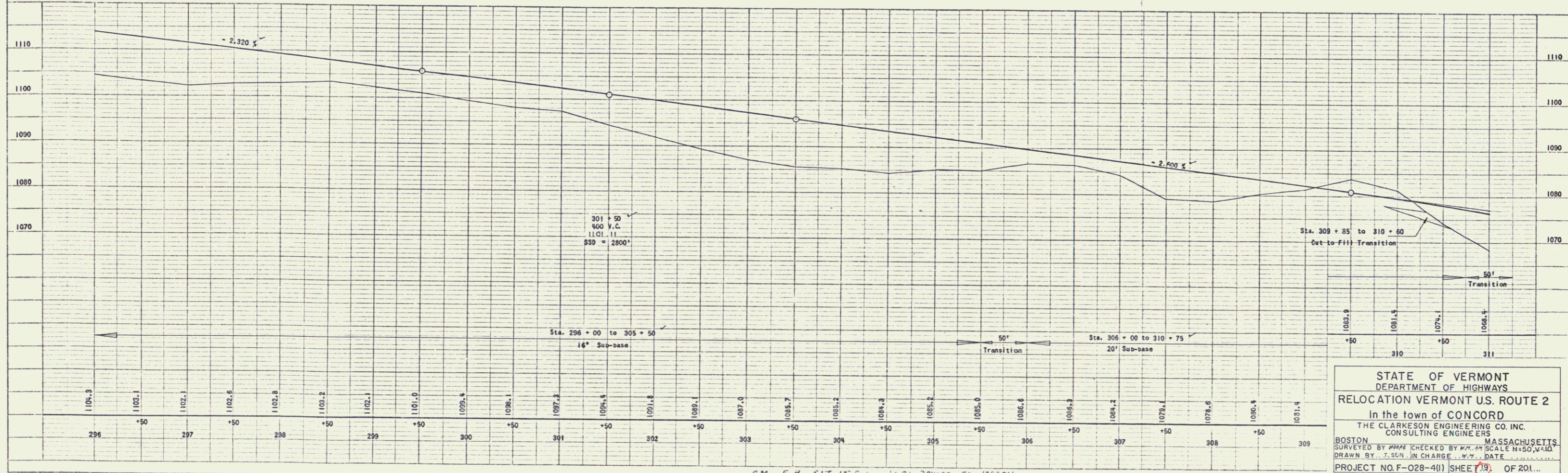
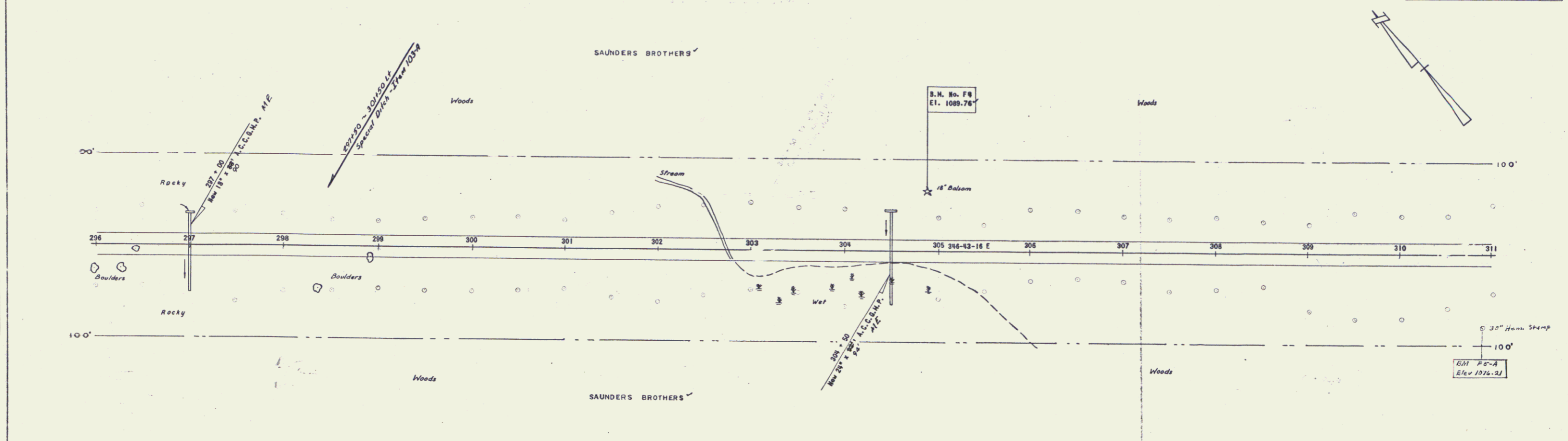

STATE OF VERMONT  
 DEPARTMENT OF HIGHWAYS  
 RELOCATION VERMONT U.S. ROUTE 2  
 In the town of CONCORD  
 THE CLARKESON ENGINEERING CO. INC.  
 CONSULTING ENGINEERS  
 BOSTON MASSACHUSETTS  
 SURVEYED BY W. J. SEN CHECKED BY W. J. SEN SCALE H=50, V=10  
 DRAWN BY J. SEN IN CHARGE W. J. SEN DATE 10/1/58  
 PROJECT NO. F-028-401 (SHEET 2) OF 201...

B.M. F. 8 SIT 13' Balcon Lt Sta 304+95 El. 1089.74  
 B.M. F. 8 SIT 18' Hem. 80' Rt Sta 310+90 El. 1076.21

11