

PART OF THE SAME LAND AND PREMISES ACQUIRED BY THE STATE OF VERMONT FROM LILLIAN C. HASTINGS BY WARRANTY DEED DATED JUNE 26, 1941 AND RECORDED IN BOOK 30 PAGE 72 OF THE CONCORD LAND RECORDS.

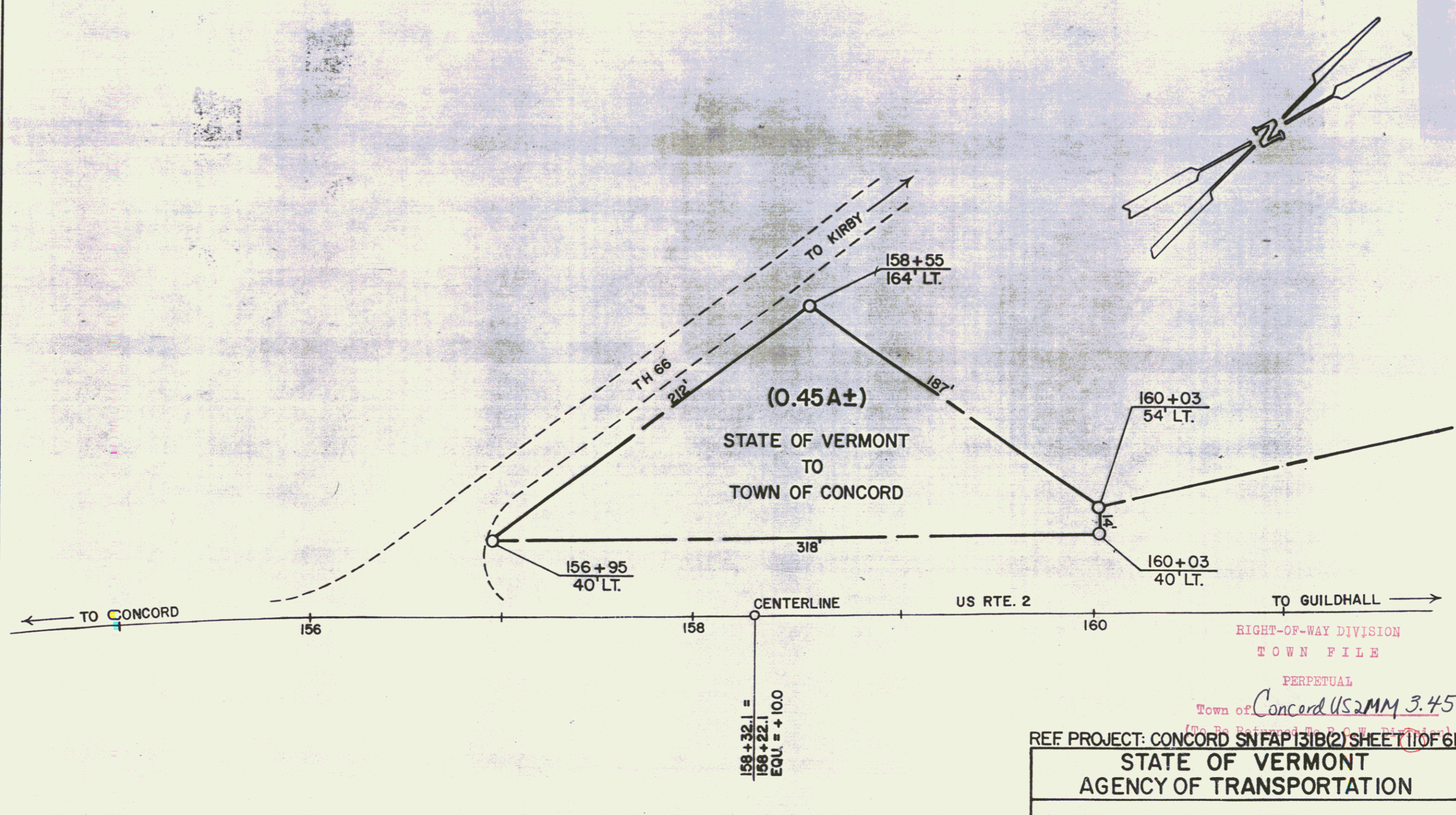

RIGHT-OF-WAY DIVISION  
TOWN FILE  
PERPETUAL  
Town of Concord US 2 MM 3.45  
(To Be Returned To P.C.W. Division)

REF PROJECT: CONCORD SN FAP 131B(2) SHEET 11 OF 61

STATE OF VERMONT  
AGENCY OF TRANSPORTATION

TOWN OF CONCORD (11A)

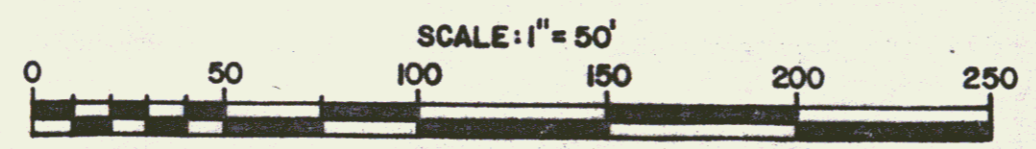

APPROX. SCALE 1" = 50' DATE 10-5-84 DRAWN BY D.E.M.