

INDEX OF SHEETS

- SHEET NO. 1 TITLE PAGE
- " 2-4 TYPICAL CROSS-SECTION OF IMPROVEMENT  $\left\{ \begin{array}{l} 2\frac{1}{2}'' \text{ CRUSHED GRAVEL MIXED IN PLACE SURFACE COURSE WITH} \\ \text{REFINED TAR ITEMS 25 \& 30} \end{array} \right.$
- " 5 BANKING AND WIDENING TABLES
- " 6-14 PLAN AND PROFILE
- " 15 PIPE CULVERTS S-28
- " 16 GUARD RAIL S-30
- " 17 STANDARD UNDERDRAIN S30A
- " 18 BARRICADES, SIGNS, LIGHTS (ROAD) S40
- " 19 TYPICAL GRADING CROSS SECTIONS S41
- " 20 BARRICADES, SIGNS, LIGHTS (BRIDGE) SB11
- " 21-22 CULVERT DETAILS
- " 23-61 CROSS SECTIONS

STANDARD STRUCTURE SHEETS APPROVED BY THE CHIEF ENGINEER

- S-28 4-26-41
- S-30 5-12-41
- S-30A 4-19-41
- S-40 9-5-40

STATE OF VERMONT  
STATE HIGHWAY DEPARTMENT

PLAN AND PROFILE OF PROPOSED  
STATE HIGHWAY

FEDERAL AID PROJECT

TOWN OF CONCORD

ROUTE U.S. 2

BEGINNING AT THE EASTERN END OF FEDERAL AID PROJECT 31 (1923) AND EXTENDING NORTHEASTERLY 1.643 MILES TO THE SOUTHERN END OF CONCRETE T BEAM BRIDGE OVER THE MOOSE RIVER  
LENGTH OF PROJECT 8679.8 FEET=1.643 MILES

Project No SNFAP 131B(2)

FED. ROAD DIST. NO.	STATE	FED. AID PROJ. NO.	FISCAL YEAR	SHEET NO.	TOTAL SHEETS
9	Vt.	131 B(2)	1942	1	61

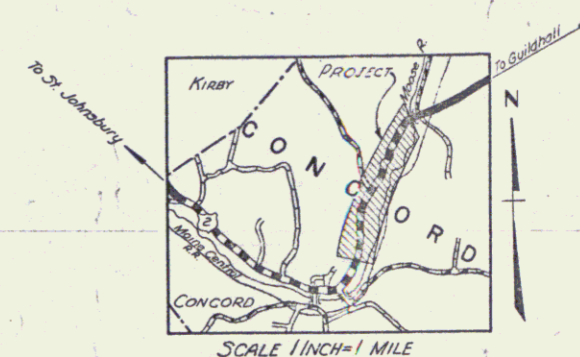

RECORD PLANS  
By: W.H. Chase

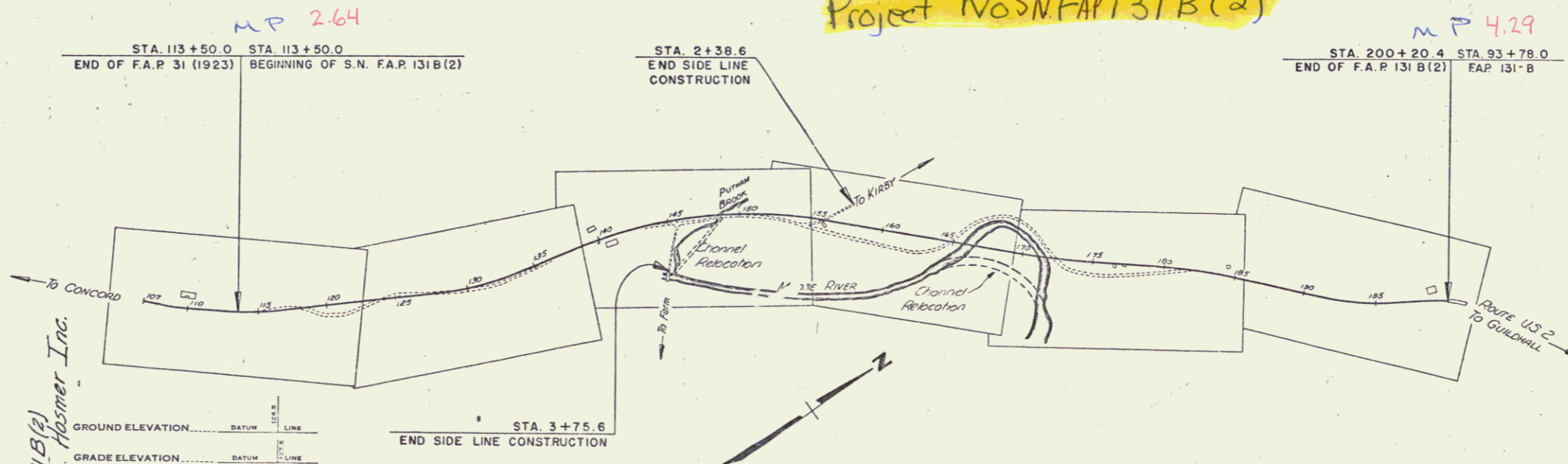

RIGHT-OF-WAY DIVISION  
TOWN FILE  
PERPETUAL  
Rte US 2  
Town of CONCORD  
(To Be Returned To R.O.W. Division)

APPROVED: May 26, 1941  
H. J. J. J.  
COMMISSIONER OF HIGHWAYS  
SUBMITTED BY ORDER OF THE STATE HIGHWAY BOARD

- COUNTY LINE
- TOWN LINE
- FENCE LINE
- STONE WALL
- UNFENCED PROPERTY
- GUARD RAIL
- TRAVELED WAY
- RAILROAD
- RETAINING WALL
- CENTER LINE
- SURVEY LINE
- CULVERT
- DROP INLET
- TROLLEY POLE
- POWER POLE
- TELEPHONE POLE
- TREES
- HEDGE

CURVE DATA

DEFLECTION ANGLE	Δ
DEGREE OF CURVE	D
RADIUS OF CURVE	R
TANGENT DISTANCE	T
LENGTH OF CURVE	L
EXTERNAL DISTANCE	E
POINT OF INTERSECTION	P. I.
POINT OF CURVE	P. C.
POINT OF TANGENT	P. T.
POINT ON TANGENT	P. O. T.

SCALES

TITLE	1" = 500'
TYPICAL	1" = 2'
PLAN	1" = 50'
PROFILE HORIZONTAL	1" = 50'
PROFILE VERTICAL	1" = 10'
CROSS SECTIONS	1" = 5'

THESE PLANS ARE SUBJECT TO SUCH REVISIONS AS MAY BE REQUIRED BY THE PUBLIC ROADS ADMINISTRATION OR THE COMMISSIONER OF HIGHWAYS.  
CONSTRUCTION IS TO BE CARRIED ON IN ACCORDANCE WITH THE PLANS AND THE STANDARD ROAD AND BRIDGE SPECIFICATIONS OF 1936, AS APPROVED DECEMBER 29TH, 1936 BY THE PUBLIC ROADS ADMINISTRATION, INCLUDING ALL SUBSEQUENT APPROVED REVISIONS AND SUCH REVISED SPECIFICATIONS AND SPECIAL PROVISIONS AS ARE SUBMITTED WITH THE PLANS.

RECOMMENDED FOR APPROVAL  
DISTRICT ENGINEER  
PUBLIC ROADS ADMINISTRATION  
FEDERAL WORKS AGENCY

APPROVED  
PUBLIC ROADS ADMINISTRATION  
FEDERAL WORKS AGENCY

APPROVED: <u>4/11/41</u> <u>W. H. Chase</u> ROAD ENGINEER	APPROVED: <u>May 12, 1941</u> <u>H. J. J. J.</u> DISTRICT HIGHWAY COMMISSIONER	SERIES F.A.P. NO. 131(2) FILED SHEET <u>1</u> OF 61
---	--	--

DIST. # 7 PLANS