

Note:  
 The design contemplates retaining the present concrete wall left of sta. 93+89 ± to sta. 95+50 ± and concrete drive left of sta. 94+80 and building a variable width sidewalk between this wall and the new concrete curb to an elevation fitting the new curb.

PARCEL	INSTRUMENT	DATE	GRANTOR	GRANTEE	RECORDED BOOK	RECORDED PAGE	REMARKS
#13A	CORR. W.D.O.E.	8-27-46	NEW ENGLAND DAIRIES, INC.	ST. OF VT.	33	406 10-9-46	

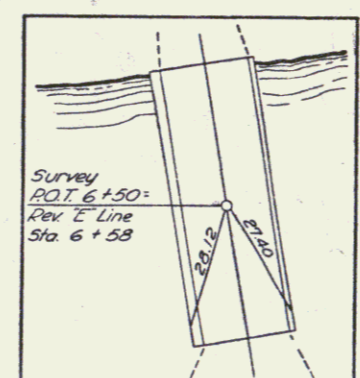

ESTIMATED QUANTITIES	

CONCORD  
 Surveyed by  
 Designed by  
 Drawn by  
 Traced by E. Rogers  
 Checked by  
 Series F No. 31(2)  
 Sheet 16 of 99 Sheets