

GUARD RAIL REQUIRED
ON LEFT
 Sta 30185 to 31112 Length 24 ft
 Sta 38168 to 38192 " 24"
 Sta 42146 to 42170 " 24"
ON RIGHT
 Sta 30185 to 31112 Length 24 ft
 Sta 38168 to 38192 " 24"
 Sta 42122 to 43110 " 88"
TOTAL THIS SHEET 208 ft

CULVERT REPAIRS REQUIRED
 Sta 42158 Extend 18 in. Corr. Iron Pipe 14 ft
 1-2 1/2 Concrete Headwalls 0.8 cu yds

NEW CULVERTS REQUIRED
 Sta 31100 16 in. Corr. Iron Pipe 28 ft
 1-2 1/2 Concrete Headwalls 1.5 cu yds
 Sta 38180 16" Corr. Iron Pipe 30 ft
 1-2 1/2 Concrete Headwalls 1.5 cu yds

SUB BASE REQUIRED
 Sta 30100 to 33100 Length 300 ft

FED. ROAD DIST. NO.	STATE	FED. AID FISCAL YEAR	SHEET NO.	TOTAL SHEETS
9	VT.	31	1927	5

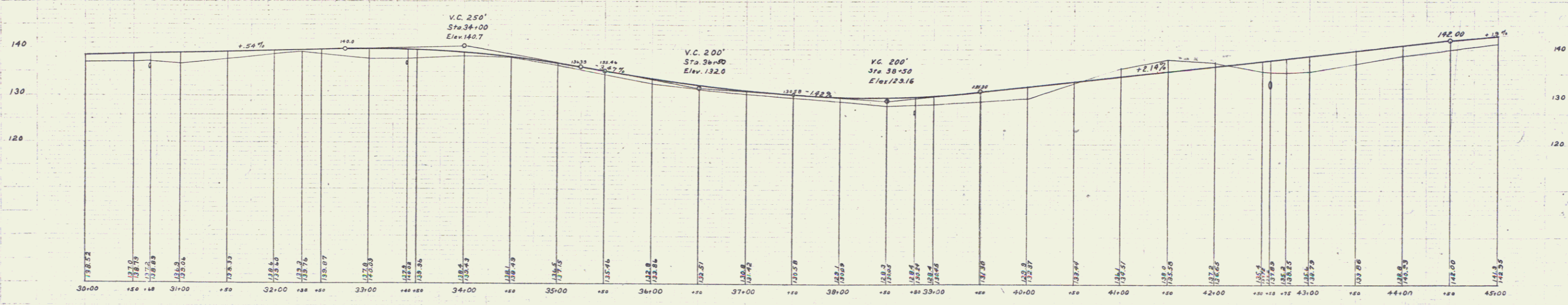
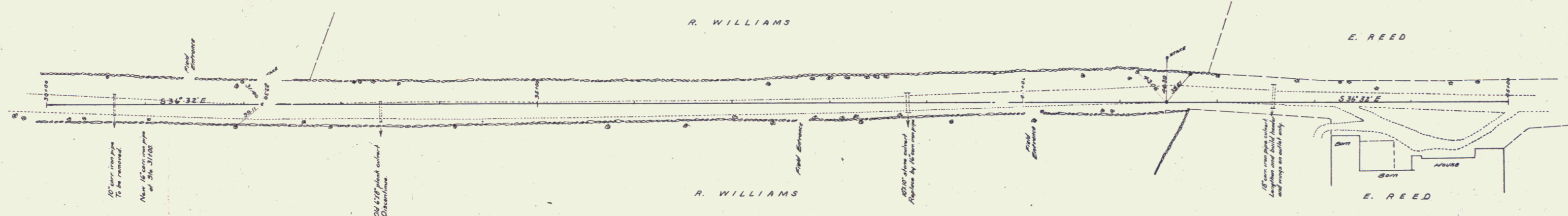

B.M. No. 4 Spike in 16" Elm on rt. Sta 36+52 Elev. 134.3
 B.M. No. 5 Base board N.E. corner E. Reed's barn on rt. Sta 43+47 Elev. 136.19

44