

END STAGE WOOD GUARD RAIL REQUIRED		
CUV. STA.	LT.	RT.
320+50	24'	24'
324+38	-	24'

2 HD. STREE GUIDE POSTS OF WOOD REQUIRED		
CUV. STA.	LT.	RT.
321+25	1'	1'
322+15	1'	-
330+87	1'	1'
334+38	1'	-

1ST STAGE NEW REIN. CONCRETE PIPE CONVERTS REQUIRED						
STA.	L-R	DIAM.	LENG.	CONC. P.	SMH	GRP
320+50	-	18"	40'	-	-	3.5'
321+88	-	18"	40'	2.2'	1.5'	3.5'
321+94-321+83.5	-	12"	36'	1.7'	1.0'	-
330+87	-	18"	40'	-	-	3.5'
334+38	-	18"	36'	-	-	3.5'

E131-D 1952 24

Road
Ac. Plan
1/2" = 100'

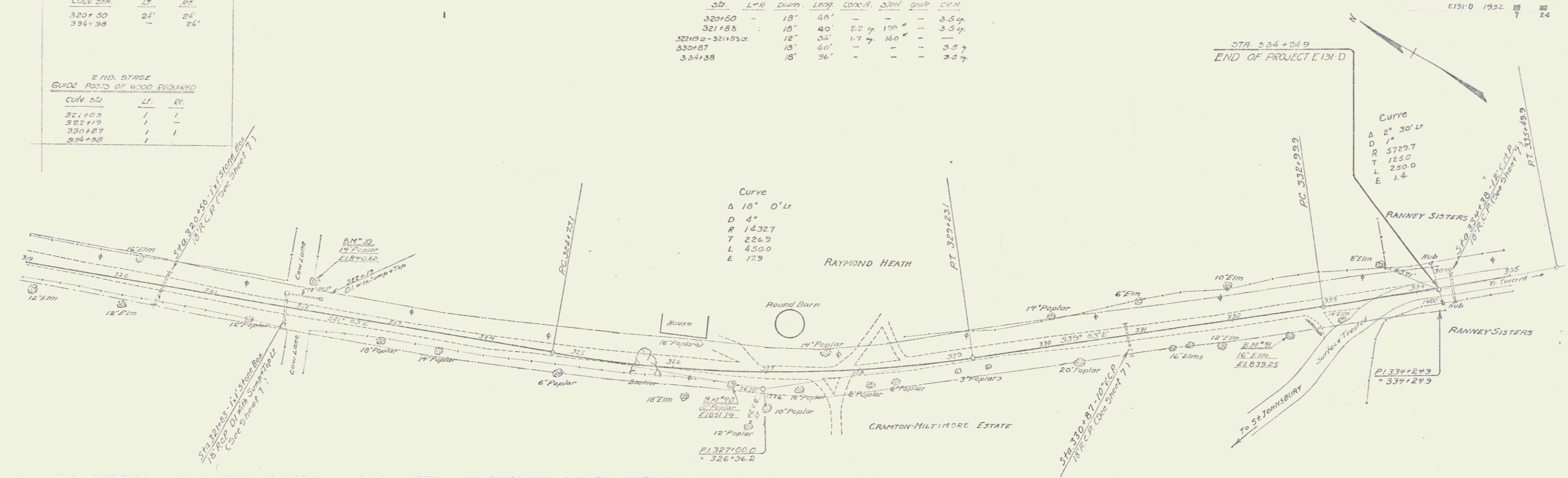

VERT
PLAN
1" = 10'

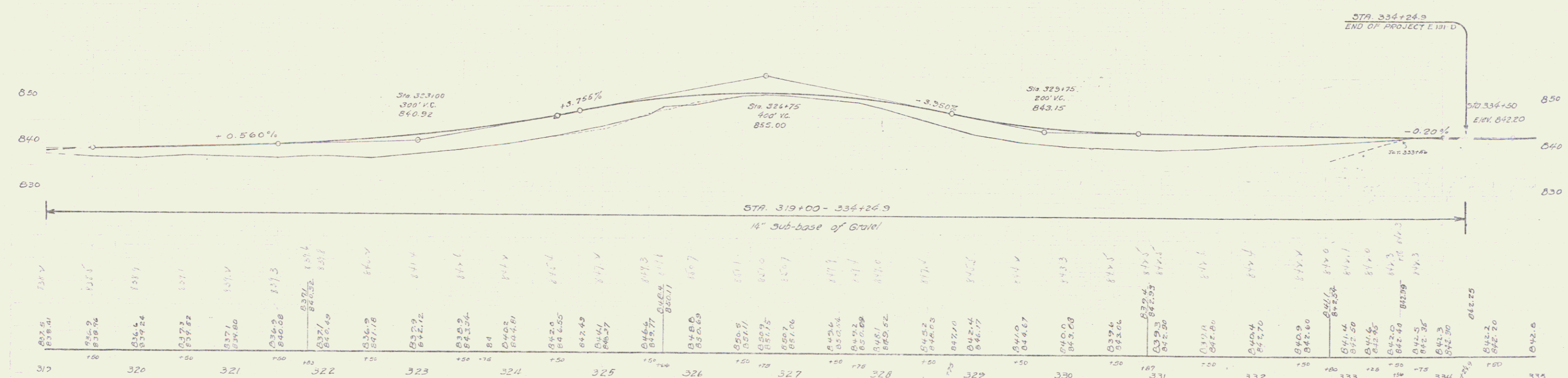

B.M. #39 Spike in Roof 14" Poplar 30' LT Sta 322+01 E1,840.60
 B.M. #40 " " " " 10' " " 11.5' " " 326+62 E1,851.74
 B.M. #41 " " " " 16' Elm RR Rt. " 332+66 E1,839.25

SERIES F 176 E131-D
 SHEET 7 OF 24 SHEETS
 24

9