

2ND STAGE  
WOOD GUARD RAIL REQUIRED

STA	LT	RT
276+00	24'	-
279+00	24'	24'

2ND STAGE  
GUIDE POSTS OF WOOD REQUIRED

STA	LT	RT
281+00	1'	1'
284+00	1'	1'

2ND STAGE  
CABLE GUARD RAIL REQUIRED

STA	LT	RT	CONC'D	PI	HT
279+00-279+50	15'	20'	170'	-	-
279+50-279+100	15'	20'	170'	-	-
279+100-279+150	15'	20'	170'	-	-
279+150-279+200	15'	20'	170'	-	-
279+200-279+250	15'	20'	170'	-	-

1ST STAGE  
NEW REIN. CONCRETE PIPE CULVERTS REQUIRED

STA	DIA	LEN	CONC'D	STEEL	C.R.M.
279+62	18"	48'	-	-	3.5%
281+23	18"	44'	-	-	3.5%
284+01	18"	36'	-	-	3.5%

1ST STAGE  
NEW REIN. CONCRETE BOX CULVERTS REQUIRED

STA	DIA	LEN	CONC'D	STEEL	C.R.M.
276+84	4'x4'	33.0'	-	-	2.300%
276+84	3'x3'	25.4'	-	-	2.463%

CORR. GALV. METAL PIPE (AS P.C.T.D.) CULVERTS

STA	DIA	LEN	CONC'D	STEEL	C.R.M.
273+70	36"	50'	-	-	6.00%

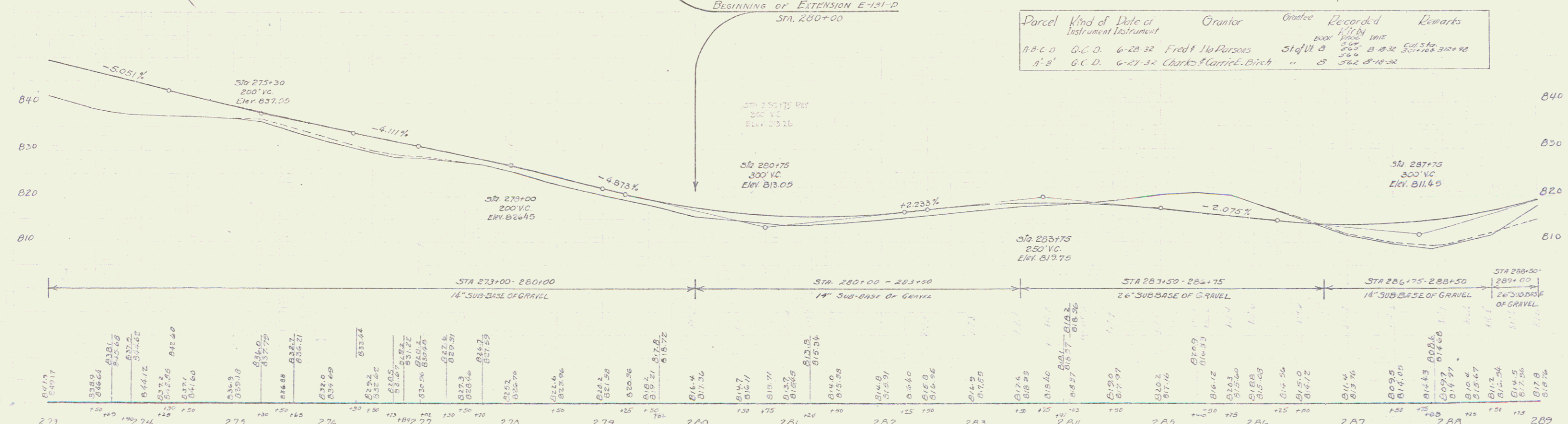
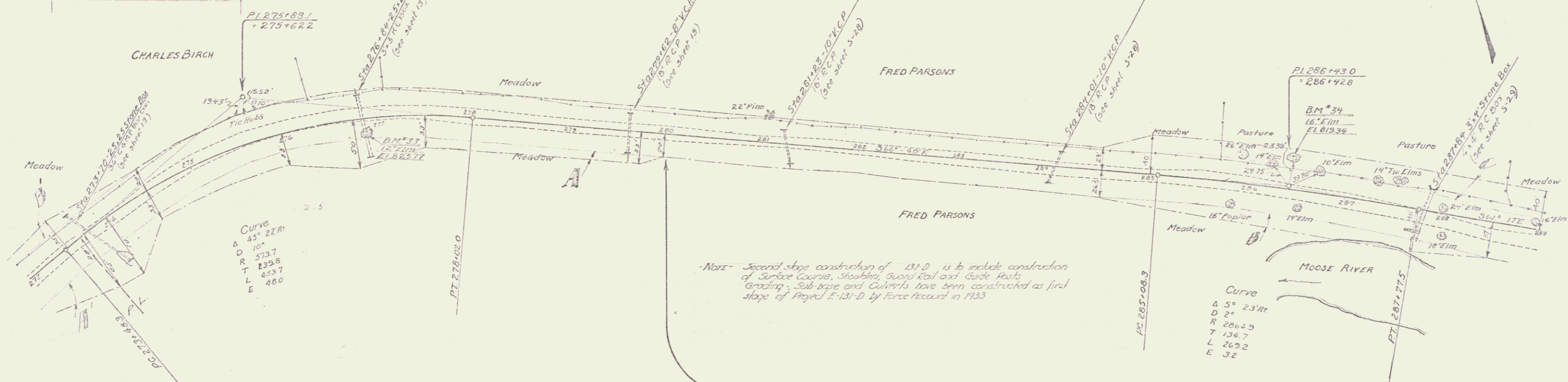

Parcel	Kind of Instrument	Date of Instrument	Grantor	Grantee	Recorded	Remarks
A.B.C.D.	O.C.D.	6-28-32	Fred W. Parsons	State of N.H.	500	300' x 300' lot
A.B.	O.C.D.	6-27-32	Charles Carrick Birch	"	562	8-18-32

B.M. 33 Spike in Root 12" Elm 125' RT, Sta 276+87 El. 825.77  
 B.M. 34 " " " 16" " 27' LT, Sta 286+41 El. 819.34

SERIES F  
 SHEET 4 OF 27 SHEETS  
 B