

INDEX OF SHEETS

SHEET NO 1	TITLE PAGE
2	TYPICAL CROSS-SECTION OF IMPROVEMENT (2 1/2" GRAVEL MIXED-IN-PLACE SURFACE COURSE WITH CUT-BACK GRANULITE SAND 1/2" AND 3/4" SIFTS)
3	BANKING AND WIDENING TABLES
4-7	PLAN AND PROFILE SHEETS
8	STANDARD SHEET 530; GUARD RAIL
9	" " " " 540; BARRICADES, SIGNS & LIGHTS
10-19	CROSS-SECTIONS

Standard sheet 530 approved by the Chief Engineer on Aug 15, 1933.

FED. ROAD DIST. NO.	STATE	FED. AID PROJ. NO.	FIN. AC. YEAR	SHEET NO.	TOTAL SHEETS
9	VT.	131-D	1936	1	19

STATE OF VERMONT
STATE HIGHWAY DEPARTMENT

PLAN AND PROFILE OF PROPOSED
STATE HIGHWAY

FEDERAL AID PROJECT

TOWNS OF KIRBY-CONCORD

ST. JOHNSBURY, VT.-LANCASTER, N.H. ROAD

FROM 1100 FT. EAST OF THE RESIDENCE OF CHARLES BIRCH,
SOUTHEASTERLY 1.029 MILES, TO 824± FT. SOUTH OF THE RES-
IDENCE OF RAYMOND HEATH.

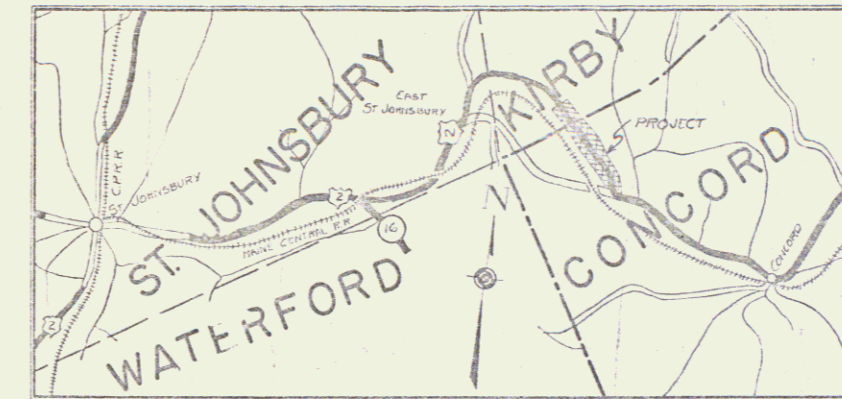

SCALE: 1 INCH = 1 MILE

LENGTH OF PROJECT 5438.3 FT = 1.029 MILES

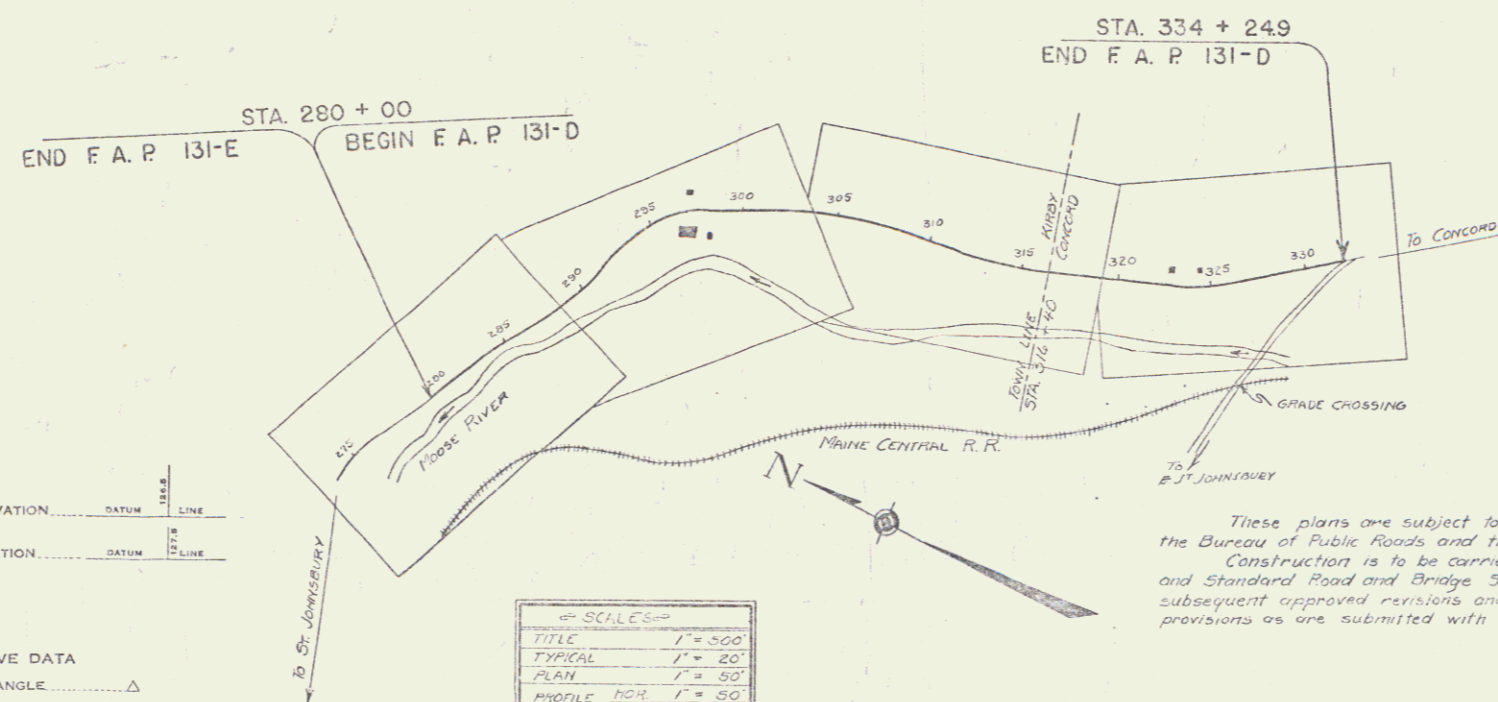

CONVENTIONAL SIGNS

COUNTY LINE
TOWN LINE
FENCE LINE
STONE WALL
UNFENCED CITY
GUARD RAIL
TRAVELED ROAD
RAILROAD
RETAINING WALL
CENTER LINE
SURVEY LINE
CULVERT
TROP INLET
TROLLEY POLE
POWER POLE
TELEPHONE POLE
TREES
HEDGE

GROUND ELEVATION	DATUM	LINE
GRADE ELEVATION	DATUM	LINE

CURVE DATA	
DEFLECTION ANGLE	Δ
DEGREE OF CURVE	D
RADIUS OF CURVE	R
TANGENT DISTANCE	T
LENGTH OF CURVE	L
EXTERNAL DISTANCE	E
POINT OF INTERSECTION	P. I.
POINT OF CURVE	P. C.
POINT OF TANGENT	P. T.
POINT ON TANGENT	P. O. T.

SCALES	
TITLE	1" = 500'
TYPICAL	1" = 20'
PLAN	1" = 30'
PROFILE	1" = 50'
CROSS-SECTIONS	1" = 5'

These plans are subject to such revisions as may be required by the Bureau of Public Roads and the Commissioner of Highways. Construction is to be carried on in accordance with the plans and Standard Road and Bridge Specifications of 1930 including all subsequent approved revisions and revisions specifications and special provisions as are submitted with the plans.

APPROVED: May 20, 1935
H. S. Chagnon
COMMISSIONER OF HIGHWAYS

SUBMITTED BY ORDER OF THE STATE HIGHWAY BOARD

RECOMMENDED _____
DISTRICT ENGINEER BUREAU OF PUBLIC ROADS

RECOMMENDED FOR APPROVAL _____
CHIEF ENGINEER BUREAU OF PUBLIC ROADS

APPROVED _____
DIRECTOR BUREAU OF PUBLIC ROADS

CORRECT: May 20, 1935
G. B. [Signature]
ROAD ENGINEER

SERIES F.A.P. NO. 131-D FILED
SHEET 1 OF 19

352 2