

WOOD GUARD RAIL REQUIRED

STATION	FEET	RISHT
216+50	24'	24'
220+04	24'	24'
222+80	24'	24'
222+09	24'	24'

NEW CAST IRON PIPE CULVERTS REQUIRED

STATION	DIAM.	LENG.	CONC.	CHOC.	REIN. STEEL	WTS.
216+50	18"	30'	1.5 cy	-	-	73 lbs
220+04	18"	40'	1.0 cy	-	-	27 lbs
222+40	36"	40'	4.0 cy	-	-	58 lbs
228+50	18"	36'	1.5 cy	-	-	73 lbs

STD. UNDERDRAIN WITH 6" CONC. SAND METAL PIPE (PROTECTED)

STA. TO STA.	LENG.	CEMENT	RUBBLE	MASONRY
215+00 - 216+20	20'	-	-	-

Parcel	Kind of Instrument	Date of Instrument	Grantor	Grantee	Recorded	Remarks
B'	G.O.D.	7-31-51	Newman, Page & Hadley	Woods Estate	Book Page	Date
A.C. # 4,973	"	8-15-51	Harley Douglas	Woods Estate	12-30-51	10-4-51 Cal Sta 320108
					121405229103	

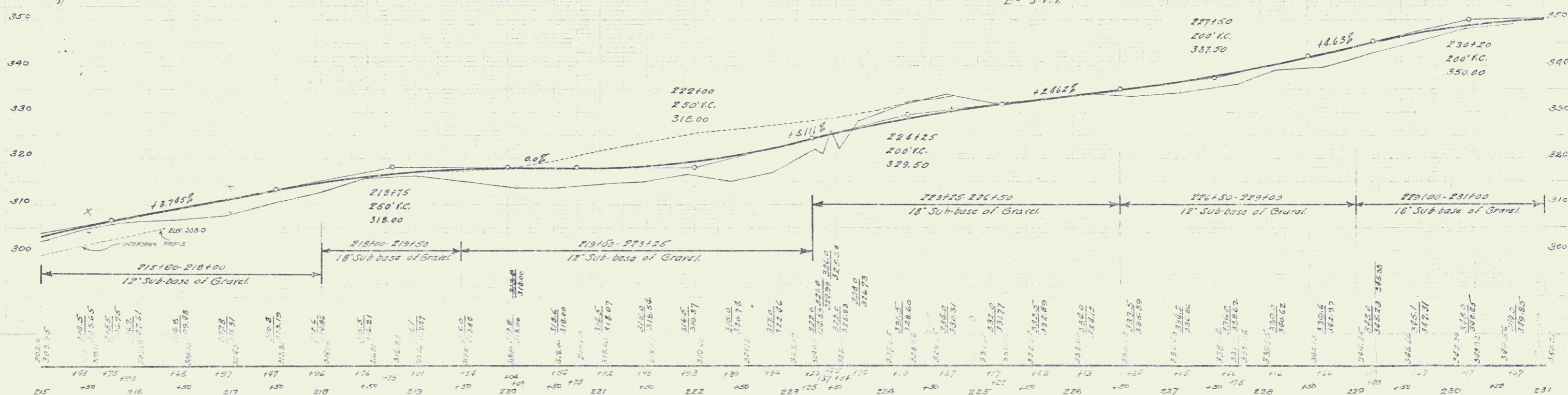
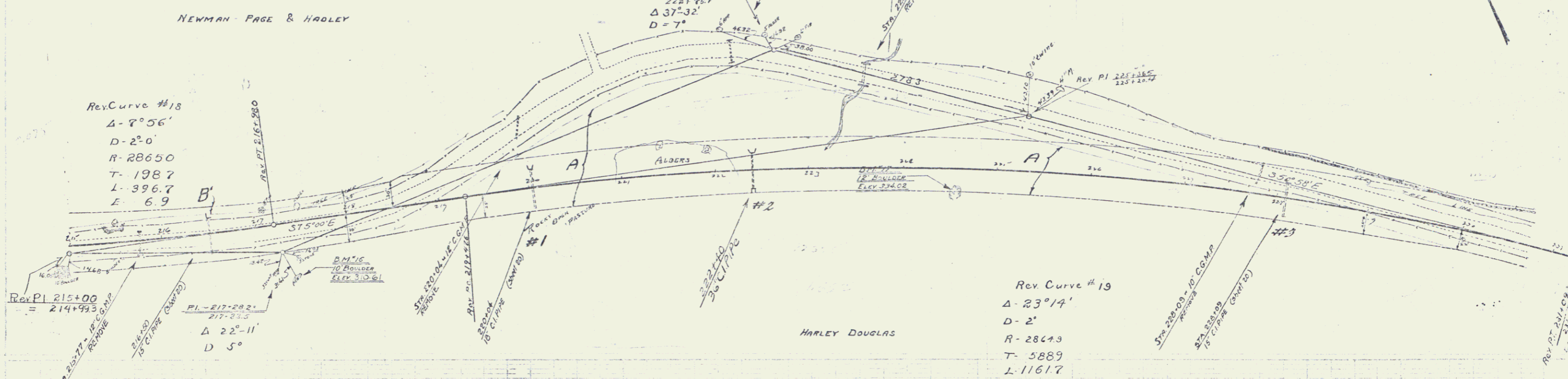

B.M. 16, TOP OF 10' BOUNDER, 52' RT. OF STA 217+33 - ELEV. 310.61  
 B.M. 17, TOP OF 12' BOUNDER, 91' RT. OF STA 224+94 - ELEV. 324.02