

WOOD GUARD RAIL REQUIRED

CUV. STA	LEFT	RIGHT
115+76	24'	24'
120+62	24'	24'
126+94	24'	24'

NEW CAST IRON PIPE CONVEYERS REQUIRED

STATION	DIAM.	LENG.	CVK.A	CVK.C	REV. SISEL
115+74	15"	39'	1.5 77	-	73 100
120+62	16"	36'	2.4 67	-	102 150
126+94	24"	39'	2.4 67	-	34 100

POOR ORIGINAL COPY

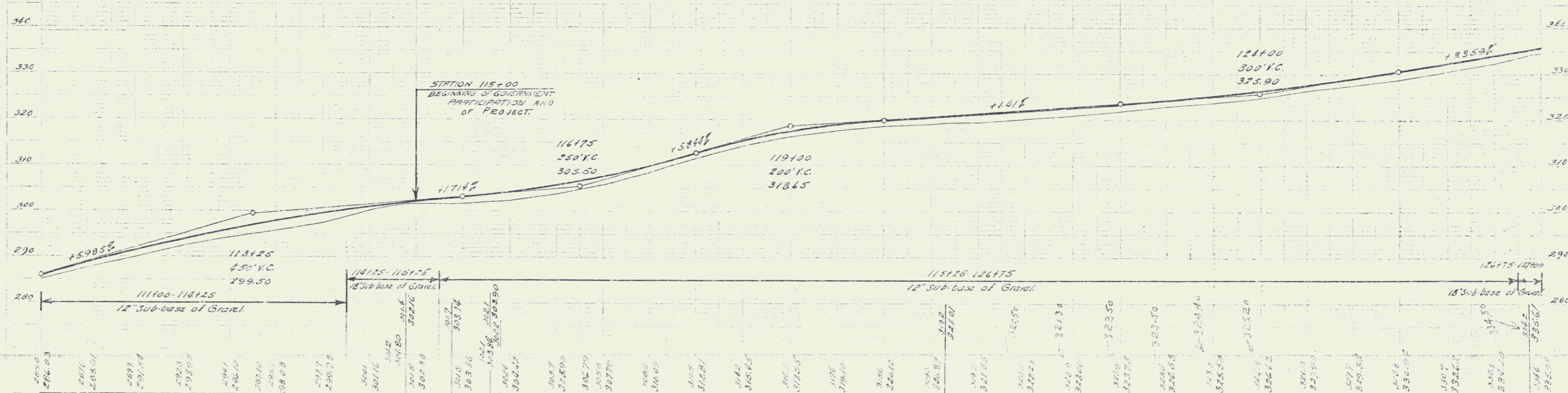
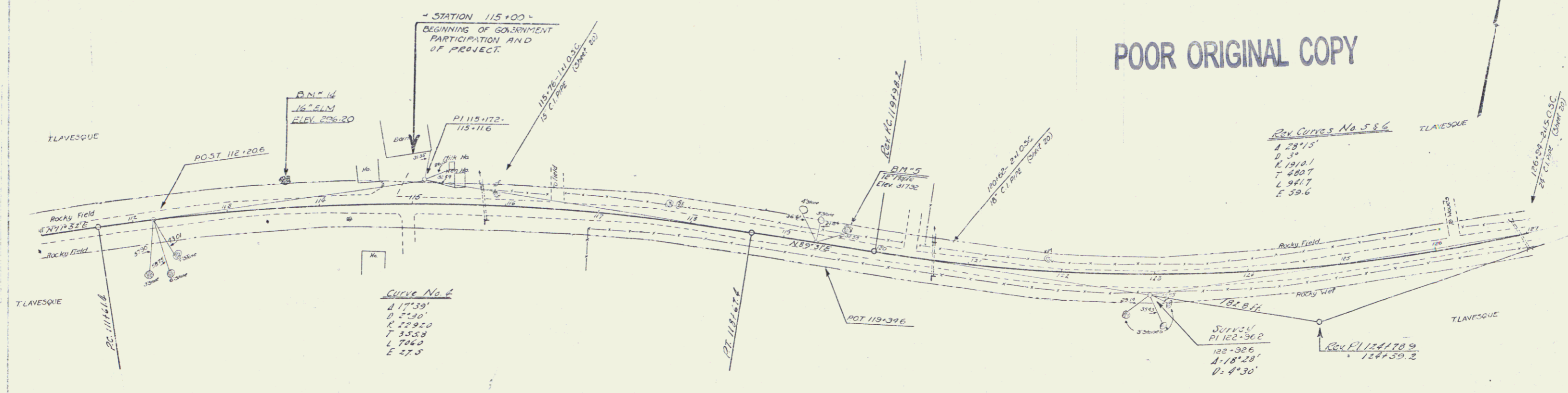

Station	Elevation
110	286.03
111	287.01
112	288.01
113	289.01
114	290.01
115	291.01
116	292.01
117	293.01
118	294.01
119	295.01
120	296.01
121	297.01
122	298.01
123	299.01
124	300.01
125	301.01
126	302.01
127	303.01