

2<sup>ND</sup> STAGE  
WOOD GUARD RAIL

CULY STA	LT	RT
216+00	24'	-

2<sup>ND</sup> STAGE  
CABLE GUARD RAIL

STA - STA	LT+RT	LENG	CONST.	PAYLENG
215+00 - 218+50	RT	342'	40'	392'
219+50 - 221+00	RT	150'	20'	130'

1<sup>ST</sup> STAGE  
REINFORCED CONCRETE PIPE CULVERTS

STATION	Lo-R	DIAM	LENG	CONC. A	STEEL	GRATES	CRM
213+10-213+55	L	12"	44'	1.9 cy	150"	1	-
213+55-214+35	L	12"	80'	2.9 cy	241"	1	-
214+35-216+00	L	12"	164'	27 cy	217"	1	-
216+00-216+10	L	12"	10'	3"	217"	1	-
216+10	E	15"	12'	20 cy	410"	2	12 cy
217+00	E	12"	44'	2.4 cy	222"	-	12 cy
218+40	E	15"	40'	2.4 cy	222"	-	12 cy
219+62	E	15"	15'	2.1 cy	174"	1	12 cy

2<sup>ND</sup> STAGE  
GROUTED COBBLE GUTTER REQUIRED

STA - STA	LT+RT	LENG	WIDTH	AREA
213+35-216+00	LT	265'	6'0"	1633 sq. y.

2<sup>ND</sup> STAGE  
CORR. GALV. METAL PIPE (ASH STD) CULVERTS

STATION	Lo-R	DIAM	LENG	CONC. A	STEEL	GRATES	CRM
226+74	E	15"	30'	2.2	130	14	-

2<sup>ND</sup> STAGE  
GUIDE POSTS OF WOOD

CULY STA	LT	RT
217+00	1	-
219+62	1	-
222+91	1	-
226+74	1	-

Curve  
 $\Delta$  4° 36' Lt  
 $D$  2"  
 $R$  2864.3  
 $T$  115.1  
 $L$  230.0  
 $E$  2.4

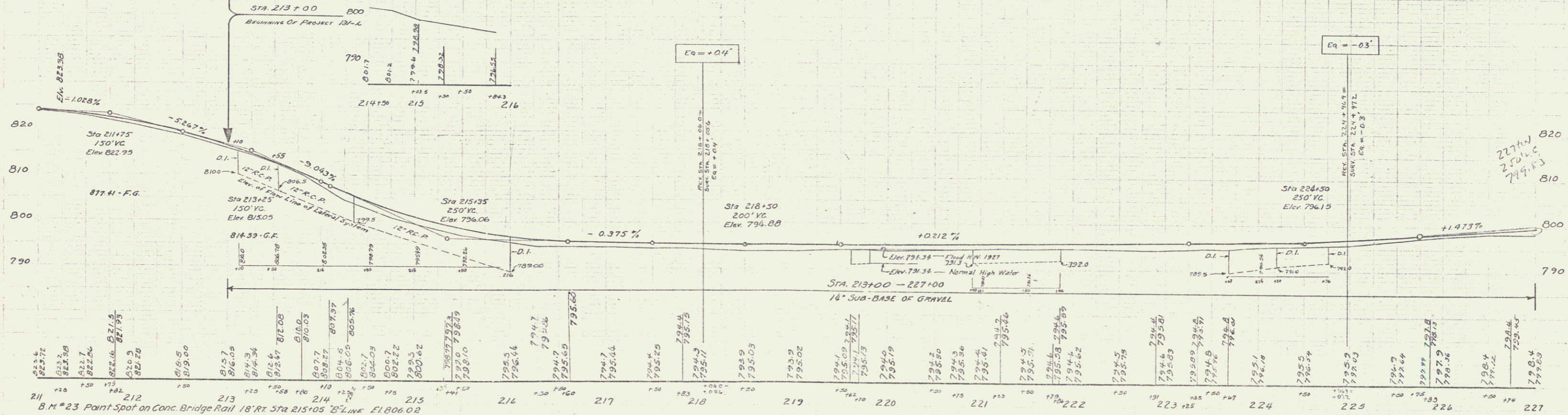
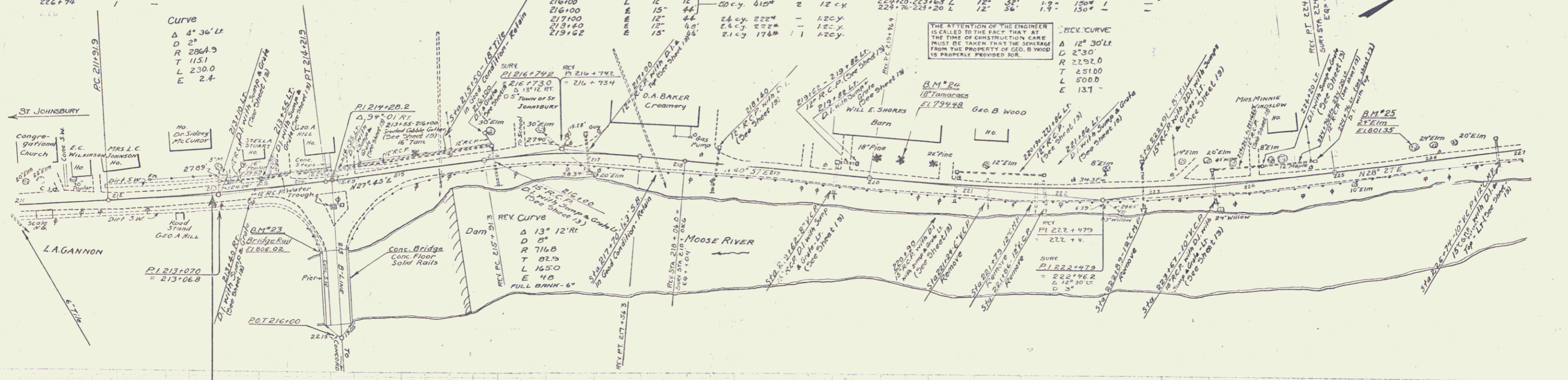

B.M. #23 Point Spot on Conc. Bridge Rail 18' Rt Sta 215+05 B' Line E1806.02  
 R-3 U.S.C.G.S. B.M. Bronze Plat on Ledge 375 Lt Sta 216+00 E1790.723  
 B.M. #24 Spike in Root 18' Tamarack 18' Lt Sta 220+29 E1794.748  
 B.M. #25 " " 24' Lt Sta 225+87 E1801.35

SERIES E No 131-C  
 SHEET 6 OF 27 SHEETS