

INDEX OF SHEETS

SHEET NO. 1	TITLE PAGE
2	TYPICAL CROSS-SECTION OF IMPROVEMENT
3	BANKING AND WIDENING TABLES
4-12	PLAN AND PROFILE SHEETS
13	STANDARD STRUCTURE SHEET
14	"
15	"
16	"
16-A	"
17-18	CROSS SECTIONS

FED. ROAD DIST. NO.	STATE	FISCAL YEAR	SHEET NO.	TOTAL SHEETS
9	VT.	E-131-D	1052	1

STATE OF VERMONT
STATE HIGHWAY DEPARTMENT

PLAN AND PROFILE OF PROPOSED
STATE HIGHWAY

TOWNS OF ST. JOHNSBURY-KIRBY *Pin # 99R147*

ST. JOHNSBURY, VT.-LANCASTER, N.H. ROAD

RELOCATION OF ROUTE US-2 BETWEEN THE STATION ROAD IN EAST ST. JOHNSBURY VILLAGE, EASTERLY 2.275 MILES, TO ITS INTERSECTION WITH US-2
LENGTH OF PROJECT 12,014.9 FT. = 2.275 MILES
6676.5 1.264

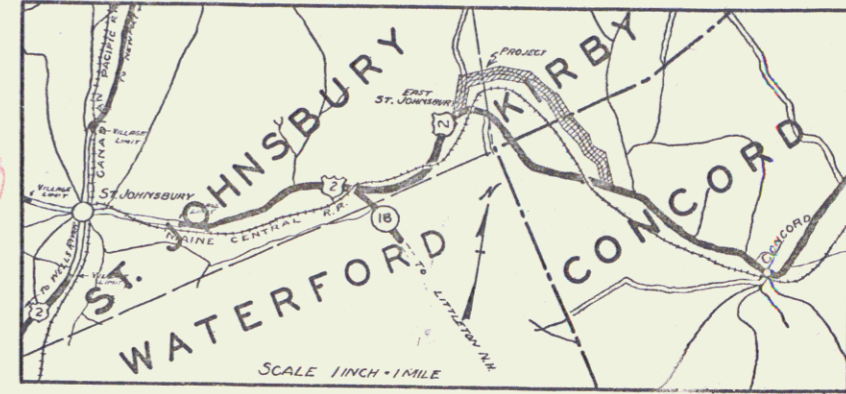

NO.	DESCRIPTION	LENGTH	DATE
1	CONTRACTOR STATE ESTIMATE ACCOUNT		YEAR 19 37
2	LOCATION U.S. 2 from the residence of Dr. Sidney McCurdy, northwesterly 1.3 miles to 1100 feet east of the residence of Harry Smith.		
3	CONTRACTOR STATE ESTIMATE ACCOUNT		YEAR 19 37
4	LOCATION U.S. 2 from the residence of Dr. Sidney McCurdy, northwesterly 1.3 miles to 1100 feet east of the residence of Harry Smith.		
5	CONTRACTOR STATE ESTIMATE ACCOUNT		YEAR 19 37
6	LOCATION U.S. 2 from the residence of Dr. Sidney McCurdy, northwesterly 1.3 miles to 1100 feet east of the residence of Harry Smith.		
7	CONTRACTOR STATE ESTIMATE ACCOUNT		YEAR 19 37
8	LOCATION U.S. 2 from the residence of Dr. Sidney McCurdy, northwesterly 1.3 miles to 1100 feet east of the residence of Harry Smith.		
9	CONTRACTOR STATE ESTIMATE ACCOUNT		YEAR 19 37
10	LOCATION U.S. 2 from the residence of Dr. Sidney McCurdy, northwesterly 1.3 miles to 1100 feet east of the residence of Harry Smith.		

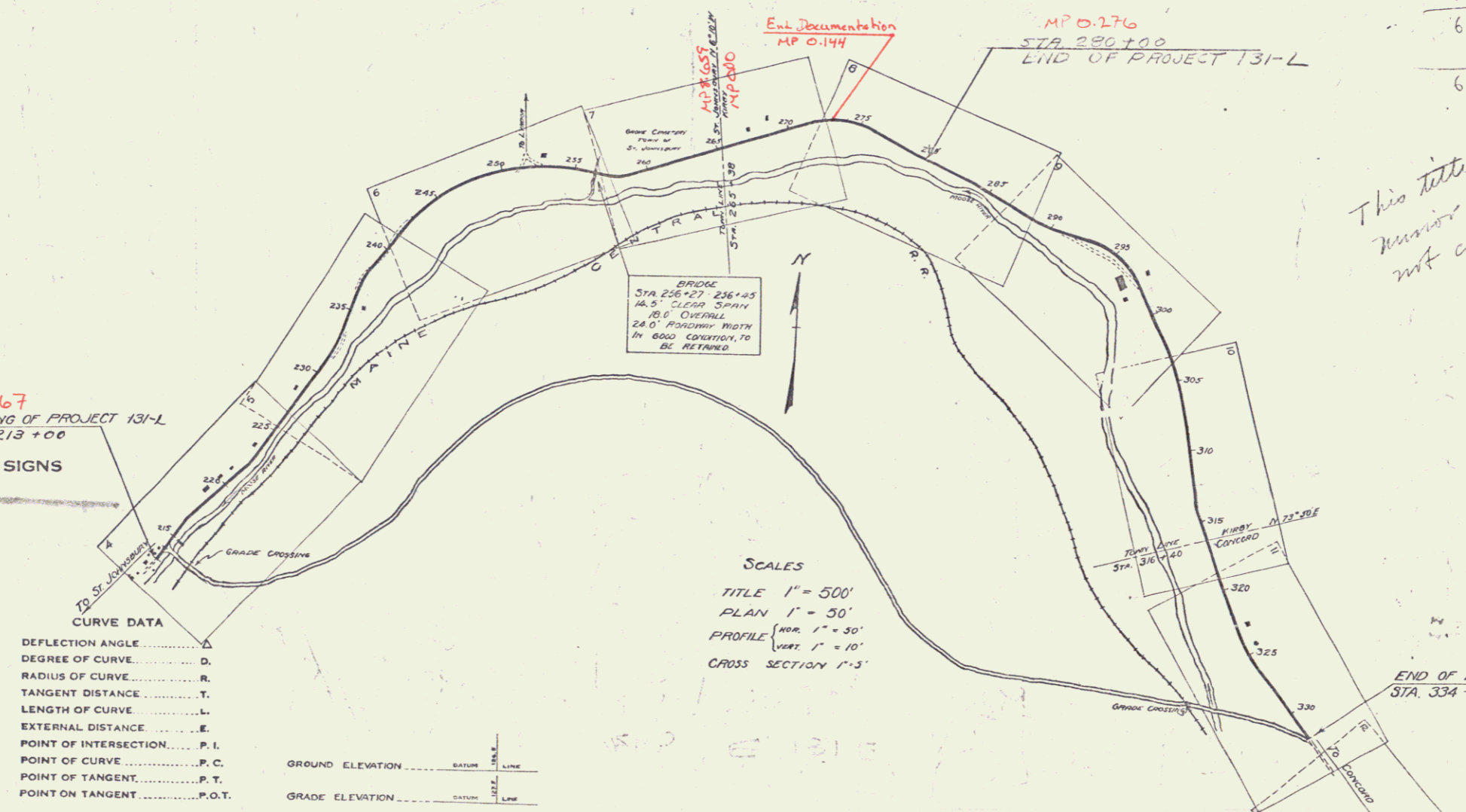

SCALES
TITLE 1" = 500'
PLAN 1" = 50'
PROFILE (HOR. 1" = 50', VERT. 1" = 10')
CROSS SECTION 1" = 5'

CURVE DATA

DEFLECTION ANGLE	D.
DEGREE OF CURVE	D.
RADIUS OF CURVE	R.
TANGENT DISTANCE	T.
LENGTH OF CURVE	L.
EXTERNAL DISTANCE	E.
POINT OF INTERSECTION	P.I.
POINT OF CURVE	P.C.
POINT OF TANGENT	P.T.
POINT ON TANGENT	P.O.T.

GROUND ELEVATION	BATHY LINE
GRADE ELEVATION	GRADE LINE

*280
214+28.2
6571.8
S.I.
6566.7*

This title sheet subject to revision changes - quantity sheet not completed - included

RIGHT-OF-WAY DIVISION
TOWN FILE
PERPETUAL
Rte U.S. 2
Town of U.S. 2
(To Be Returned To R.O.W. Division)

Project: F131L

RECOMMENDED _____
DISTRICT ENGINEER BUREAU OF PUBLIC ROADS

RECOMMENDED FOR APPROVAL _____
CHIEF ENGINEER BUREAU OF PUBLIC ROADS

APPROVED _____
DIRECTOR BUREAU OF PUBLIC ROADS

APPROVED 01/01/38 ROAD ENGINEER
SERIES F. NO. 011 FILED
SHEET 1 OF 1