

MP 545
 RIGHT-OF-WAY DIVISION
 TOWN FILE
 PERPETUAL
 Town of Concord
 (To Be Returned To R.O.W. Division)

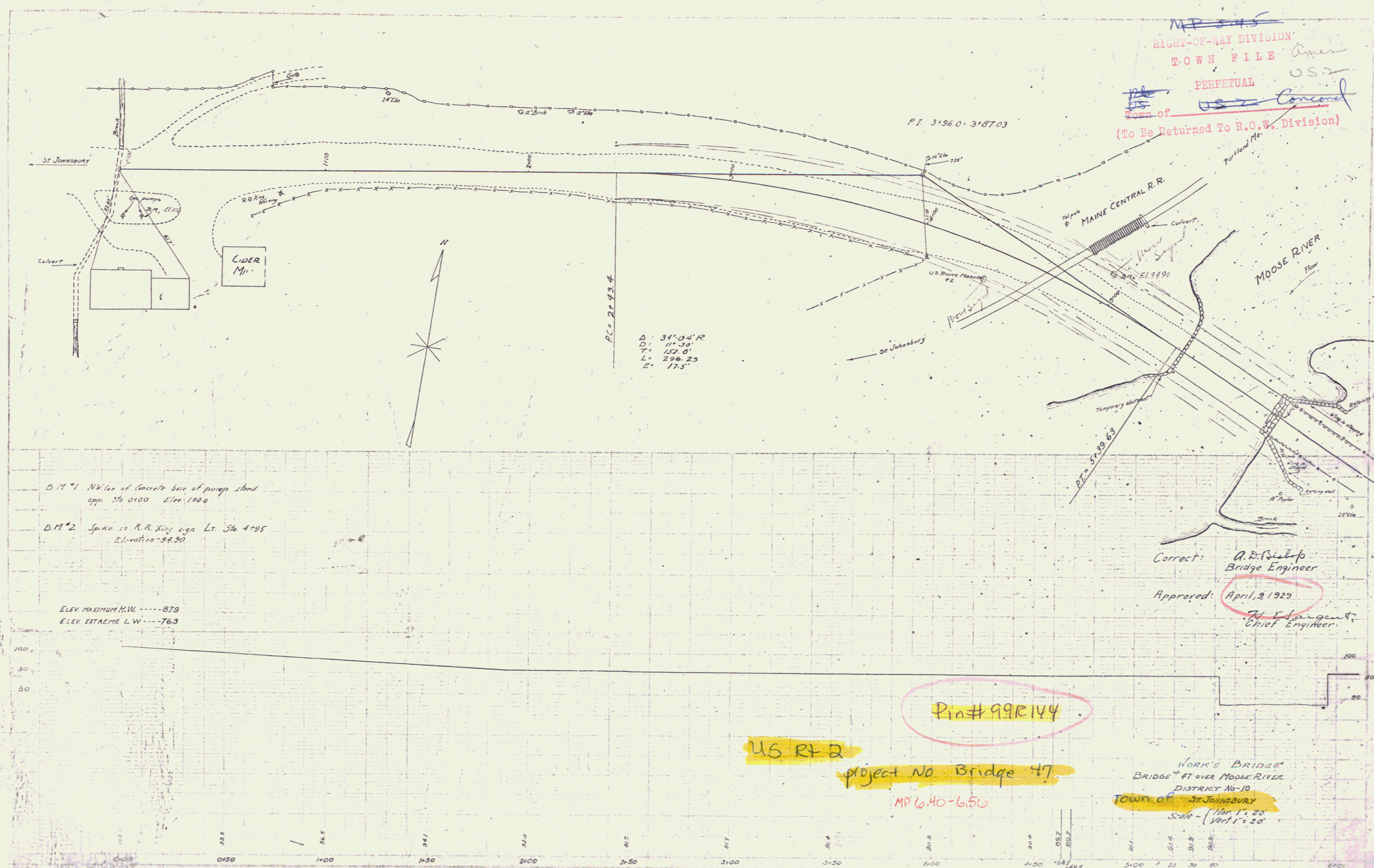

B.M. #1 NW cor of concrete base of pump stand
 opp Sta 0+00 Elev. 100.0
 B.M. #2 Spike in R.R. King sign Lt. Sta 4+95
 Elevation - 98.90

ELEV. MAXIMUM H.W. --- 879
 ELEV. EXTREME L.W. --- 763

PC = 2+93.4
 Δ = 39° 04' R
 DT = 11° 30'
 LT = 152.6'
 ET = 298.25
 E = 17.5'

Pin # 99R144

US RT 2
 project No Bridge 47
 MP 6.40-6.50

WORK'S BRIDGE
 BRIDGE #7 OVER MOOSE RIVER
 DISTRICT No-10
 ST. JOHNSBURY
 Scale - (Hor. 1" = 20'
 Vert. 1" = 20')

Correct: A. D. Bishop
 Bridge Engineer
 Approved: April 2, 1929
 J. E. Sargent
 Chief Engineer

SHEET No 1 of 12 SHEETS
 DIST. # 7 PLANS

M.D. DOWELL 1927

M.D. DOWELL 1927