

PARCEL INSTRUMENT	DATE	GRANTOR	GRANTEE	RECORDED	REMARKS
A-O	8.C.D.	18835 CHARLES J. HARK	ST. JOHN	10-1-35	
A-O	8.C.D.	1814-35 NAPOLEON BURKE	"	77 487-8 10-25-35	
A-O	8.C.D.	11-2-35 SHERMAN J. MCGINNIS	"	79 8-3 11-7-35	

DEMOLISH & RESETTLE GUARD RAIL
STA. 181+92-187+10 & 187+82-187+50

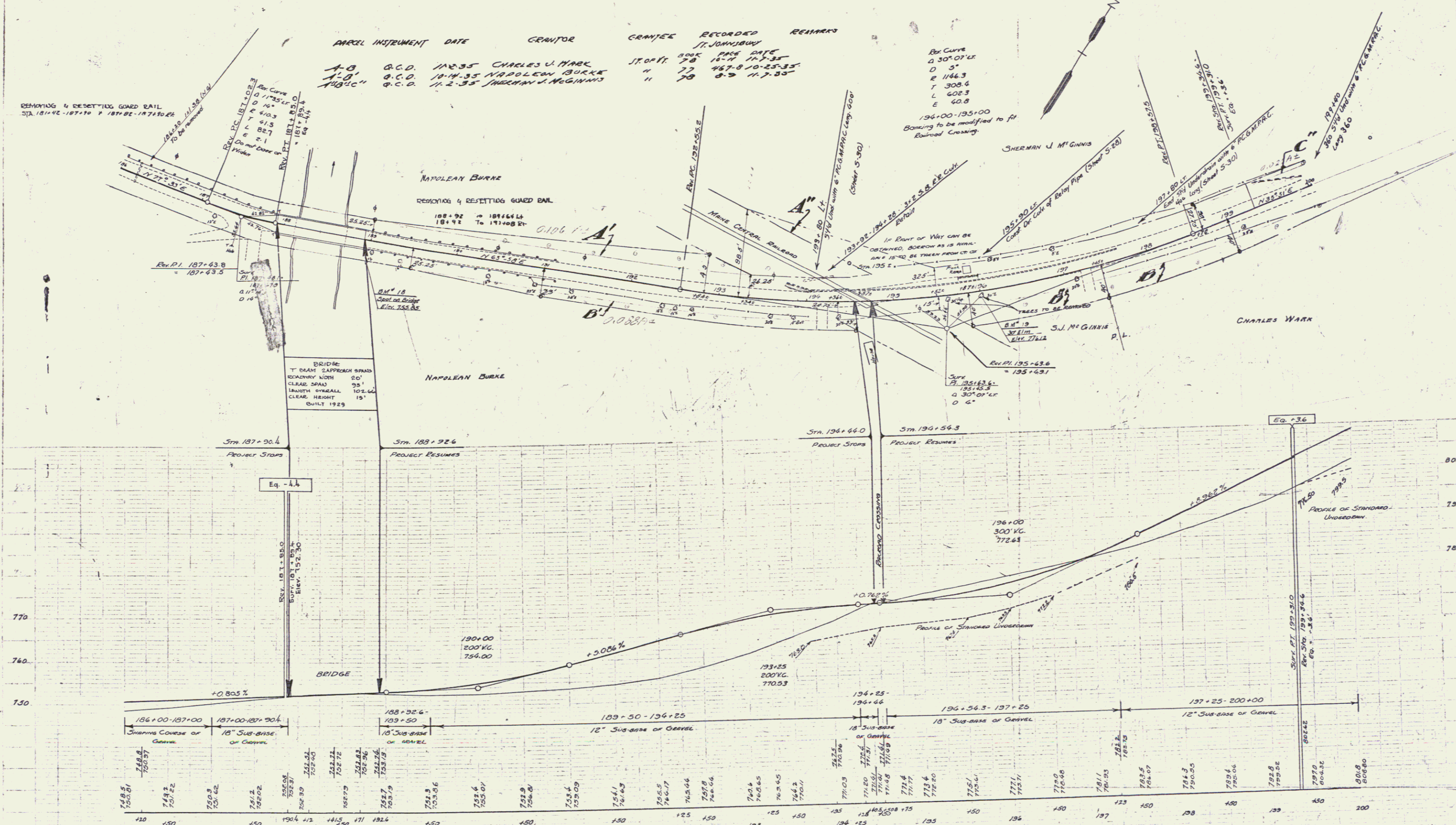

BRIDGE
T-BEAM APPROACH SPREAD
ROADWAY NORTH 20'
CLEAR SPREAD 38'
LENGTH SPREAD 102.66'
CLEAR HEIGHT 15'BUILT 1929

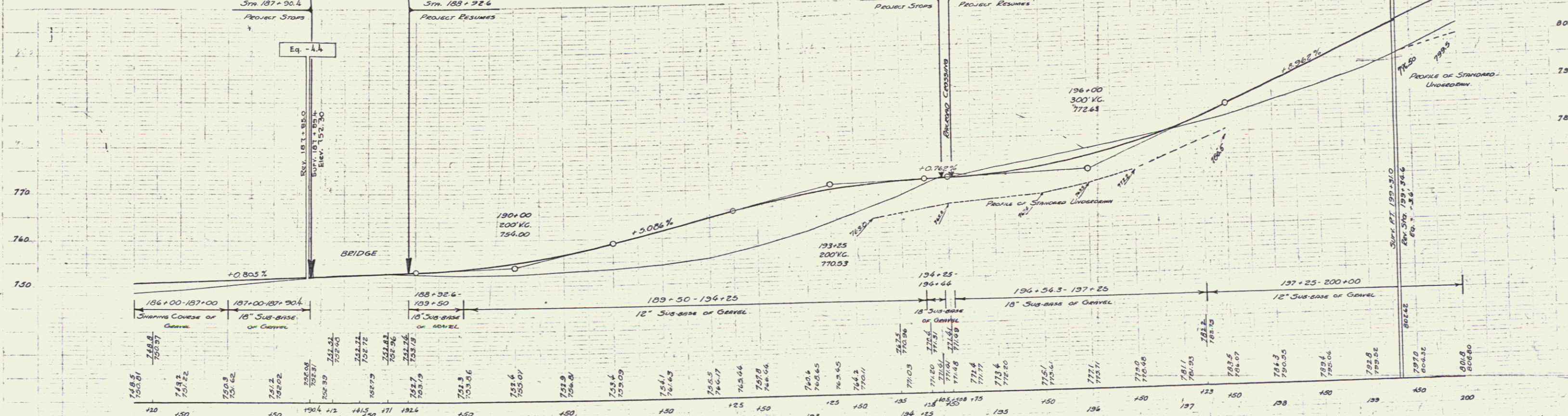

BM#18 PRINT SPOT ON CONC BRIDGE RAIL (NORTH END) 11 FT RT STA 188+92 ELEV 755.85
BM#19 SPIKE IN ROOT OF 30" ELEM 16 FT STA 195+98 ELEV 776.12