

STONE FILL FOR SLOPE PROTECTION (Light Type)
 LT 110+00-110+50- RT 109+50-110+20-

REMOVAL AND DISPOSAL OF PRESENT GUARD RAIL
 LT 110+00-110+20- RT 109+00-110+20-
 109+00-110+20- 109+00-110+12-

THREE CABLE GUARD RAIL w/ LIGHT STEEL POSTS
 LT 109+00-110+28- RT 110+13-

STANDARD STEEL BEAM GUARD RAIL 7/8" STEEL POSTS
 LT 109+90-110+90- RT.

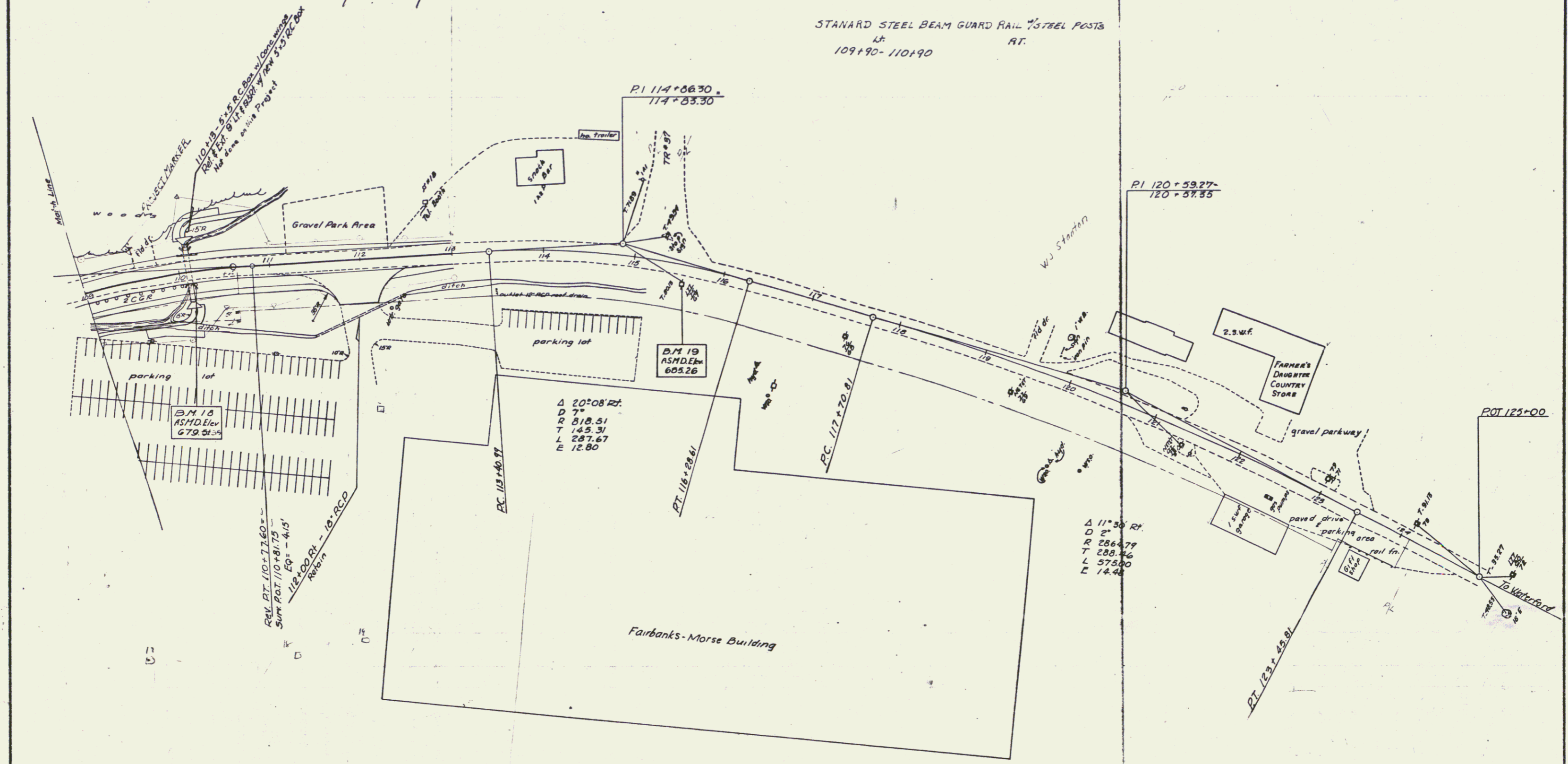

SURVEYED BY Nelson DATE 8-66
 DRAWN BY Finnegan DATE 9-66
 TRACED BY _____ DATE _____

PROJ. BP NO. 028-4-6709
 SHEET 7 OF 29

D-7