

BEGIN ROW PROJECT  
BP 028-A-6709  
STA. 78+00 50'

217 12A  
ASIDE  
UC4 51

ROT 81+50

$\Delta 30^{\circ}42'32''L$   
D 6'  
R 934.93  
T 402.56  
L 845.24  
E 101.81

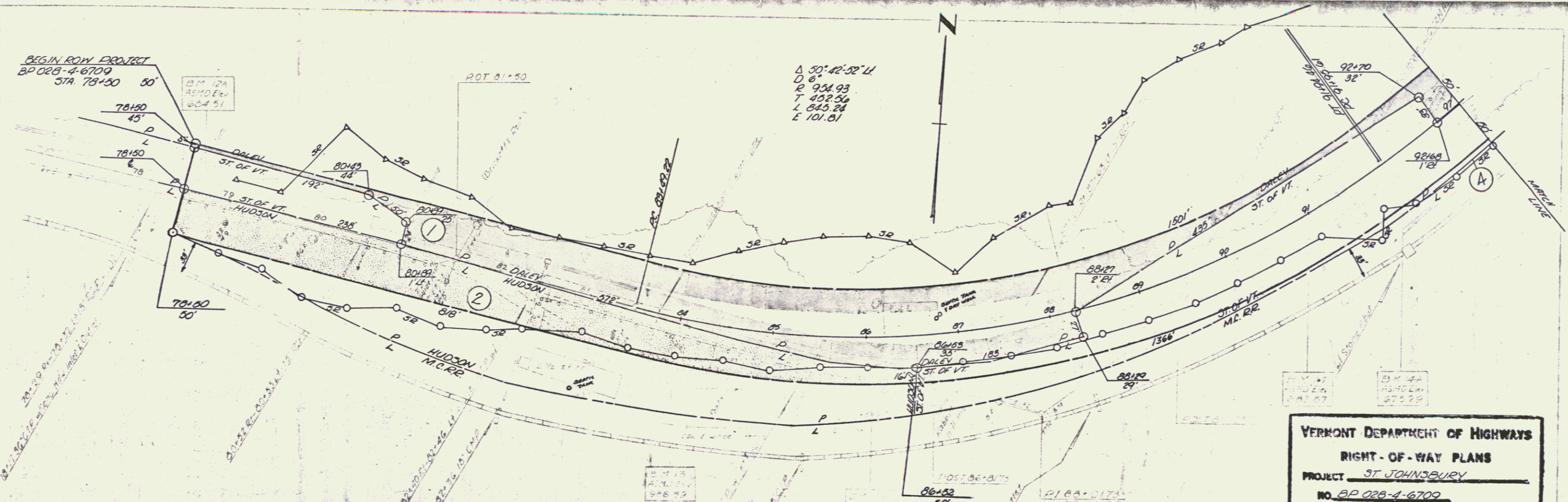

POOR ORIGINAL COPY

VERMONT DEPARTMENT OF HIGHWAYS  
RIGHT-OF-WAY PLANS  
PROJECT ST. JOHNSBURY  
NO. BP 028-A-6709  
SHEET 4 OF 6



4

3