

VERTICAL GRANITE CURB, ITEM 556-B

Western Avenue
95+74.4 - 97+12.4
97+28.4 - 97+40.4
97+58.4 - 98+50.4
97+25.4 - 98+50.4

SURV CURVE DATA

Δ 21° 48' 10"
D 70' 15"
R 790.24
T 152.21
L 300.73'
Bank 7/8" per ft

Islands

93+50 - 94+75
95+15 - 98+50

STD STEEL BEAM GUARD RAIL W/ STEEL POSTS, ITEM 545-A
93+90.5R - 98+50R

REMOVAL OF EXISTING PAVEMENT, ITEM 103-B
94+60 - 97+00
97+00 - 98+50

REMOVAL OF EXISTING CONC SIDEWALK, ITEM 103-B
95+15 - 97+10.4
97+25 - 97+35.4
97+60 - 98+50.4

REMOVAL OF EXISTING CONC CURB, ITEM 103-B
95+15 - 97+12.4
97+25 - 97+35.4
97+50 - 98+50.4
94+60 - 98+50R

5' ONE COURSE CONG SIDEWALK ITEM 560
95+74.4 - 98+50.4

DRIVES

94+88.4
95+08.4
97+18.4
97+47.4

REV SURV CURVE DATA

Δ 59° 56' 08"
D 10'
R 572.96
T 208.18
L 399.36
E 36.7'
Bank 7/8" per ft

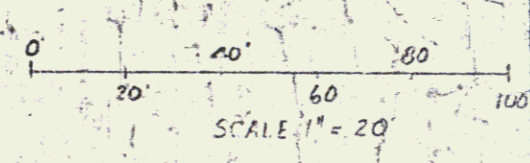
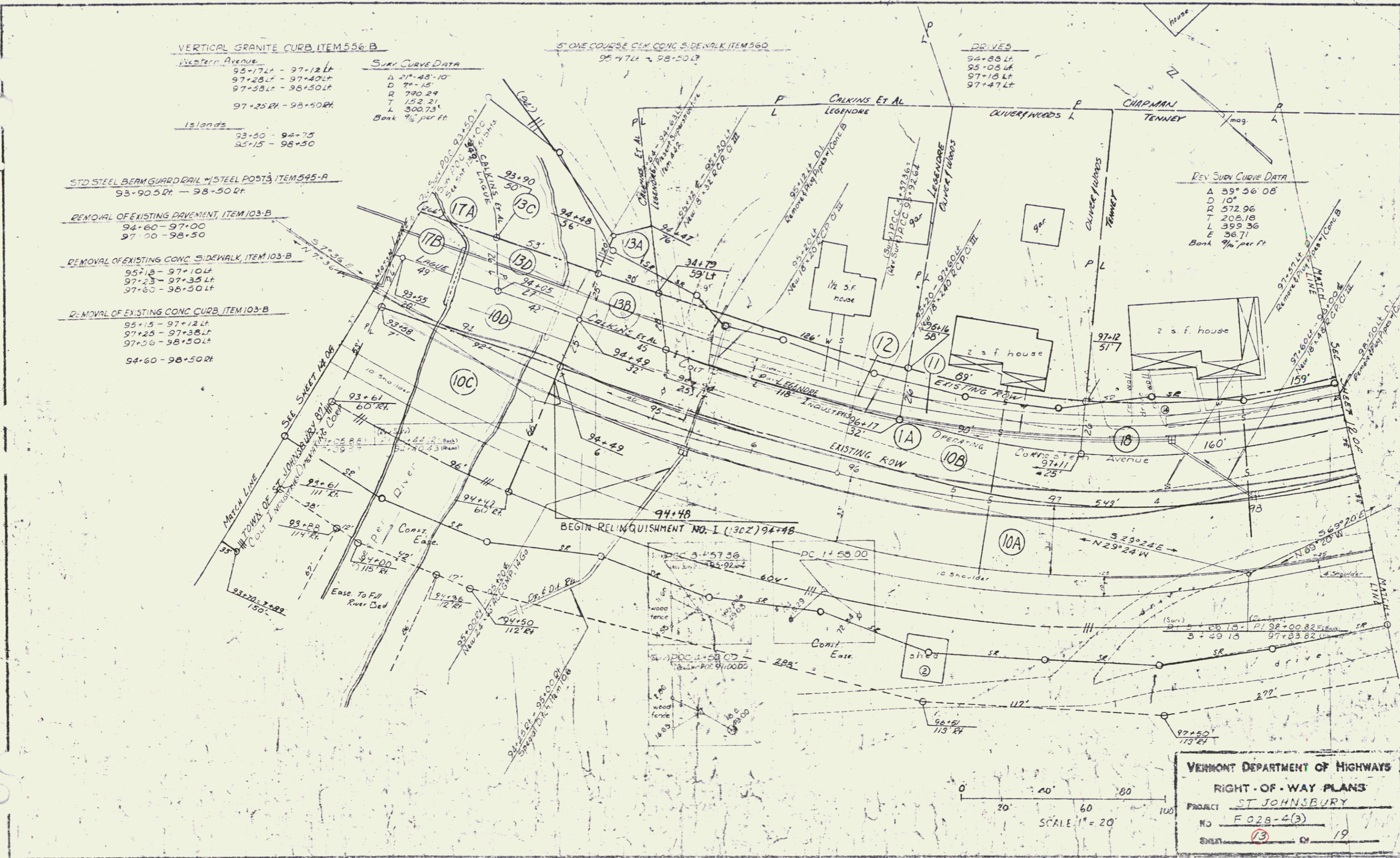

VERMONT DEPARTMENT OF HIGHWAYS
 RIGHT-OF-WAY PLANS
 PROJECT ST JOHNSBURY
 NO F 028-4(3)
 SHEET 13 OF 19

POOR ORIGINAL COPY