

WOOD GUARD RAIL REQUIRED		
CULVERT STATION	LEFT	RIGHT
34+62	24'	24'
39+80	24'	24'
43+56	24'	24'
46+41	24'	24'

WOOD GUIDE POSTS REQUIRED		
CULVERT STATION	LEFT	RIGHT
39+80	2	2

CABLE GUARD RAIL REQUIRED				
STATIONS	L-R	LEN	CONSTANT	PIV LENGTH
42+00-44+83	PT	283'	40'	400'
42+98-46+42	344	40'		388'

CULVERT REPAIRS REQUIRED			
STATION	NATURE OF REPAIRS	CONC. A	STEEL COMP. LENGTH
39+80	EXTENSION	4.25'	16" x 6"
43+54	Rein. Extend 7L+7R	300#	311"
46+41	EXTENSION	2.75'	18" x 10"

6" UNDERDRAIN WITH 6" PERC. C.G.M.P.		
STATIONS	LENGTH	CONC. UNDERDRAIN
46+70-48+00	130'	12"
46+44-46+78	34'	12"

CD ROAD STATE 112 RD 112 RD GREEN TOWN
 DIST. N. 112 RD 112 RD 112 RD 112 RD
 9 112 RD 112 RD 112 RD 112 RD

BITUMINOUS MACADAM GUTTER REQUIRED			
STATIONS	L-R	LENGTH	SURFACE STONE
43+14-43+08	L	24'	1CY

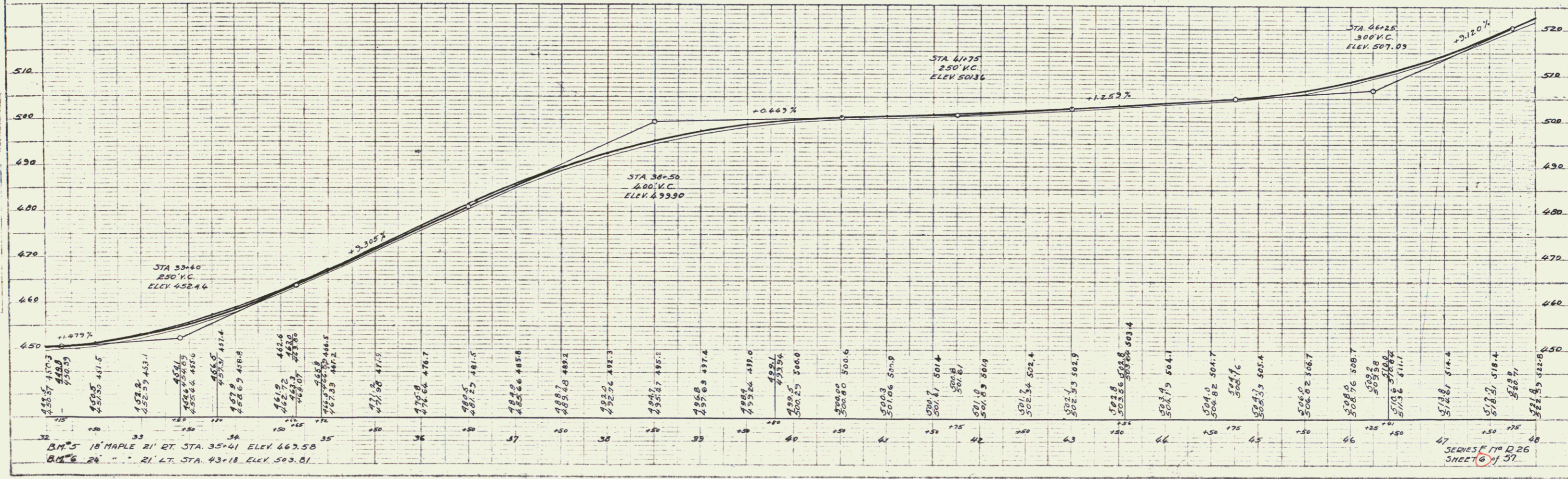
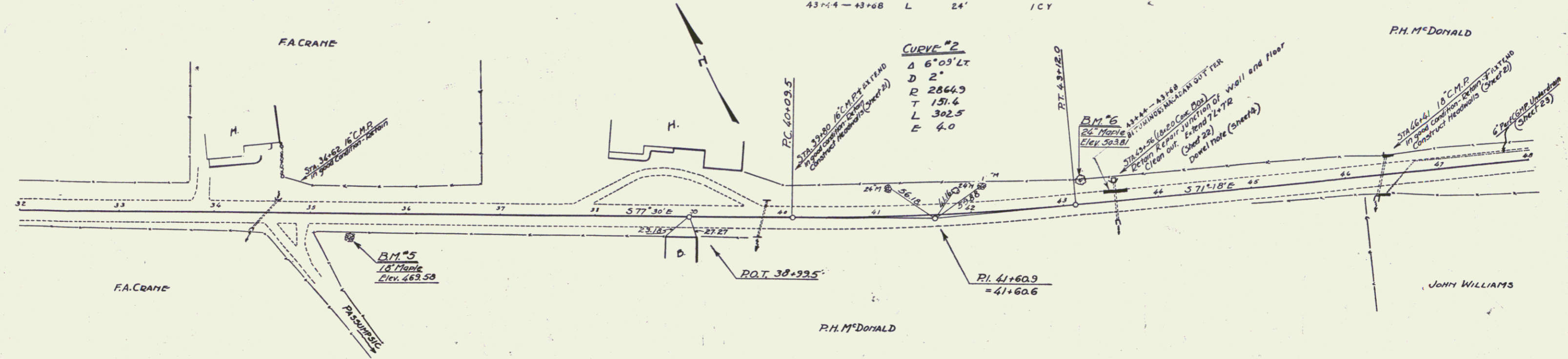

PLAN
 112 RD 112 RD 112 RD 112 RD

PROFILE
 112 RD 112 RD 112 RD 112 RD