

INDEX OF SHEETS	
SHEET NO.	1 TITLE SHEET
	2 TYPICAL SECTIONS OF IMPROVEMENT BITUMINOUS CONCRETE PAVEMENT ITEM 301-3, MOD.
	3 QUANTITY SHEET (ITEMS)
	4 ITEM DETAIL & DRAINAGE SHEET
5-6	EARTHWORKS
7-11	PLAN & PROFILE SHEETS
12	CULVERT DETAILS AT STA. 115+79
13	A-61 DRILLING & BLASTING
14	B-1 BANKING TABLES
15	B-5 TYPICAL SLOPE GRADING
16	B-6 MUCK EXCAVATION
17	B-10 EMBANKMENT
18	B-11 SLOPE STABILIZATION
19	B-12 SIDE ROAD INTERSECTION
20	B-13 DRIVE INTERSECTION
21	D-2 CEMENT RUBBLE MASONRY
22	D-3 GUTTERS
23	D-4 A.C.C.G. METAL PLATE PIPE
24	D-8 DROP INLETS
24-A	D-11 CAST IRON GRATES
24-B	E-1 BARRICADES, SIGNS, & LIGHTS
24-C	G-3 THREE CABLE GUARD RAIL WITH STEEL POSTS
24-D	G-4 STEEL MARKER POSTS
24-E	J-1 ERECTION OF PROJECT MARKERS
25-74	CROSS SECTIONS
74-B	PLAN & PROFILE - R.R. WARNING SIGN
74-C	WIRING DIAGRAM FOR FLASHING DEVICES
74-D	FLASHING LIGHT ASSEMBLY
74-E	RAILROAD CROSS SECTION

STATE OF VERMONT  
DEPARTMENT OF HIGHWAYS  
**PROPOSED IMPROVEMENT**  
FEDERAL AID PROJECT  
**TOWN OF DANVILLE**  
COUNTY OF CALEDONIA  
**U.S. ROUTE 2** Pin # 99R132

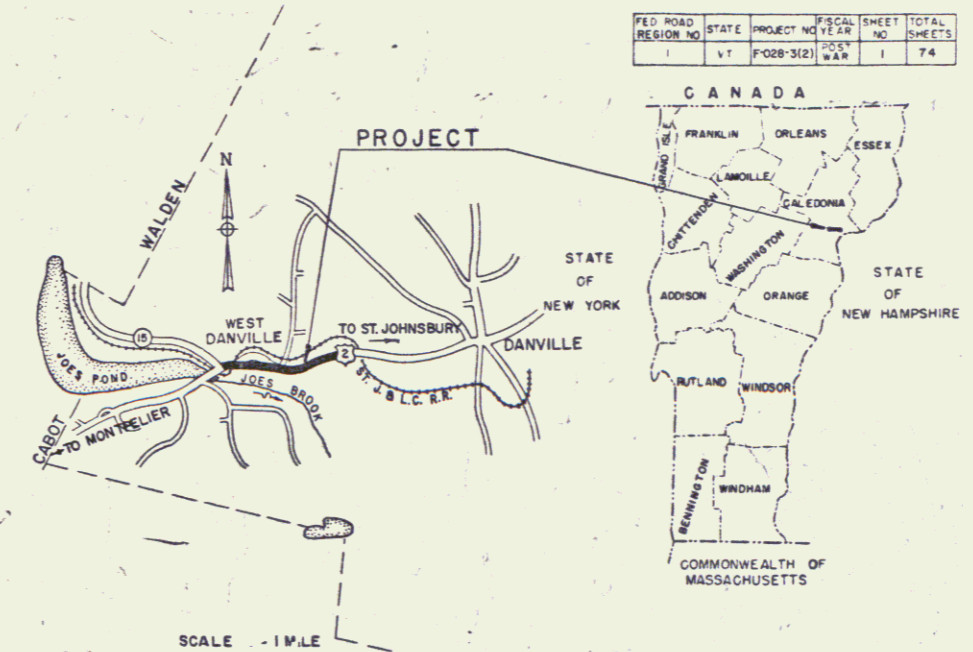

BEGINNING 440 FEET EASTERLY OF THE HIGHWAY BRIDGE OVER JOES BROOK ON U.S. ROUTE 2 IN THE VILLAGE OF WEST DANVILLE AND EXTENDING 6,750 FEET EASTERLY ALONG U.S. ROUTE 2, INCLUDING RAILROAD CROSSING  
LENGTH OF PROJECT 6,724 FEET = 1.273 MILES, EXCLUDING R.R. CROSSING

DESIGN DESIGNATION	
ADT (1955)	880-1910
ADT (1975)	1385-3400
DHV (1975)	208-460
D	60%
T	7-6%
V	50 MPH

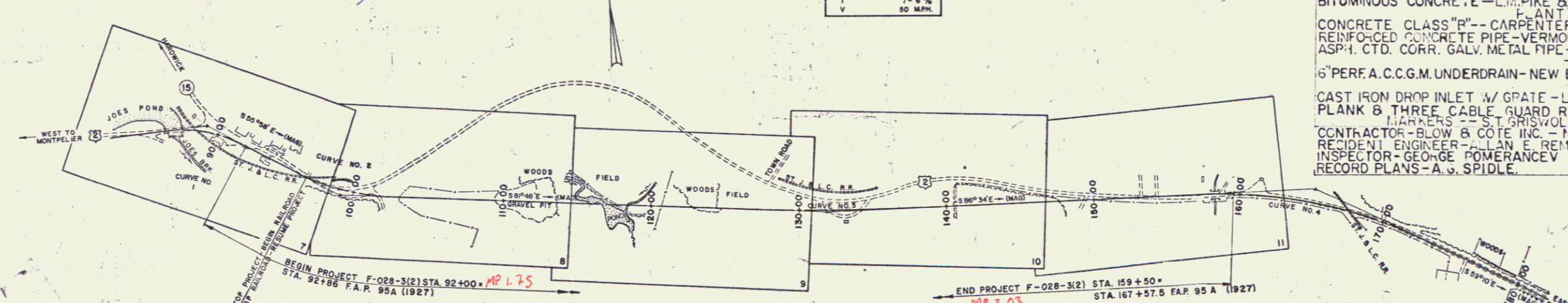

PROJECT NAME & NUMBER TYPE PAVEMENT AREA	
DANVILLE	F 028-3(2) BIT. CONC. PAVT 21,056 s.y.
RECORD PLANS	
MATERIALS	
SUBBASE OF GRAVEL - GRVEL SHOULDERS-LUSSIER PIT-HARDWICK, VERMONT.	
SUBBASE OF CRUSHED ROCK-DANVILLE QUARRY-WEST DANVILLE, VT.	
CALLEDONIA SAND & GRAVEL CO.-WATERFORD, VERMONT.	
REFINED TAR - MOBIL OIL CO.-EAST PROVIDENCE, RHODE ISLAND.	
BITUMINOUS CONCRETE - L.M. PIKE & SON (LISBON, N.H. & PLAINFIEL, VT.)	
CONCRETE CLASS "B" - CARPENTER READY MIX - ST. JOHNSBURY, VERMONT.	
REINFORCED CONCRETE PIPE - VERMONT CONCRETE PIPE CO.-WINDSOR, VERMONT.	
ASPH. CTD. CORR. GALV. METAL PIPE - NORTH STAR CULVERT CO.	
6" PER F.A.C.C.G.M. UNDERDRAIN - NEW ENGLAND METAL CULVERT CO.	
WHITE RIVER JUNCTION, VERMONT.	
CAST IRON DROP INLET W/ GRATE - LANE MFG. CO. - MONTPELIER, VERMONT.	
PLANK & THREE CABLE GUARD RAIL MARKER POSTS & BOUNDARY MARKERS - S.T. GRISWOLD CO. INC. - ESSEX JUNCTION, VERMONT.	
CONTRACTOR - BLOW & COTE INC. - MORRISVILLE, VERMONT.	
RESIDENT ENGINEER - COLMAN E. REMICK	
INSPECTOR - GEORGE COLMAN E. REMICK	
RECORD PLANS - A. V. SPIDLE	
CONTRACT DATED - MAY 20, 1959	
CONTRACT STARTED - JUNE 17, 1959	
CONTRACT COMPLETED - OCT. 3, 1960	
CONTRACT ACCEPTED - OCT. 3, 1960	

PROJECT DANVILLE  
HIGHWAY F 028-3(2)  
TYPE BITUMINOUS CONCRETE PAVEMENT  
CONTRACTOR BLOW & COTE, INC.  
MORRISVILLE, VERMONT.  
TAB 855-60  
LOCATION Beginning 440 feet easterly of the highway bridge over Joes Brook on U.S. Route 2 in the village of West Danville and extending 6,750 feet easterly along U.S. Route 2 including railroad crossing.

DANVILLE F 028-3(2)  
CONTRACTOR - BLOW & COTE, INC. - MORRISVILLE, VT.  
RECORD PLANS - ALEXANDER G. SPIDLE  
CONTRACT COMPLETED - OCTOBER 3, 1960.

CURVE DATA	
DEFLECTION OF ANGLE	Δ
DEGREE OF CURVE	D
RADIUS OF CURVE	R
TANGENT DISTANCE	T
LENGTH OF CURVE	L
EXTERNAL DISTANCE	E
POINT OF INTERSECTION	P.I.
POINT OF CURVE	P.C.
POINT OF TANGENT	P.T.
POINT ON TANGENT	P.O.T.
POINT ON SUB-TANGENT	P.O.S.T.

SCALES	
TITLE	1" = 400'
TYPICAL	1" = 80'
PLAN	1" = 80'
PROFILE HORIZONTAL	1" = 10'
PROFILE VERTICAL	1" = 10'
CROSS-SECTIONS	1" = 5' & 10'

APPROVED SECONDARY ENGINEER	APPROVED CONSTRUCTION SUPERVISOR	APPROVED ENGINEER	APPROVED DISTRICT ENGINEER	APPROVED HIGHWAY ENGINEER	APPROVED CHIEF ENGINEER
DATE	DATE 19 Feb. 1959	DATE 19 Feb. 1959	DATE 12 JANUARY 1959	DATE 19 Feb. 1959	DATE 20 FEB. 1959

RIGHT-OF-WAY DIVISION  
TOWN FILE  
PERPETUAL  
Town of US  
(To Be Returned To R.O.W. Division)

NOTE: ANY FURTHER INFORMATION CONCERNING FINAL QUANTITIES SHOULD BE OBTAINED RELATIVE TO THIS PROJECT AND BE BASED ON EITHER THE FIELD BOOKS OR THE ESTIMATE FILE.

THESE PLANS ARE SUBJECT TO SUCH REVISIONS AS MAY BE REQUIRED BY THE BUREAU OF PUBLIC ROADS OR THE COMMISSIONER OF HIGHWAYS.  
CONSTRUCTION IS TO BE CARRIED ON IN ACCORDANCE WITH THE PLANS AND THE STANDARD SPECIFICATIONS FOR HIGHWAY AND BRIDGE CONSTRUCTION OF JANUARY 1956 SUBMITTED TO THE BUREAU OF PUBLIC ROADS AS APPROVED JULY 5, 1956, INCLUDING ALL SUBSEQUENT APPROVED REVISIONS AND SUCH REVISED SPECIFICATIONS AND SPECIAL PROVISIONS AS ARE SUBMITTED WITH THE PLANS.

DEPARTMENT OF COMMERCE BUREAU OF PUBLIC ROADS	
APPROVED	DATE
DIVISION ENGINEER	DATE
PROJECT F NO. 028-3(2)	
SHEET 1 OF 74 SHEETS	