

WOOD GUARD RAIL REQUIRED
 (LEFT)
 STA. 222+92 TO 223+16 LENGTH 24 FT.
 (RIGHT)
 STA. 222+04 TO 223+08 LENGTH 24 FT.
 TOTAL FOR SHEET - 48 FT.

CABLE GUARD RAIL REQUIRED
 (RIGHT)
 STA. 226+08 TO 231+28 LENGTH 200 FT.

NEW CULVERT REQUIRED
 STA. 223+00 - 15' REINFORCED CONCRETE OR CAST IRON PIPE CULVERT - LENGTH 33 FT.
 2.1 Cu Yds. 33 LBS.
 CONCRETE CLASS B (1-13-5)
 REINFORCING STEEL

NEW CULVERT REQUIRED FOR DRIVEWAY
 STA. 227+00 - 12' CORRUGATED IRON PIPE CULVERT - LENGTH 32 FT.
 (ON LEFT)

FED. ROAD DIST. NO.	STATE	FED. AID PROJ. NO.	FISCAL YEAR	SHEET NO.	TOTAL SHEETS
95A	1927	16	53		

PLAN	DATE	BY	CHECKED
FILE	NO.	NO.	NO.

PROFILE	DATE	BY	CHECKED
FILE	NO.	NO.	NO.

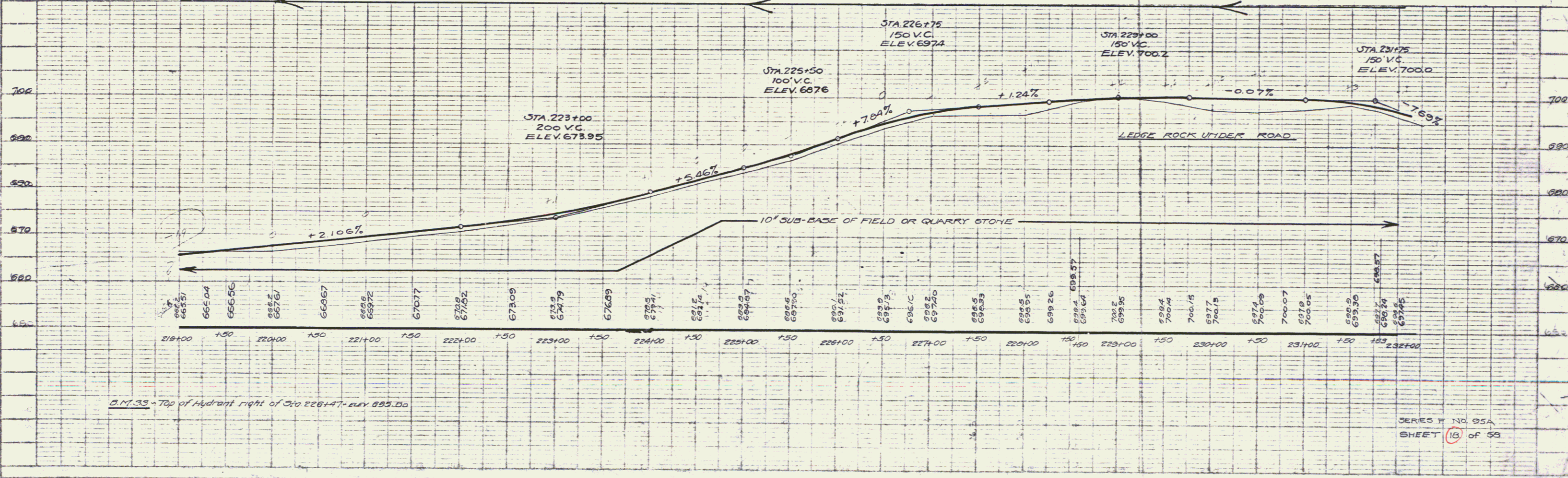
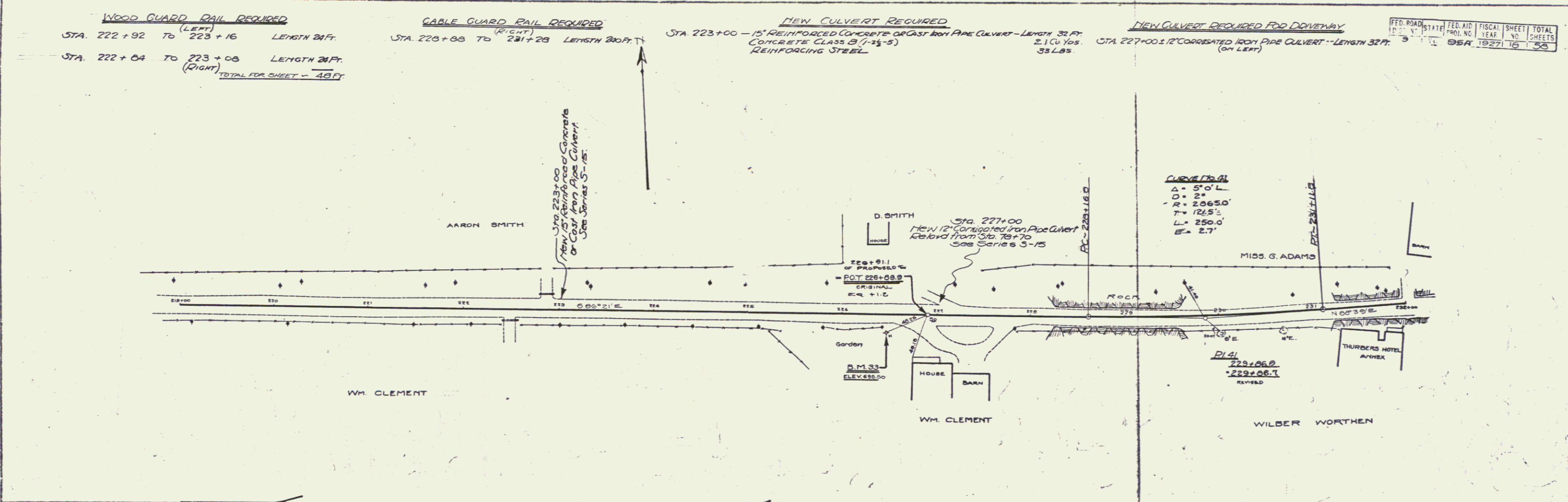

B.M. 33 - Top of Hydrant right of Sta. 226+47 - ELEV. 695.03

SHEET 18 OF 53