

WOOD GUARD RAIL REQUIRED

STA	TO	LENGTH
159+69	TO 159+93	24 FT.
162+47	TO 162+71	24 FT.
BRIDGE STA 166+36.5		48 FT.
STA 169+00	TO 170+12	24 FT.
(LEFT)		
120 FT.		
(RIGHT)		
STA 159+69	TO 159+93	LENGTH 24 FT.
STA 162+47	TO 162+71	24 FT.
BRIDGE STA 166+36.5		48 FT.
STA 169+00	TO 170+12	24 FT.
TOTAL FOR SHEET 240 FT.		

NEW CULVERTS REQUIRED

STA 159+01	- 3x2' REINFORCED CONCRETE BOX CONCRETE CLASS A (1-2-4) REINFORCING STEEL	12.50 YDS. 019 LBS.
STA 162+59	- 18" REINFORCED CONCRETE OR CAST-IRON PIPE CULVERT - LENGTH 28 FT. CONCRETE CLASS B (1-2-4-5) REINFORCING STEEL	27 CU YDS. 33 LBS.
STA 170+00	- 18" REINFORCED CONCRETE OR CAST-IRON PIPE CULVERT - LENGTH 28 FT. CONCRETE CLASS B (1-2-4-5) REINFORCING STEEL	27 CU YDS. 33 LBS.

NEW CULVERTS REQUIRED FOR DOWNGRADES
STA 167+75 12' CORRUGATED IRON PIPE CULVERT - LENGTH 16 FT. (ON LEFT)

FED. ROAD DIST. NO.	STATE	FED. AID PROJ. NO.	FISCAL YEAR	SHEET NO.	TOTAL SHEETS
1	VI.	25A	1922	12	53

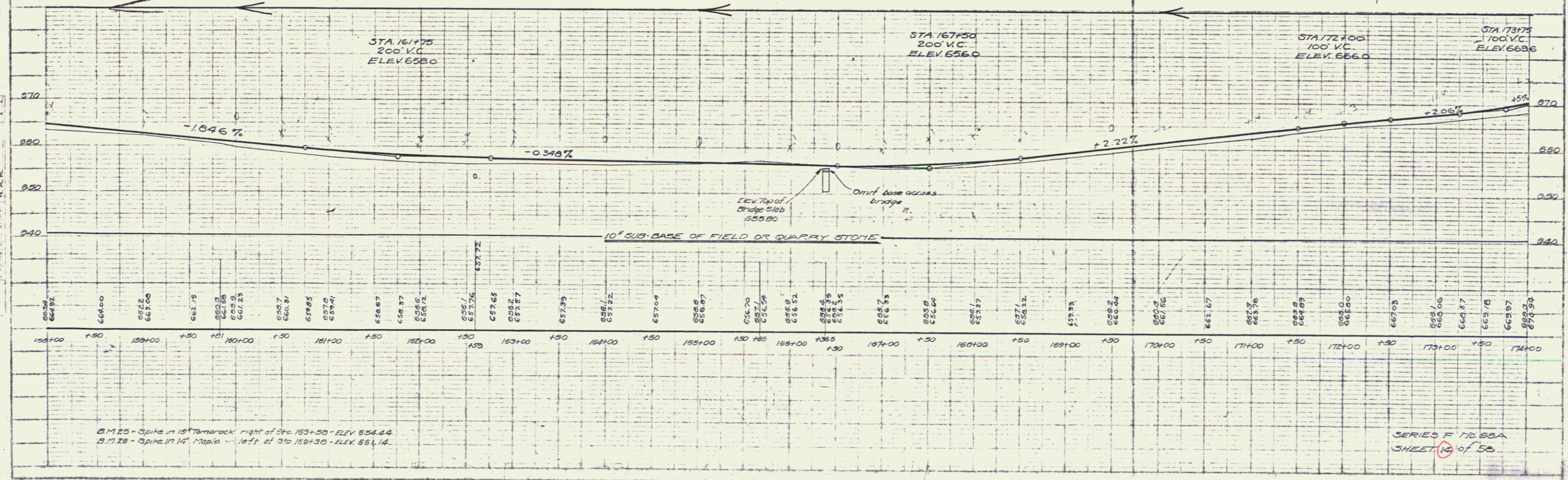
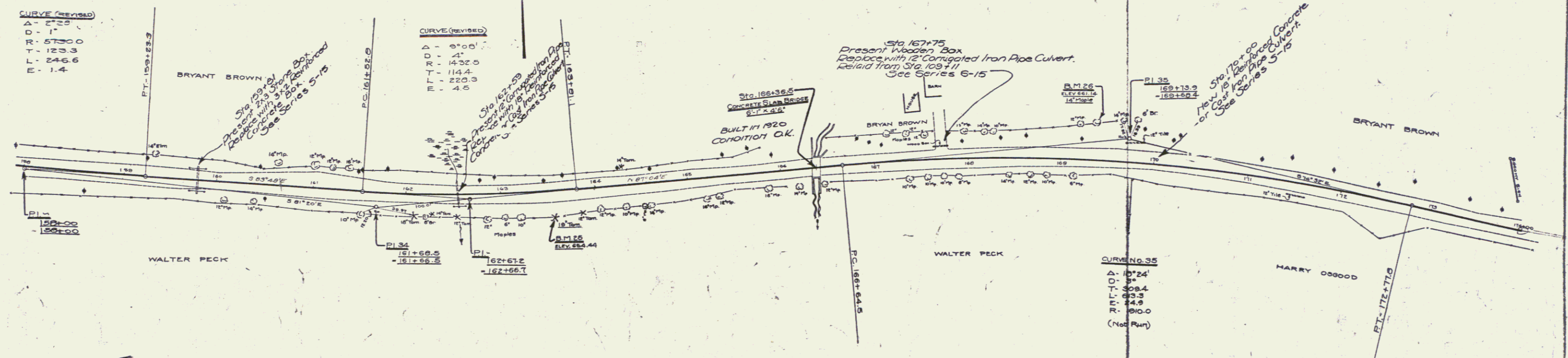

B.M. 25 - Spike in 19' Tamarack right of Sta. 163+50 - ELEV 654.44
B.M. 26 - Spike in 14' Maple - left of Sta. 161+30 - ELEV 664.14

SERIES F 10.55A
SHEET 14 of 53

13