

WOOD GUARD RAIL REQUIRED
 STA. 149+35 TO 149+62 LENGTH 24 FT.
 STA. 152+00 TO 153+12 LENGTH 24 FT. 40 FT.
 (LEFT)
 STA. 149+30 TO 149+62 LENGTH 24 FT.
 STA. 152+00 TO 153+12 LENGTH 40 FT.
 (RIGHT)
 TOTAL WOOD GUARD RAIL 96 FT.

NEW CULVERTS REQUIRED
 STA. 149+50 - 15' REINFORCED CONCRETE OR CAST IRON PIPE CULVERT - LENGTH 32 FT.
 CONCRETE CLASS B (1-2 1/2-5) 2.1 Cu. Yds.
 REINFORCING STEEL 33 LBS.
 STA. 153+00 - 15' REINFORCED CONCRETE OR CAST IRON PIPE CULVERT - LENGTH 40 FT.
 CONCRETE CLASS B (1-2 1/2-5) 2.1 Cu. Yds.
 REINFORCING STEEL 33 LBS.

NEW CULVERTS REQUIRED FOR DOWNSLAWS
 STA. 157+75 ± 12" CORRUGATED IRON PIPE - LENGTH 20 FT.
 (on Right)

NO.	DATE	BY	REVISION
1	VI. 1927		

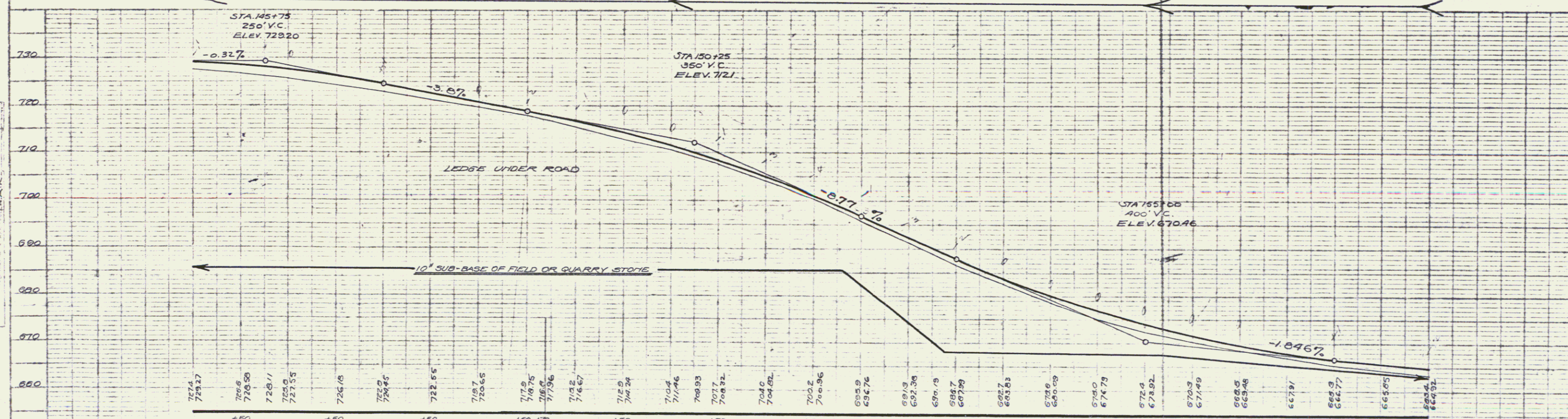
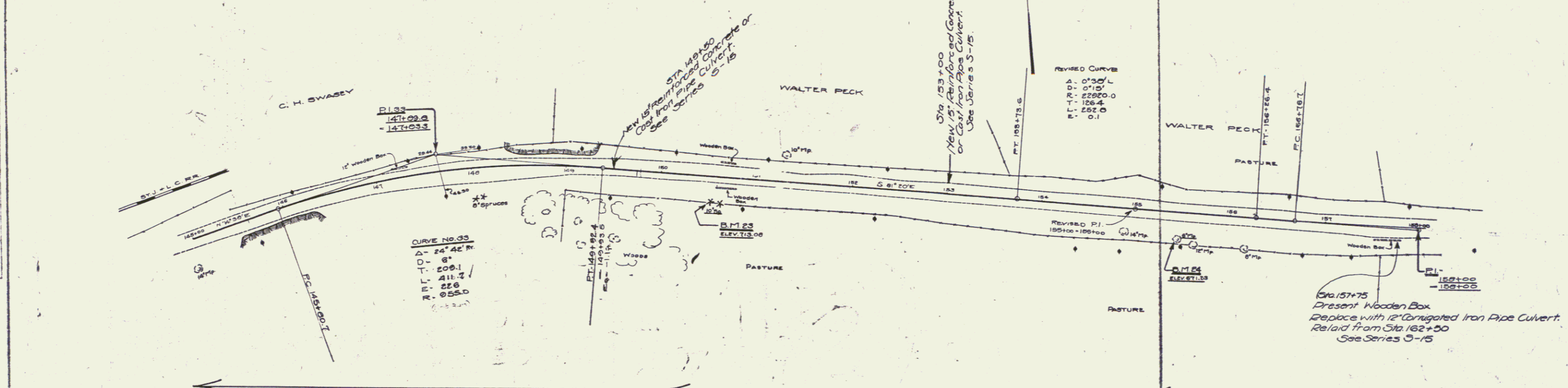

B.M. 22 - Spike in 10' spruce right of Sta. 150+33 - elev. 713.00
 B.M. 24 - Spike in 8" maple right of Sta. 151+43 - elev. 671.23

SERIES F-110 25A
 SHEET 13 OF 50