

WOOD GUARD RAIL REQUIRED
 STA. 135+38 TO 135+62 (LEFT) LENGTH 24 FT.
 STA. 134+66 TO 135+62 (RIGHT) LENGTH 96 FT.
 TOTAL FOR SHEET 120 FT.

NEW CULVERT REQUIRED
 STA. 135+50 - 18" REINFORCED CONCRETE & CAST IRON PIPE CULVERT - LENGTH 32 FT.
 CONCRETE CLASS B (1-2 1/2") 2.7 CU. Yds.
 REINFORCING STEEL 53 Lbs.

FED. ROAD DIST. NO.	STATE	FED. PROJ. NO.	FISC. YEAR	SHEET NO.	TOTAL SHEETS
9	VI.	98A	1967	12	50

PLAN

DESIGNED BY	A. J. RICHMOND
CHECKED BY	A. J. RICHMOND
DATE	3/17/67
SCALE	AS SHOWN

PROFILE

DESIGNED BY	A. J. RICHMOND
CHECKED BY	A. J. RICHMOND
DATE	3/17/67
SCALE	AS SHOWN

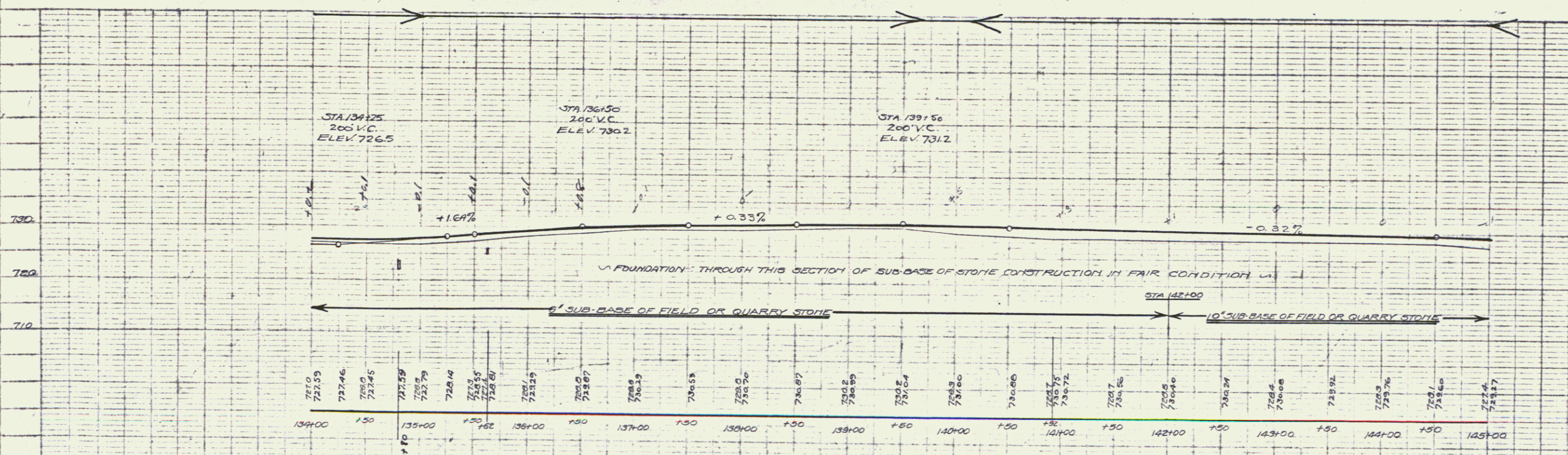
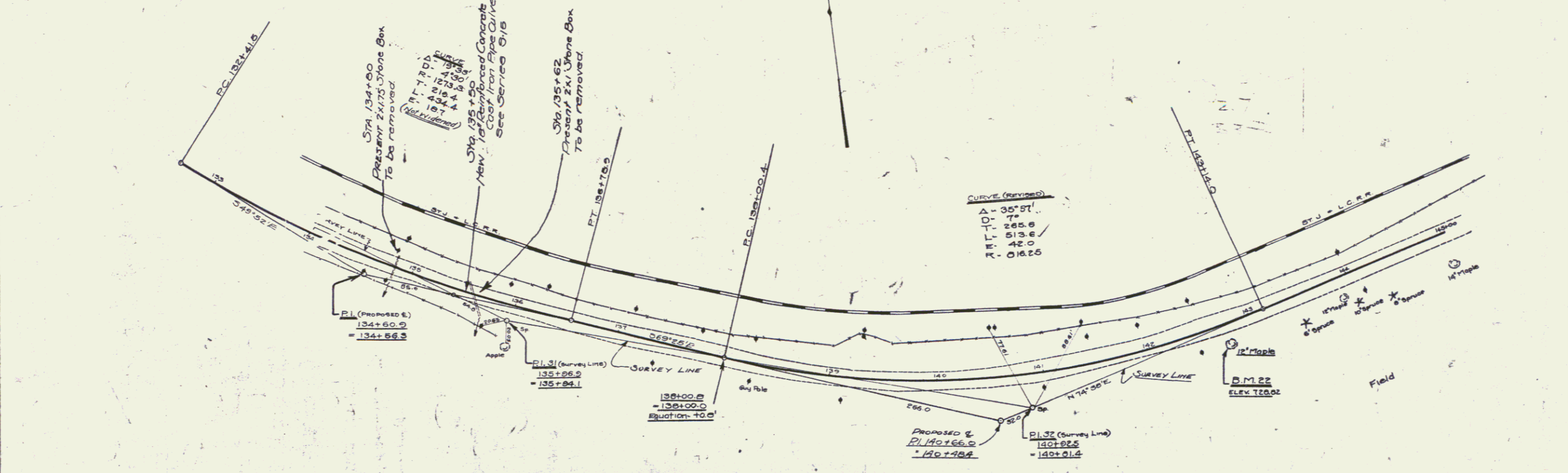

B.M. 222 stake in 12" Maple right of Sta 142+75 - ELEV 728.02

SERIES F 710 95A
 SHEET 12 OF 50 SHEETS