

NOTE:
Construct open ditch, L.T. of
2100 - 22100 in pasture
to carry water into culvert
at 20+85.

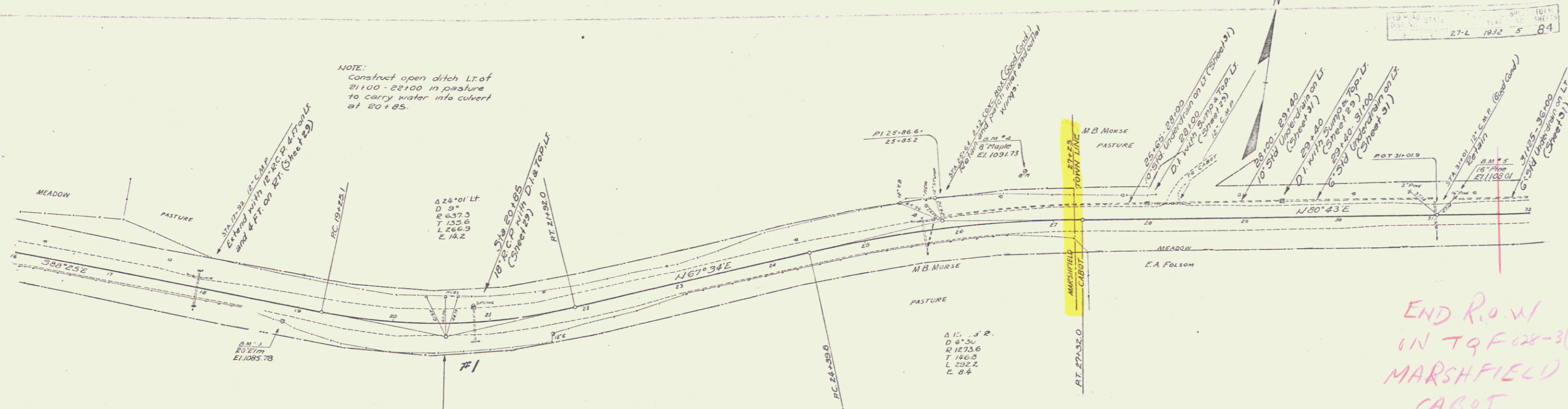

Parcel	Kind of Instrument	Date of Instrument	Grantor	Grantee	Recorded Map/Plan No.	Recorded Date	Remarks
Culvert #1	O.C.D.	11-24-31	M.B. & C.S. Morse	E.A. Folsom	Map 4-3731	Sta. 20+85	

END R.O.W.
IN TQ F 28-3(9)
MARSHFIELD
CULVERT

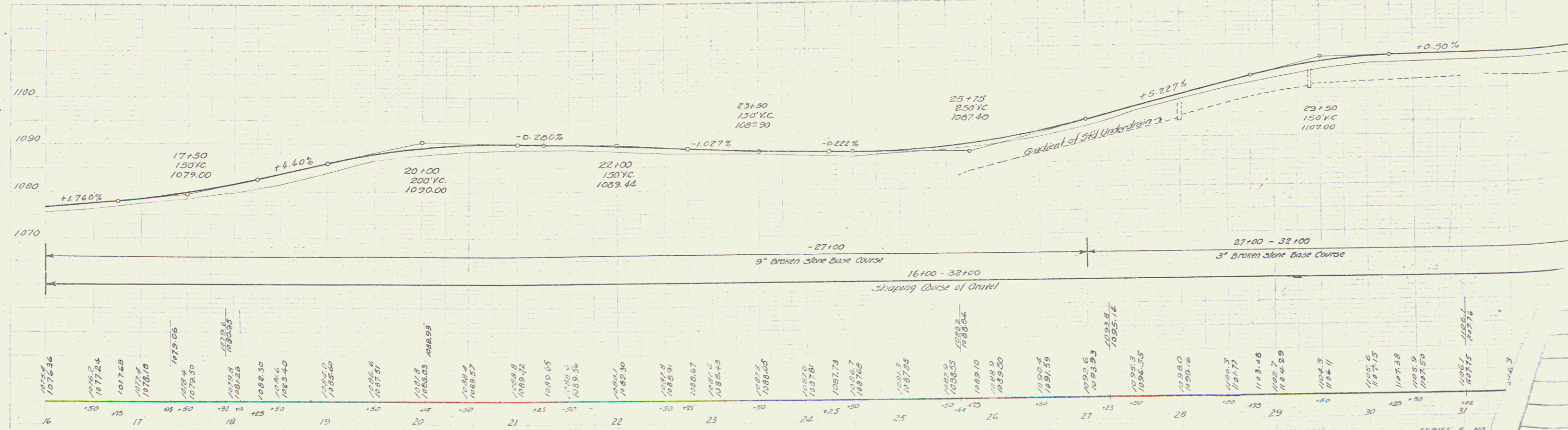

B.M. #3 Spike in Root 20' Elm 16' Rt. Sta. 18+85 El. 1085.78
B.M. #4 " " " 8' Maple 52' Lt. Sta. 26+75 El. 1091.73
B.M. #5 " " " 16' Pine 18' Lt. Sta. 31+22 El. 1108.01

SERIES P. NO.
SHEET 3 OF 8