

GUARD RAIL REQUIRED
 ON LEFT
 Sta 108+88 to Sta 109+12 Length 24 ft
 " 115+88 " " 116+12 " 24 "
 ON RIGHT
 Sta 105+24 to Sta 109+18 Length 392 ft
 " 115+88 " " 116+12 " 24 "
 Total this sheet 468 ft

NEW CULVERTS REQUIRED
 Sta 109+00 16" Corr Pipe 4 Rely
 28' from old road 13'
 1-2 1/2 - 5 Con 18 Cuyds Earth Excav. 1 C.I.
 Sta 116+00 16" Corr Pipe 30'
 1-2 1/2 - 5 Con 18 Cuyds Earth Excav. 7-5 C.I.
 Sta 118+37 12" Corr Pipe 30'
 1-2 1/2 - 5 Con 1 C.I.
 Earth Excav. 14 C.I.

SUB-BASE REQUIRED
 Sta 110+50 to Sta 110+50 Length 000 ft
 115+00 " 115+30 " 30'
 117+00 " 115+00 " 30'

FED ROAD DISTRICT	STAFFED AND FISCAL YEAR	SHEET NO.	TOTAL SHEETS
27B	1923	3	22

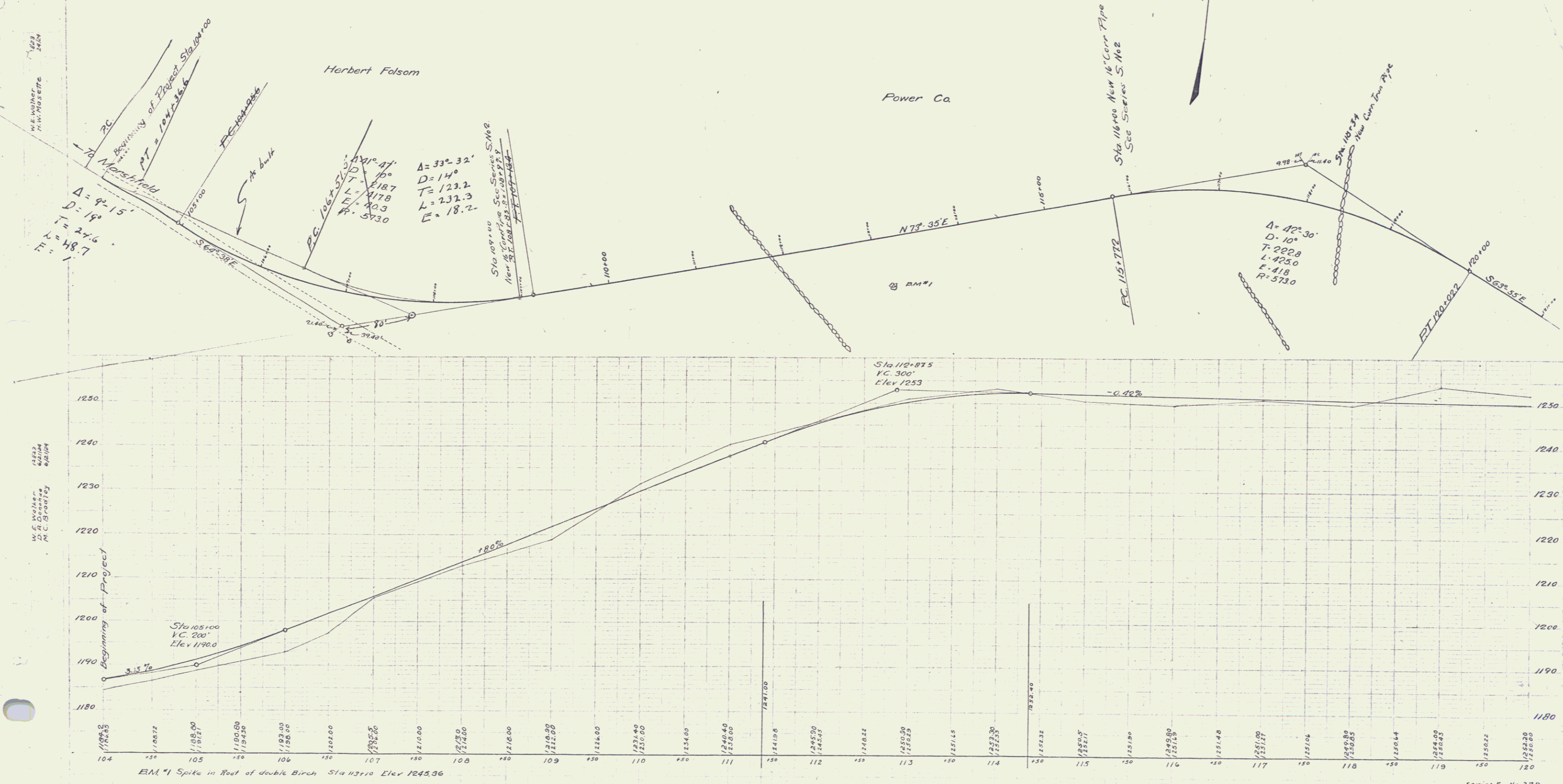

W.E. Walker
 H.W. Moser

W.E. Walker
 D.R. Gonsky
 P.C. Gonsky

BM #1 Spike in Root of double Birch Sta 113+10 Elev 1245.36

Series F No. 27B
 Filed
 Sheet 3 of 22