

PLAN
 DRAWN BY: [Signature]
 CHECKED BY: [Signature]
 DATE: 3/11/74

PROFILE
 DRAWN BY: [Signature]
 CHECKED BY: [Signature]
 DATE: 3/11/74

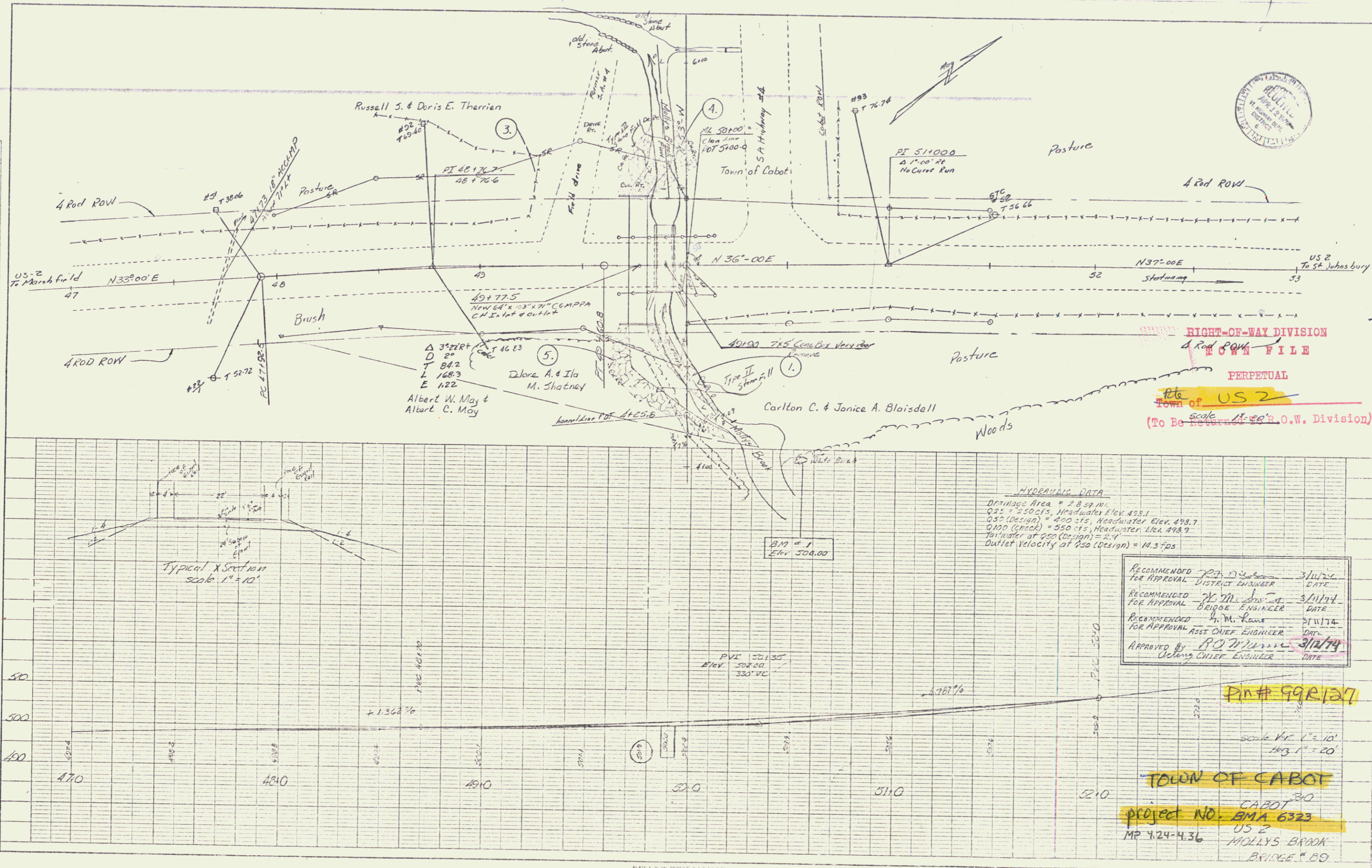

RIGHT-OF-WAY DIVISION
 TOWN FILE
 PERPETUAL
 Town of US 2
 (To Be Returned to R.O.W. Division)

RECOMMENDED FOR APPROVAL DISTRICT ENGINEER DATE 3/11/74
 RECOMMENDED FOR APPROVAL BRIDGE ENGINEER DATE 3/11/74
 RECOMMENDED FOR APPROVAL ASST. CHIEF ENGINEER DATE 3/11/74
 APPROVED BY [Signature] CHIEF ENGINEER DATE 3/11/74

PIN # 99R127

Scale: 1" = 10'
 1/4" = 20'

STATE OF VERMONT
DEPARTMENT OF HIGHWAYS
RIGHT-OF-WAY PLANS

TABLE OF PROJECT PROPERTY ACQUISITION

PARCEL NO.	GRANTOR	SHEET NO.	BEGINNING STATION	ENDING STATION	TAKING	REM.	RIGHTS	TITLE TAKEN	DATE	TOWN OR CITY RECORDED	BK.	PG.	REMARKS
1.	Blaisdell, Carlton C. & Janice A. (h&w)		49+88 Rt. U.S. 2 R. 49+93 Rt. U.S. 2 R.	50+00 Rt. U.S. 2 R. 50+11 Rt. U.S. 2 R.		N/A	Slope Ease. (P) (65 s.f.±) Channel Ease. (P) (185 s.f.±)						
2.	DELETED												Formerly May, Albert W. & May, Albert C.
3.	Therrien, Russell S. & Doris E. (h&w)		48+10 Lt. U.S. 2 R. 49+68 Lt. U.S. 2 R. 49+63 Lt. U.S. 2 R. 49+50 Lt. U.S. 2 R.	49+73 Lt. U.S. 2 R. 49+91 Lt. U.S. 2 R. 49+92 Lt. U.S. 2 R.		N/A	Slope Ease. (P) (3000 s.f.±) Channel Ease. (P) (340 s.f.±) Culvert & Drainage (P) Drive (T)						
4.	Cabot, Town of		49+92 Lt. U.S. 2 R. 49+89 Lt. U.S. 2 R. 49+21 Lt. U.S. 2 R.	50+00 Lt. U.S. 2 R. 50+06 Lt. U.S. 2 R. 49+92 Lt. U.S. 2 R.		N/A	Slope Ease. (P) (50 s.f.±) Channel Ease. (P) (260 s.f.±) All RT & I in & to Highway Ease.						Former S. A. # 4
5.	Shatney, Delore A. & Ila M. (h&w)		49+62 Rt. U.S. 2 R. 49+56 Rt. U.S. 2 R.	50+27 Rt. U.S. 2 R. 49+67 Rt. U.S. 2 R.		N/A	Channel Ease. (P) (1300 s.f.±) Slope Ease. (P) (25 s.f.±)						

TABLE OF REVISIONS

REVISION NO.	SHEET NO.	DESCRIPTION OF REVISION	DATE	MADE BY	APPROVED BY
1.		Parcel No. 2 - Deleted - Property line for Shatney established in different location resulting in no rts. required from May.	7-19-74	RMW	

LEGEND

MADE BY: RMW DATE: 6-24-74
CHECKED BY: _____ DATE: _____

---#---#---#--- TAKING WITHOUT ACCESS
---#---#---#--- TAKING WITHOUT ACCESS ALONG PROPERTY LINES
---#---#---#--- TAKING WITH ACCESS

---SR---SR--- SLOPE RIGHTS
---PROPERTY LINE
---Δ---Δ---Δ--- TOP OF CUT
---O---O---O--- TOE OF SLOPE

APPROVED _____ DATE _____
PROGRAM SUPERVISOR
APPROVED _____ DATE _____
HWY. ENGR.
APPROVED _____ DATE _____
R.O.W. DIRECTOR
CABOT BMA 6323
SHEET 2 OF 5 SHEETS