

PLAN  
 DATE: 12/15/73  
 DRAWN BY: J. J. GIBSON  
 CHECKED BY: J. J. GIBSON  
 NO. 1

PROFILE  
 DATE: 12/15/73  
 DRAWN BY: J. J. GIBSON  
 CHECKED BY: J. J. GIBSON  
 NO. 1

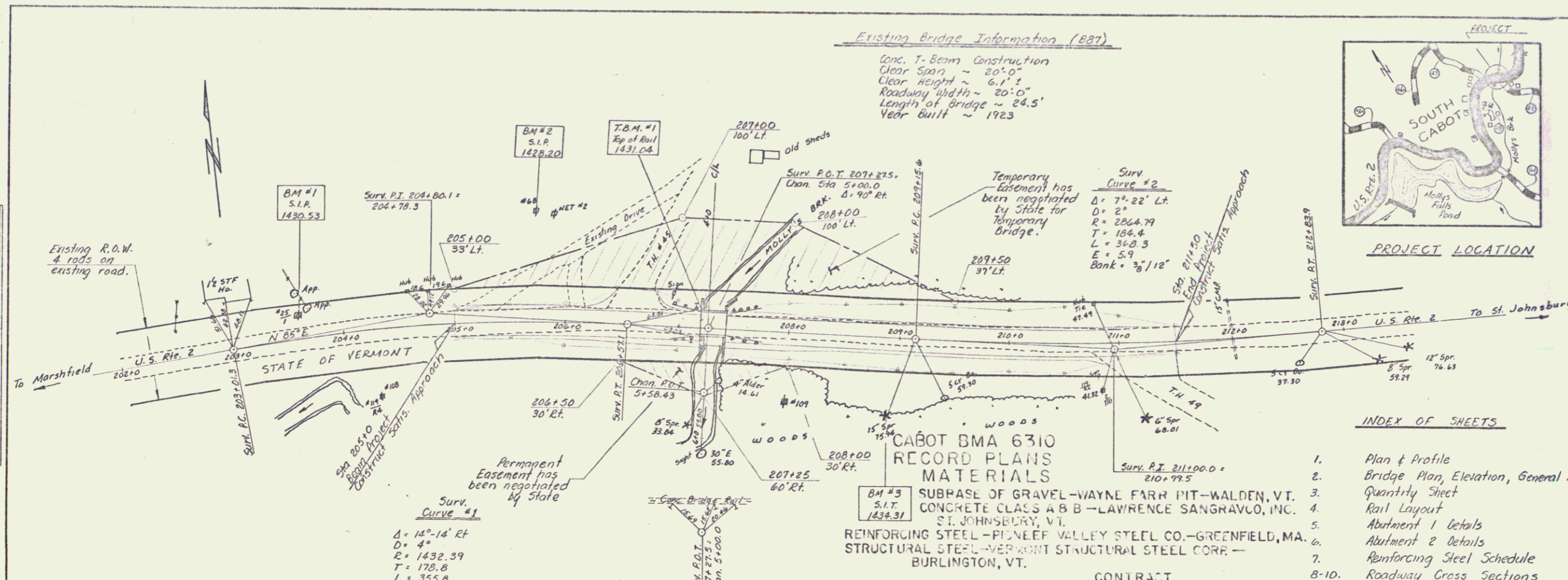

**TOWN OF CABOT**  
**COUNTY OF WASHINGTON**  
**U.S. ROUTE 2**

Beginning at a point 3.3858 miles  
 northerly of the Marshfield Coast  
 Town Line and continuing easterly  
 along U.S. Rte. 2 for 0.1231 miles.  
 Length of Project = 650 ft. = 0.1231 mi.  
 Length of Bridge = 24 ft. = 0.0046 mi.

**SCOPE OF PROJECT**  
 This Project shall consist of  
 constructing a new concrete slab bridge  
 on portions of the existing abutments  
 and on abutment extensions as detailed  
 in the Plans. Limited approach  
 construction as detailed is required.

**INDEX OF SHEETS**

1. Plan & Profile
2. Bridge Plan, Elevation, General Notes
3. Quantity Sheet
4. Rail Layout
5. Abutment 1 Details
6. Abutment 2 Details
7. Reinforcing Steel Schedule
- 8-10. Roadway Cross Sections
11. Channel Sections

**STANDARD SHEETS REQ'D.**

G-1	Apr. 10, 1972
SCB-DI-71	Jun. 22, 1973R
E-2	Dec. 14, 1971
E-3	Dec. 14, 1971
RIGHT-OF-WAY DIVISION	Mar. 12, 1973R

**CABOT BMA 6310**  
**RECORD PLANS**  
**MATERIALS**  
 SUBBASE OF GRAVEL-WAYNE FARR PIT-WALDEN, VT.  
 CONCRETE CLASS A B B - LAWRENCE SANGRACCO, INC.  
 ST. JOHNSBURY, VT.  
 REINFORCING STEEL - PIONEER VALLEY STEEL CO. - GREENFIELD, MA.  
 STRUCTURAL STEEL - VERMONT STRUCTURAL STEEL CORP. -  
 BURLINGTON, VT.

CONTRACTOR: **1"=50' 0"**  
 ST. JOHNSBURY, VT.  
 RESIDENT ENGINEER - MARLAN G. LEWIS  
 RECORD PLANS - A. G. SPIELLE

CONTRACT DATED - JUNE 28, 1973.  
 STARTED - JULY 11, 1973  
 COMPLETED - OCTOBER 15, 1973  
 ACCEPTED - OCTOBER 15, 1973

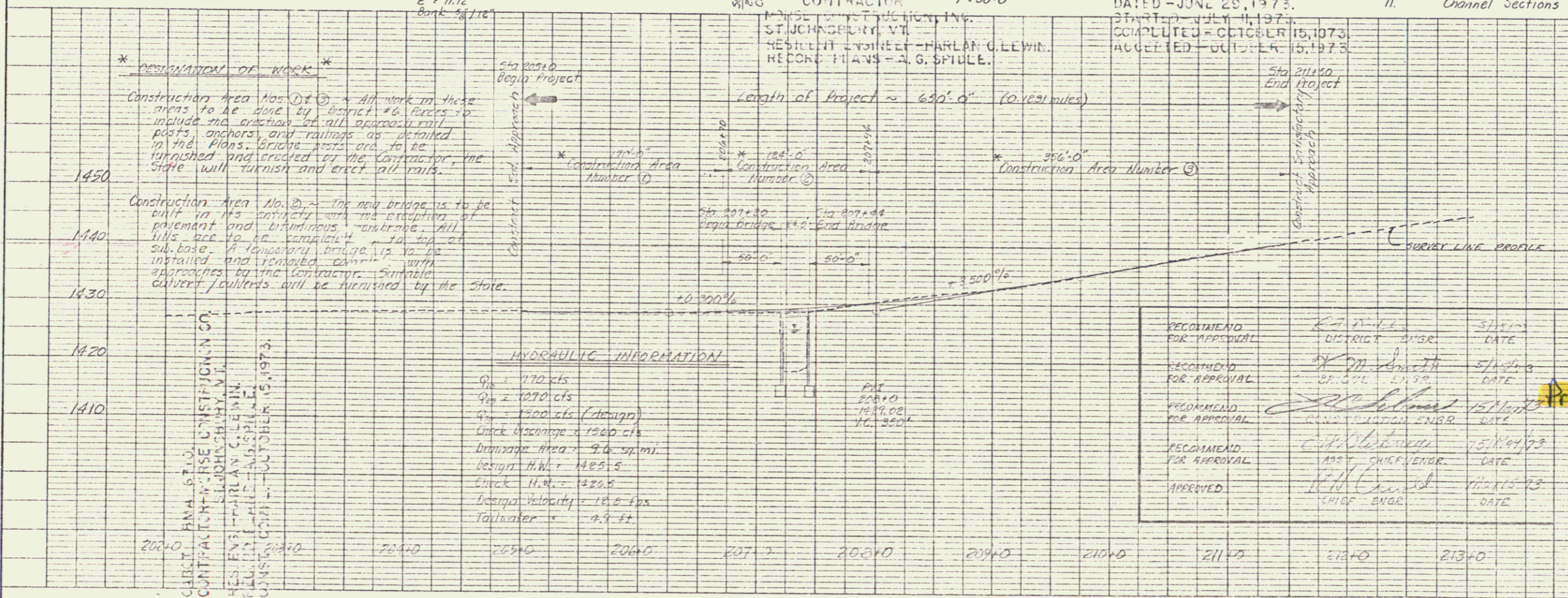

**\* DESIGNATION OF WORK \***  
 Construction Area No. (1) - All work in these areas to be done by District #6. Forces to include the erection of all approach rail posts, anchors, and railings as detailed in the Plans. Bridge posts are to be furnished and erected by the Contractor, the State will furnish and erect all rails.  
 Construction Area No. (2) - The new bridge is to be built in its entirety with the exception of pavement and sidewalks. All utility lines are to be relocated in the cut sub-base. A temporary bridge is to be installed and removed with appropriate approaches by the Contractor. Suitable culvert foundations will be furnished by the State.

**HYDRAULIC INFORMATION**

Q <sub>10</sub>	1170 cfs
Q <sub>5</sub>	1070 cfs
Q <sub>2</sub>	1000 cfs (Design)
Check discharge	1200 cfs
Design Area	9.6 sq. mi.
Design H.M.	188.5
Check H.M.	122.5
Design Velocity	1.8 ft/s
Turbulence	0.9 ft.

RECOMMEND FOR APPROVAL  
 DISTRICT ENGR. DATE  
 RECOMMEND FOR APPROVAL  
 DISTRICT ENGR. DATE  
 RECOMMEND FOR APPROVAL  
 DISTRICT ENGR. DATE  
 RECOMMEND FOR APPROVAL  
 DISTRICT ENGR. DATE  
 APPROVED  
 DISTRICT ENGR. DATE

Proj. No. 99R126

MP. 2.8 to 3.01

CABOT

Proj. No. BMA 6310

U.S. #2

MOLLY'S BROOK  
 B-87

01/01/73

Plotted by: H. J. GIBSON  
 Checked by: S. J. GIBSON  
 Sheet 1 of 11