

GUARD RAIL REQUIRED
ON LEFT
 Sta 368+38 to 368+62 Length 24 ft
 - 370+19 - 370+37 - 24'
 - 372+62 - 372+86 - 24'
 - 375+52 - 375+76 - 24'
 - 378+50 - 378+74 - 24'
 - 378+84 - 380+98 - 64'
ON RIGHT
 Sta 368+38 to 368+62 Length 24 ft
 - 370+19 - 370+37 - 24'
 - 371+66 - 375+66 - 400'
 - 378+54 - 378+78 - 24'
 - 379+36 - 380+52 - 56'
TOTAL THIS SHEET 628 ft

NEW CULVERTS REQUIRED
 Sta 368+50 12" Cur Iron Pipe 32 ft
 1-2-4 concrete 1.0 cu yds
 Sta 370+25 16" Cur I.P. with slope inlet 30 ft
 1-2-4 concrete 1.7 cu yds
 Sta 372+24 12" Cur Iron Pipe 32 ft
 1-2-4 concrete 1.0 cu yds
 Sta 375+64 12" Cur Iron Pipe 28 ft
 1-2-4 concrete 1.0 cu yds

STONE BASE REQUIRED
 Sta 369+00 to 379+70 1070 ft

| | | | |
|---------------------|-------|------|------------|
| FED. ROAD DIST. NO. | STAT. | YEAR | NO. SHEETS |
| 9 | VT | 27 | 1920-21 |
| | | 28 | 75 |

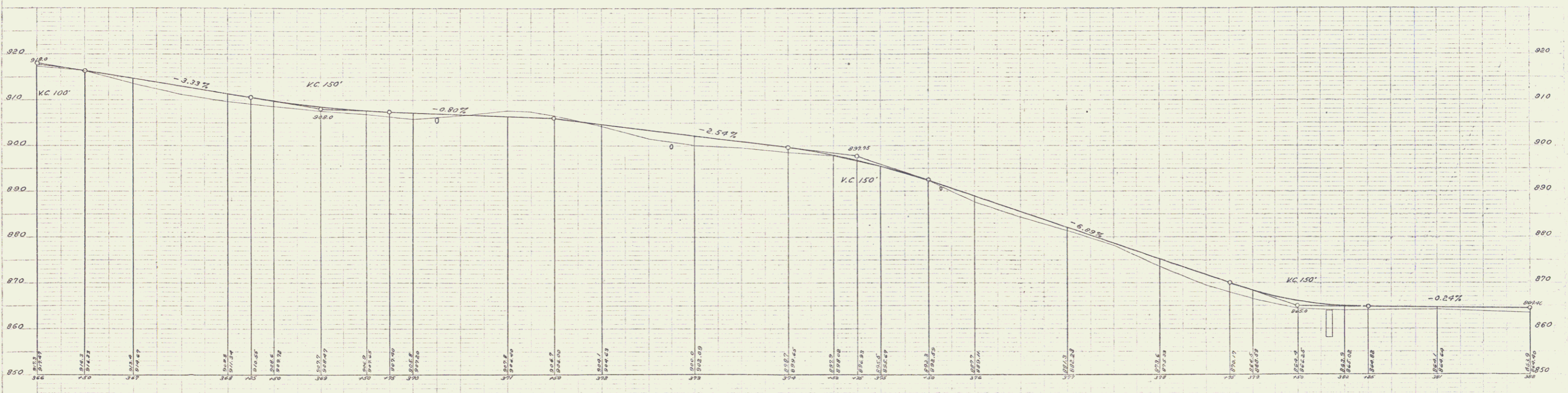
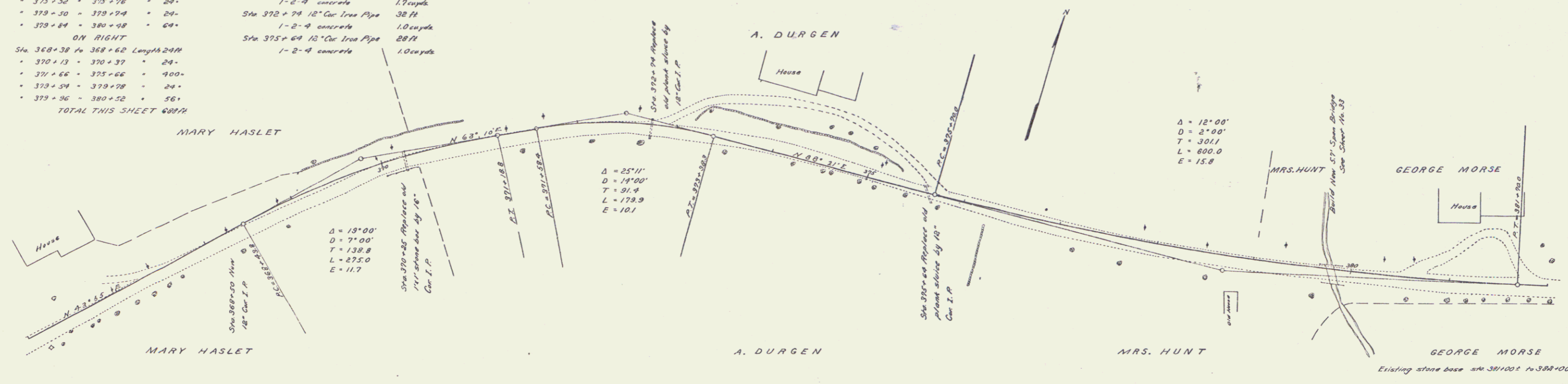

B.M. Top of stone in bank wall, left of 373+25 Elev. 901.21
 B.M. Spike in elm tree, right of 381+19 Elev. 865.19

Series P, No. 27 Filed
 Sheet 27 of 75